

# EXHIBIT A

That portion of the East half of Section 8, Township 13 South, Range 65 West of the 6th P.M., County of El Paso, State of Colorado, described as follows:

BASIS OF BEARINGS: Bearings are based upon the West line of the Southeast Quarter of Section 8, Township 13 South, Range 65 West of the 6th P.M., monumented at the North end with a #6 rebar & 3.25" aluminum cap stamped "PLS 38141" and monumented at the South end with a #6 rebar & 3.25" aluminum cap stamped "WATTS PLS 9853", and is assumed to bear S 00°06'23" W, a field measured distance of 1,329.76 feet.

BEGINNING at the Northwest corner of the Southeast Quarter of said Section 8; thence S 00°06'23" W along the West line of the Southeast Quarter of said Section 8, a distance of 1329.76 feet to the Southwest corner of the Northwest Quarter of the Southeast Quarter of said Section 8; thence N 89°06'33" E along the South line of the Northwest Quarter of the Southeast Quarter of said Section 8, a distance of 500.15 feet to intersect the Southerly extension of the West line of the Ruth K. Adams Tract as recorded under Book 2088 at Page 738 of the records of the El Paso County Clerk and Recorders Office; thence N 00°01'48" W along said Southerly extension of said West line, a distance of 897.10 feet to the Northwest corner of said Ruth K. Adams Tract, said corner also being the most Southerly corner of that parcel of land as described under the Quitclaim Deed as recorded under Reception No. 225004905; thence N 00°41'29" W along the West line of said parcel of land as described under the Quitclaim Deed as recorded under Reception No. 225004905, a distance of 470.17 feet; thence continuing N 00°41'29" W, a distance of 339.34 feet to a point on the South line of that parcel of land described under the Quitclaim Deed as recorded under Reception No. 225004903; thence S 89°49'06" W along said South line a distance of 486.78 feet to the Southwest corner of said parcel, said point also being a point on the West line of the Northeast Quarter of said Section 8; thence S 00°05'23" W along said West line of the Northeast Quarter of Section 8, a distance of 383.02 feet to the POINT OF BEGINNING.

Containing a calculated area of 847,734 square feet (19.461 acres) of land, more or less.

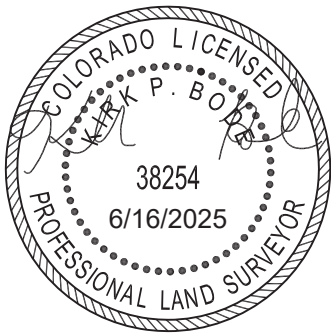

Kirk P. Bode  
Colorado Professional Land Surveyor No. 38254  
For and on behalf of Barron Land, LLC

BARRON

LAND

BOUNDARY   Δ   MAPPING   Δ   SURVEYING   Δ   CONSTRUCTION

2790 N. Academy Blvd. Suite 311

Colorado Springs, CO 80917

P: 719.360.6827

F: 719.466.6527

www.BARRONLAND.com