

PROJECT MANAGER

**bobbyhill**  
**DESIGNS**  
219 WEST COLORADO AVE.  
SUITE 308  
COLORADO SPRINGS, CO.  
719-634-3600 719-634-2239

# TRAINWRECK PATIO BAR ADDITION

## 812 S. SIERRA MADRE ST. COLORADO SPRINGS, CO 80903

### 2,304 SF

DRAWING INDEX:

SHEET NO.	SHEET NAME
A0.00	COVER PAGE
A1.00	CODES AND EGRESS PLAN
A1.01	SITE PLAN
A1.02	DEMOLITION PLAN
A1.03	CONSTRUCTION PLAN AND ROOF PLAN
A1.04	ELEVATIONS, SECTIONS AND DETAILS

64192-06-063

PROJECT:  
**TRAINWRECK PATIO BAR ADDITION**

812 SIERRA MADRE ST  
COLORADO SPRINGS, CO  
80903

2,304 SF

TAX ID# 6419200039

PROJECT MANAGEMENT

**bobbyhill**  
**DESIGNS**

219 WEST COLORADO AVE.  
SUITE 308  
COLORADO SPRINGS, CO.  
719-634-3600 719-634-2239

ARCHITECT

**S | G | Design**  
ARCHITECTS

3311 Elm Street, Suite 105  
Dallas, Texas 75226  
214-742-6044  
www.sgdesign.biz

© COPYRIGHT PROTECTED

ARCHITECT'S SEAL:

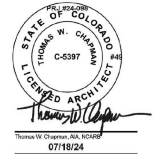

CONSULTANT'S SEAL:

FULL SET ISSUE HISTORY:

ISSUE FOR PERMIT	DATE
	07/18/2024

SHEET DELTA REVISION:

NO.	REVISION

DRAWING INFO:

DRAWN BY: GC

CHECKED BY: JS

SHEET NUMBER:

COVER SHEET

# A0.00

ARCHITECT

**S | G | Design**  
ARCHITECTS

3311 Elm Street  
Suite 105  
Dallas, Texas 75226  
214-742-6044  
www.sgdesign.biz

VICINITY MAP

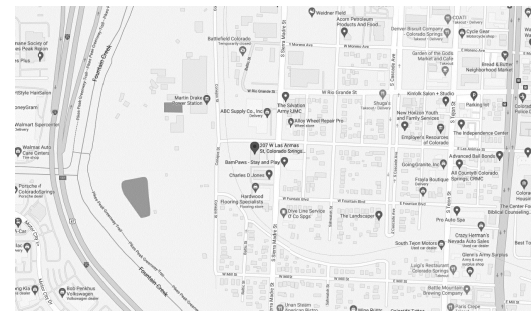

SITE MAP



NA  
08/15/2024 10:59:58 AM  
any  
ENUMERATION

KEY PLAN

AREA OF CONTRACT

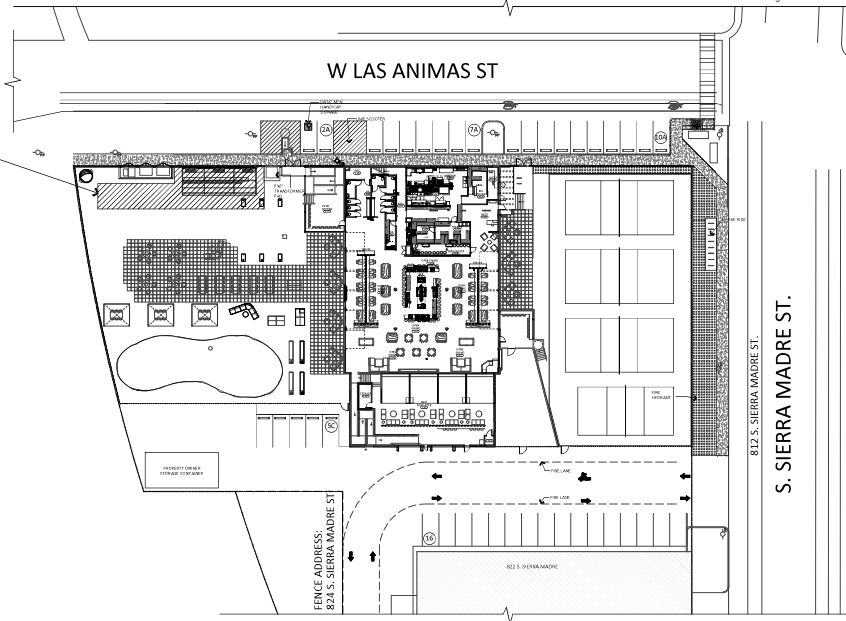

AREA OF CONTRACT  
HATCH AREA ONLY