



## OFFICE OF THE CITY CLERK

**LIQUOR LICENSE APPLICATION OR  
3.2% FERMENTED MALT BEVERAGE  
LICENSE APPLICATION (ALCOHOL BEVERAGE)**

Received:

CITY CLERK'S OFFICE

2019 AUG 26 P 12:53

It shall be unlawful for any person to knowingly make any false statement or omit any pertinent information on any application for a license. In the event any person knowingly makes any false statement or omits any pertinent information on any application, that act or omission shall, in addition to all other remedies, be grounds for denial of the license or for suspension or revocation of any license issued upon the basis of the false statement. City Code § 2.1.404.

THIS APPLICATION MUST BE FULLY COMPLETE, WITH APPLICABLE FEES AND ALL REQUIRED ATTACHMENTS.  
Return fully completed applications to the City Clerk's Office, 30 S. Nevada Avenue, Suite 101, 80903.



NEW LICENSE



TRANSFER OF OWNERSHIP

Type of License applying for (Check One)

- ☐ Hotel/Restaurant (or Resort)    ☐ Hotel/Restaurant w/Optional    ☐ Tavern    ☐ Brew Pub  
☐ Distillery Pub    ☐ Vintner's Restaurant Liquor    ☐ Beer and Wine    ☐ Optional Premises  
☐ Retail Liquor Store\*    ☐ Licensed Drugstore\*    ☐ Racetrack    ☐ Arts  
☒ Lodging & Entertainment    ☐ FMB (Beer) On Premises    ☐ FMB (Beer) Off Premises

\* New Retail Liquor Store (RLS) and Liquor Licensed Drugstore (LLD) applications may not be within 1500' of an existing RLS or LLD location.

**Section A: APPLICANT/LICENSEE INFORMATION**

1. Name of Applicant/Licensee (list Corporation/LLC/Partnership/Association/Sole Proprietor):

Hollywood Theaters, Inc.

2. Trade Name (DBA): Regal Cinemas Interquest 14 &amp; RPX

3. Premises Address:

City, State, Zip:

1120 Interquest Parkway CSC

Location

Phone: 844-462-7342

Property Tax Schedule No. : 6220201021

Zoning: PUD

4. Mailing Address:

City, State, Zip:

101 E. Blount Ave., Knoxville, TN 37920

Alt Phone:

Primary Contact

Name And Title:

Leonard Gomez, GM

Email: 1609@regalcinemas.com

**5. IF THIS IS A TRANSFER OF AN EXISTING LICENSE – THE FOLLOWING MUST BE ANSWERED:**

Present trade name of establishment (dba)	Present State License No.	Present Class of License	Present Expiration Date
N/A	N/A	N/A	

6. If the applicant is: a Corporation, Limited Liability Company, Partnership or Association, list all officers, directors, general partners and managing members, position held and percentage owned. Attach supplemental pages as needed. **\*\*NOTE: ATTACH ONE AFFIRMATION AND CONSENT (page 3), and ONE APPLICANT INTERVIEW (page 4), FOR EACH NAME LISTED.**

NAME	POSITION HELD	%OWNED
See Attached		

**Section B: FINANCIAL INFORMATION**

7. Source(s) of funds invested for total purchase, startup, and inventory costs (provide names, banks, and indicate checking, savings, loan, promissory note, gift or other). Attach supplemental pages as needed.

THE FOLLOWING INFORMATION MUST REFLECT THE ENTIRE SOURCE OF FUNDS INVESTED. NO OTHER PERSON OR PARTIES MAY HAVE A FINANCIAL INTEREST IN THE BUSINESS FOR WHICH THIS APPLICATION IS SUBMITTED.

NAME/ADDRESS OF FUNDING SOURCE (bank(s), individual(s), et al.)	FUNDING SOURCE (checking/savings/ loan/ note/ gift)	AMOUNT
Bank of America/Merrill Lynch	Business Checking	~\$8,500.00
TOTAL INVESTMENT IN BUSINESS:		\$ ~\$8,500.00

**Section C: PREMISES / LOCATION INFORMATION**

8. Registered Manager Name: John Curry

9. Terms of legal possession for which application is made: ☐ OWN ☒ LEASE ☐ OTHER

If leased, provide the terms: START DATE: 05/22/2007 END DATE: 05/31/2023

DIMENSIONS OF PREMISES: 167'8" x 344' TOTAL SQUARE FOOTAGE: 361,045 sf

Is there a patio area? ☐ Yes ☒ No — If yes, provide dimensions \_\_\_\_\_

Anticipated number of employees: ~50 Anticipated opening date: N/A

Will training be offered or required? ☒ Yes ☐ No — If yes, through what agency? In-house

**Section D: BACKGROUND INFORMATION**

10. Has the applicant/licensee, any partners, any officers, any stockholders or directors, or any manager of said applicant previously been issued an alcohol beverage license, or have a financial interest in any alcohol beverage license in Colorado?

☒ Yes ☐ No IF YES, ATTACH a statement or affidavit of explanation, to identify the business and any current or former financial interest in said business including any loans to or from another license or licensee.

11. Has the applicant/licensee, any partners, any officers, any stockholders or directors, or any manager of said applicant ever received a violation notice, suspension, or revocation for any alcohol beverage license law violation, have charges pending, or been denied any alcohol beverage license anywhere in the United States?

☐ Yes ☒ No IF YES, ATTACH a statement or affidavit of explanation, including date(s) and location(s).

12. Has the applicant/licensee, any partners, any officers, any stockholders or directors, or any manager of said applicant ever been convicted of any crime, received a suspended sentence, a deferred sentence, or have charges pending?

☐ Yes ☐ No IF YES, ATTACH statement or affidavit of explanation, including date(s) and location(s).

13. List every individual applicant's prior experience in the sale of alcoholic beverages. Attach supplement as needed.

Business Name & Address	Applicant's Name	Experience/Position	Dates
See Attached			

# Supplemental Response to Questions #10 & #13:

Unit #	Location	City, State	ST	Zip Code
103	DOWNTOWN WEST CINEMA 8	Knoxville, TN	TN	37919
117	HAMILTON PLACE 8	Chattanooga, TN	TN	37421
133	PEOPLES PLAZA STADIUM 17	Newark, DE	DE	19702
147	VILLAGE PARK CINEMA STADIUM 17	Carmel, IN	IN	46033
155	CROCKER PARK STADIUM 16 & IMAX	Westlake, OH	OH	44145
161	KILN CREEK STADIUM 20	Newport News, VA	VA	23602
169	Coldwater Crossing Stadium 14	Fort Wayne, IN	IN	46825
190	SHILOH CROSSING STADIUM 18	Avon, IN	IN	46123
219	GAINESVILLE CINEMA STADIUM 14	Gainesville, FL	FL	32608
230	BEACH BOULEVARD STADIUM 18	Jacksonville, FL	FL	32250
235	STRAWBRIDGE MARKETPLACE 12	Virginia Beach, VA	VA	23454
240	COUNTRYSIDE STADIUM 20	Sterling, VA	VA	20165
241	REGAL AVENUES STADIUM 20	Jacksonville, FL	FL	32256
285	ORMOND BEACH CINEMA 12	Ormond Beach, FL	FL	32174
296	BALLSTON COMMON STADIUM 12	Arlington, VA	VA	22203
339	MAGNOLIA PLACE STADIUM 16	Coral Springs, FL	FL	33076
345	LINCOLNSHIRE STADIUM 21 & IMAX	Lincolnshire, IL	IL	60069
347	HACIENDA CROSSINGS STADIUM 20 IMAX	Dublin, CA	CA	94568
351	ROYAL PALM BEACH STADIUM 18	Royal Palm Beach, FL	FL	33411
354	MEDLOCK CROSSING 18	Johns Creek, GA	GA	30097
357	FOOTHILL TOWNE CENTER	Lake Forest, CA	CA	92610
361	RANCHO DEL REY STADIUM 16	Chula Vista, CA	CA	91910
364	GARDEN GROVE	Garden Grove, CA	CA	92841
379	REGAL WARRINGTON CROSSING STADIUM 22 & IMAX	Warrington, PA	PA	18976
380	OVIEDO MARKETPLACE STADIUM 22	Oviedo, FL	FL	32765
381	WILLOUGHBY COMMONS STADIUM 16	Willoughby, OH	OH	44094
384	STONECREST AT PIPER GLEN STADIUM 22 & IMAX	Charlotte, NC	NC	28277
388	PARKWAY PLAZA STADIUM 18 & IMAX	El Cajon, CA	CA	92020
391	SIMI VALLEY CIVIC CENTER STADIUM 16	Simi Valley, CA	CA	93063
412	CINEMA KEY WEST 6	Key West, FL	FL	33040
427	HOLLYWOOD HUNTSVILLE	Huntsville, AL	AL	35801
432	BELLTOWER STADIUM 20	Ft. Myers, FL	FL	33097
442	SAWGRASS STADIUM 23 & IMAX	Sunrise, FL	FL	33323
444	OAKMONT 8	Bradenton, FL	FL	34210
446	LARGO 8	Largo, FL	FL	33771
454	SHADOWOOD 16	Boca Raton, FL	FL	33434
463	OAKWOOD STADIUM 18	Hollywood, FL	FL	33020
465	HOLLYWOOD STADIUM 20 - NAPLES	Naples, FL	FL	34109
467	HOLLYWOOD STADIUM 20 - SARASOTA	Sarasota, FL	FL	34236
482	SOUTH BEACH 18	Miami Beach, FL	FL	33139
483	HOLLYWOOD STADIUM 16 & IMAX	Ocala, FL	FL	34474
488	HOLLYWOOD STADIUM 20 & RPX	Greenville, SC	SC	29607
489	Hollywood Stadium 27 & RPX	Nashville, TN	TN	37204

Unit #	Location	City, State	ST	Zip Code
509	BRANDYWINE TOWN CENTER 16	Wilmington, DE	DE	19803
513	GREEN HILLS STADIUM 16	Nashville, TN	TN	37215
542	WAUGH CHAPEL STADIUM 12 & IMAX	Gambrills, MD	MD	21054
556	ISLAND CINEMA	Newport Beach, CA	CA	92660
575	SUMMERLIN CENTER STADIUM 5	Summerlin, NV	NV	89135
581	HUEBNER OAKS STADIUM 14	San Antonio, TX	TX	
595	SPRINGFIELD TOWN 12	Springfield, VA	VA	22150-1701
596	LANSING MALL 12	Lansing, MI	MI	48917
615	OPRY MILLS STADIUM 20 & IMAX	Nashville, TN	TN	37214
621	CRYSTAL LAKE SHOWPLACE STADIUM 16	Crystal Lake, IL	IL	60014
633	FOX TOWER STADIUM 10	Portland, OR	OR	97205
637	GREEN VALLEY RANCH STADIUM 10	Henderson, NV	NV	89052
646	PARAMUS PARK 10	Paramus, NJ	NJ	07652
652	BRIDGEPORT VILLAGE 18	Tigard, OR	OR	97224
656	PIONEER PLACE STADIUM 6	Portland, OR	OR	97204
659	RED ROCK STATION 16	Las Vegas, NV	NV	89135
661	ARBOR CINEMA	Austin, TX	TX	
664	LOUISIANA BOARDWALK STADIUM 14	Bossier City	LA	71111
665	CORONA CROSSINGS STADIUM 18 & RPX	Corona, CA	CA	92881
670	VALLEY RIVER CENTER STADIUM 15	Eugene, OR	OR	97401
671	NEW RIVER VALLEY	Christiansburg, VA	VA	
674	SALISBURY STADIUM 16 & RPX	Salisbury, MD	MD	21801
679	LANCASTER MALL STADIUM 11	Salem, OR	OR	97301
682	PINNACLE STADIUM 18 IMAX & RPX	Knoxville, TN	TN	37934
683	SOUTHLAND MALL STADIUM 16	Miami, FL	FL	33189
684	GULF COAST STADIUM 16 & IMAX	Ft. Myers, FL	FL	33913
685	SWANSEA STANDIUM 12	Swansea, MA	MA	02777
687	LOOP STADIUM 16 & RPX	Kissimmee, FL	FL	34741
690	RIVIERA STADIUM 8	Knoxville, TN	TN	37902
697	LA LIVE	Los Angeles, CA	CA	90015
701	MALL OF GEORGIA STADIUM 20 IMAX	Buford, GA	GA	30518
704	LA HABRA STADIUM 16	La Habra, CA	CA	90631
706	CITRUS PARK STADIUM 20	Tampa, FL	FL	33625
708	OCEANSIDE STADIUM 16	Oceanside, CA	CA	92054
709	WESTFORK STADIUM 13	Pembroke Pines, FL	FL	33027
721	WINTER PARK VILLAGE STADIUM 20	Winter Park, FL	FL	32789
723	TOWN CENTER STADIUM 16	Port Charlotte, FL	FL	33948
724	AUGUSTA EXCHANGE STADIUM 20 IMAX	Augusta, GA	GA	30909
728	HAMBURG PAVILION 16	Lexington, KY	KY	40509
730	SHORT PUMP STADIUM 14 & IMAX	Richmond, VA	VA	23233
731	Treasure Coast Mall Stadium 16	Jensen Beach, FL	FL	34957
734	WATERFORD LAKES STADIUM 20 & IMAX	Orlando, FL	FL	32828
745	HOLLYWOOD STADIUM 24 @ NORTH I-85	Chamblee, GA	GA	30341
758	OLD MILL STADIUM 16	Bend, OR	OR	97702
765	CIELO VISTA STADIUM 18 & RPX	San Antonio, TX	TX	78238

Unit #	Location	City, State	ST	Zip Code
774	NATOMAS MARKETPLACE STADIUM 16 & RPX	Sacramento, CA	CA	95834
795	LIVE OAK STADIUM 18	Live Oak, TX	TX	78233
807	LLOYD CENTER 10	Portland, OR	OR	97232
814	TIGARD 11	Tigard, OR	OR	97223
815	SHERWOOD STADIUM 10	Sherwood, OR	OR	97140
836	TEXAS STATION STADIUM 18	North Las Vegas, NV	NV	
837	BOULDER STATION STADIUM 11	Las Vegas, NV	NV	89121
838	SUNSET STATION STADIUM 13	Henderson, NV	NV	89014
840	COLONNADE STADIUM 14	Las Vegas, NV	NV	89123
845	WILSONVILLE STADIUM 9	Wilsonville, OR	OR	97070
850	EVERGREEN PARKWAY 13	Hillsboro, OR	OR	97124
851	DIVISION STREET STADIUM 13	Portland, OR	OR	97236
853	HILL TOP 9	Oregon City, OR	OR	97045
855	MOVIES ON TV STADIUM 16	Hillsboro, OR	OR	97123
856	STARK STREET STADIUM 10	Gresham, OR	OR	97030
863	SANTIAM STADIUM 11	Salem, OR	OR	97317
938	FIESTA 16 STADIUM	San Antonio, TX	TX	
939	ALAMO QUARRY 16	San Antonio, TX	TX	
940	NORTHWOODS 14	San Antonio, TX	TX	
946	LAKELINE MALL 9	Cedar Park, TX	TX	
949	GATEWAY STADIUM 16	Austin, TX	TX	
950	METROPOLITAN STADIUM 16	Austin, TX	TX	
953	WESTGATE STADIUM 11	Austin, TX	TX	
1003	Edwards Anaheim Hills 14	Anaheim Hills, CA	CA	92808
1005	WESTPARK 8	Irvine, CA	CA	92606
1007	METRO POINTE STADIUM 12	Costa Mesa, CA	CA	92626
1009	CAMARILLO 12	Camarillo, CA	CA	93010
1010	IRVINE SPECTRUM 21 & IMAX	Irvine, CA	CA	92618
1012	LA VERNE STADIUM 12	La Verne, CA	CA	91750-3557
1018	CERRITOS STADIUM 10	Cerritos, CA	CA	90703
1024	NEWPORT 6	Newport Beach, CA	CA	92660
1025	UNIVERSITY TOWN CENTER 6 CINEMA	Irvine, CA	CA	92612-2752
1026	ONTARIO PALACE STADIUM 22 IMAX & RP	Ontario, CA	CA	91764
1028	BREA STADIUM 12 EAST	Brea, CA	CA	92821-4929
1029	BREA STADIUM 10 WEST	Brea, CA	CA	92821
1030	WEST COVINA STADIUM 18	West Covina, CA	CA	91790
1032	EDWARDS ALISO VIEJO STADIUM 20 & IMAX	Aliso Viejo, CA	CA	92656
1033	FRESNO STADIUM 22 & IMAX	Fresno, CA	CA	93720
1034	SAN MARCOS STADIUM 18	San Marcos, CA	CA	92069
1035	KALEIDOSCOPE STADIUM 10	Mission Viejo	CA	92691
1036	CALABASAS STADIUM 6	Calabasas, CA	CA	
1037	ONTARIO MOUNTAIN VILLAGE STADIUM 14	Ontario, CA	CA	91762
1038	VALENCIA STADIUM 12 & IMAX	Santa Clarita, CA	CA	91355-4591
1042	LONG BEACH STADIUM 26 & IMAX	Long Beach, CA	CA	90808
1043	MIRA MESA STADIUM 18 IMAX & RPX	San Diego, CA	CA	92126

Unit #	Location	City, State	ST	Zip Code
1044	SOUTH GATE STADIUM 20 & IMAX	South Gate, CA	CA	90280
1045	TEMECULA STADIUM 15 & IMAX	Temecula, CA	CA	92590
1046	FAIRFIELD STADIUM 16 & IMAX	Fairfield, CA	CA	94533
1047	CANYON COUNTRY STADIUM 10	Santa Clarita, CA	CA	91351
1048	MARKETPLACE 10	Irvine, CA	CA	92602-1200
1049	RANCHO MIRAGE STADIUM 16	El Cajon, CA	CA	92270
1051	GREENWAY GRAND PALACE 24	Houston, TX	TX	77027
1052	HOUSTON MARQ'E 23	Houston, TX	TX	77024
1053	ALHAMBRA RENAISSANCE 14	Alhambra, CA	CA	91801
1130	CONTINENTAL 10	Denver, CO	CO	80237
1169	ARDEN FAIR 6	Sacramento, CA	CA	95815
1172	BERKELEY 7	Berkeley, CA	CA	94704
1174	UA LONG BEACH 6	Long Beach, CA	CA	90803
1217	BEAUCATCHER CINEMAS	Asheville, NC	NC	28805
1259	RIVERVIEW PLAZA 17 IMAX & RPX	Philadelphia, PA	PA	
1270	LA CANADA 8	La Canada, CA	CA	91011
1275	FAIRFAX TOWNE CENTER 10	Fairfax, VA	VA	
1278	UA TARA CINEMAS 4, CHESHIRE SQUARE	Atlanta, GA	GA	30324
1286	LAGUNA VILLAGE 12	Sacramento, CA	CA	95823
1290	GRANT PLAZA 9	Philadelphia, PA	PA	
1299	Galaxy Stadium 14	Indianapolis, IN	IN	46256
1301	SEMINOLE TOWNE CENTER 10	Sanford, FL	FL	32771
1306	GALAXY STADIUM 10	Dallas, TX	TX	75238
1308	COLORADO CENTER STADIUM 9	Denver, CO	CO	
1309	PERIMETER POINTE 10	Atlanta, GA	GA	30338
1310	SNOWDEN SQUARE STADIUM	Columbia, MD	MD	214046
1315	DENVER PAVILIONS STADIUM 15	Denver, CO	CO	
1317	FOSSIL CREEK 11	Forth Worth, TX	TX	
1326	MEADOWS STADIUM 12	Denver, CO	CO	
1327	AMARILLO STAR STADIUM 14 IMAX & RPX	Amarillo, TX	TX	79124
1329	KING OF PRUSSIA STADIUM 16 IMAX & RPX	King of Prussia, PA	PA	19406
1346	ATLANTIC STATION STADIUM 16	Atlanta, GA	GA	30363
1348	Lynbrook	Lynbrook, NY	NY	11563
1413	DELTA SHORES	Sacramento, CA	CA	95832
1416	REGAL STADIUM 10	Gainesville, FL	FL	32608
1418	REGAL JANSSE MARKETPLACE 9	Thousand Oaks, CA	CA	91361
1419	Bricktown Center	Staten Island, NY	NY	10309
1462	West Town Mall 9 (Cinebarre)	Knoxville, TN	TN	37919
1467	MGM Springfield	Springfield, MA	MA	
1510	GRAVOIS Bluffs Stadium 12	Fenton, MO	MO	
1512	MASSILLON STADIUM 12	Massillon, OH	OH	44646
1515	REGAL DICKSON CITY STADIUM 14 & IMAX	Dickson City, PA	PA	18519
1517	SIMPSONVILLE STADIUM 14 & IMAX	Simpsonville, SC	SC	29681
1526	WILDER STADIUM 14	Wilder, KY	KY	41076
1550	COLORADO MILLS STADIUM 16 & IMAX	Lakewood, CO	CO	80401

Unit #	Location	City, State	ST	Zip Code
1551	GALLERY PLACE STADIUM	Washington, DC	DC	20001
1606	GILBERT STADIUM 6	Gilbert, AZ	AZ	
1610	SOUTHGLENN SKYBOX	Centennial, CO	CO	80122
1611	COCONUT POINT 16	Estero, FL	FL	33928
1612	RIVER CITY MARKETPLACE STADIUM 14	Jacksonville, FL	FL	32218
1613	PAVILION STADIUM 14	Port Orange, FL	FL	32128
1614	MAUI MALL MEGAPLEX 12	Kahului, HI	HI	96732
1617	HOLLYWOOD STADIUM 14	Topeka, KS	KS	
1618	SOUTHWIND STADIUM 12	Lawrence, KS	KS	
1623	COLLEGE STATION 14	Springfield, MO	MO	65806
1625	GALLATIN VALLEY STADIUM 11	Bozeman, MT	MT	59718
1628	SPOTLIGHT STADIUM 14	Norman, OK	OK	73072
1632	JEWEL STADIUM 16	Waco, TX	TX	76712
1633	MACARTHUR 16	Irving, TX	TX	
1634	BURLESON MOVIE STADIUM 14	Burleson, TX	TX	76028
1635	TYLER ROSE STADIUM 14	Tyler, TX	TX	75701
1636	KILLEEN STADIUM 14	Killeen, TX	TX	76543
1640	PERMIAN PALACE STADIUM 11	Odessa, TX	TX	
1641	TALL CITY STADIUM 14	Midland, TX	TX	78233
1672	DULLES TOWNCENTER 10	Dulles, VA	VA	20166
1673	TWIN PEAK MALL 12	Littleton, CO	CO	
1675	VIRGINIA GATEWAY 14	Gainesville, VA	VA	20155
1694	AVALON 12	Alpharetta, GA	GA	30009
1701	BRANFORD STADIUM 14 & RPX	Branford, CT	CT	06405
1703	WATERFORD 9	Waterford, CT	CT	06385
1704	AUGUSTA 10	Augusta, ME	ME	04330
1713	BELLINGHAM STADIUM 14	Bellingham, MA	MA	02019
1714	BERKSHIRE MALL 10	Lanesboro, MA	MA	
1715	CAPE COD MALL STADIUM 12	Hyannis, MA	MA	02601
1717	INDEPENDENCE MALL 14	Kingston, MA	MA	02364
1718	MASHPÉE COMMONS 6	Maspee, MA	MA	02649
1720	SILVER CITY GALLERIA 10	Taunton, MA	MA	
1721	SOLOMON POND STADIUM	Marlborough, MA	MA	01752
1723	WESTBOROUGH STADIUM 12	Westborough, MA	MA	01581
1726	HOOKSET 8	Hookset, NH	NH	
1728	FOX RUN STADIUM 15 & RPX	Newington, NH	NH	03801-2802
1751	MANASSAS STADIUM 14	Manassas, VA	VA	20109
1757	POTOMAC YARD STADIUM 16	Alexandria, VA	VA	
1773	GREAT NORTHERN MALL 10	North Olmsted, OH	OH	44070
1778	CARLSBAD 12	Carlsbad, CA	CA	92008
1787	BOLING BROOK SHOWPLACE 12	Bolingbrook, IL	IL	60440
1788	CANTERA STADIUM 17 & RPX	Warrenville, IL	IL	60555
1789	CITY NORTH STADIUM 14 IMAX & RPX	Chicago, IL	IL	60647
1793	WEBSTER PLACE 11	Chicago, IL	IL	60614
1794	GREENWOOD STADIUM 14	Greenwood, IN	IN	46142

Unit #	Location	City, State	ST	Zip Code
1796	EDWARDS WEST OAKS MALL STADIUM 14	Houston, TX	TX	77082
1799	SAN BERNARDINO STADIUM 14 & RPX	San Bernadino, CA	CA	92401
1801	RANCHO MIRAGE STADIUM 16	Rancho Mirage, CA	CA	92270
1802	PALM SPRINGS 9	Palm Springs, CA	CA	92262
1803	INDIO METRO 8	Indio, CA	CA	92201
1805	ESCONDIDO STADIUM 16 & IMAX	Escondido, CA	CA	92025
1807	EL DORADO HILLS STADIUM 14 & IMAX	El Dorado Hills, CA	CA	95762
1812	ARROYO GRANDE STADIUM 10	Arroyo Grande, CA	CA	93420
1813	UKIAH STADIUM 6	Ukiah, CA	CA	95482
1817	STOCKTON CITY CENTRE 16	Stockton, CA	CA	95202
1818	MODESTO STADIUM 10	Modesto, CA	CA	95356
1820	MANCHESTER STADIUM 16	Frenso, CA	CA	93720
1823	AUBURN STADIUM 10	Auburn, CA	CA	95603
1824	PLACERVILLE STADIUM 8	Placerville, CA	CA	95667
1828	DOLE CANNERY 18	Honolulu, HI	HI	96817
1830	KEAUHOU STADIUM 7	Keahou-Kona, HI	HI	96740
1842	BIRKDALE STADIUM 16	Huntersville, NC	NC	28078
1843	BRIER CREEK STADIUM 14	Raleigh, NC	NC	27617
1846	NORTH HILLS STADIUM 14	Raleigh, NC	NC	27609
1848	STARLIGHT STADIUM 14- CHARLOTTE	Charlotte, NC	NC	28262
1853	STARLIGHT STADIUM 14- ANDERSON	Anderson, SC	SC	29621-2319
1855	SANDHILL STADIUM 16 IMAX & RPX	Columbia, SC	SC	29229
1859	REGENCY STADIUM 11	Panama City, FL	FL	32406
1860	ROYAL PARK STADIUM 16	Gainesville, FL	FL	32607
1862	MAJESTIC STADIUM 20 & IMAX	Silver Spring, MD	MD	20910
1864	COMMONWEALTH CENTER STADIUM 20 & IMAX	Midlothian, VA	VA	23112
1865	KINGSTOWNE STADIUM 16 & IMAX	Alexandria, VA	VA	22315
1866	HARBOUR VIEW GRANDE 16	Suffolk, VA	VA	23435
1869	FOX STADIUM	Loudon County, VA	VA	20175
1872	BALLANTYNE VILLAGE STADIUM 5	Charlotte, NC	NC	28277
1873	MAYFAIRE STADIUM 16 & IMAX	Wilmington, NC	NC	28405
1874	CROSSROADS STADIUM 20 & IMAX	Cary, NC	NC	57518
1876	WHITE OAK STADIUM 14	Garner, NC	NC	27529
1878	BEAVER CREEK STADIUM	Apex, NC	NC	27502
1883	PARK TERRACE 6	Charlotte, NC	NC	28209
1884	PALMETTO GRANDE STADIUM 16	Mount Pleasant, SC	SC	29464
1885	CHERRYDALE STADIUM 16	Greenville, SC	SC	29609
1887	COLUMBIANA GRANDE STADIUM 14	Columbia, SC	SC	29212
1890	PROVIDENCE STADIUM 14	Mt. Juliet, TN	TN	37122
1892	BILTMORE GRANDE STADIUM 15 & RPX	Asheville, NC	NC	28803
1901	DEERFIELD TOWNE CENTER STADIUM 16	Manson, OH	OH	45040
1902	SOUTHPARK MALL STADIUM 16	Colonial Heights, VA	VA	20109
1910	WESTVIEW STADIUM 16 & IMAX	Frederick, MD	MD	21704
1914	PARK PLACE STADIUM 16 & RPX	Pinellas Park, FL	FL	33781
1922	FIESTA STADIUM 12	Henderson, NV	NV	89015



Unit #	Location	City, State	ST	Zip Code
1926	STREETS OF INDIAN LAKE STADIUM 16	Hendersonville, TN	TN	37075
1930	FENWAY STADIUM 13 & RPX	Boston, MA	MA	
1931	MERIDIAN 16	Seattle, WA	WA	98101
1933	ALIANTE STADIUM 16	North Las Vegas, NV	NV	89014
1936	WESTCHESTER COMMON STADIUM 16	Midlothian, VA	VA	23114
1938	POINTE ORLANDO STADIUM 20 & IMAX	Orlando, FL	FL	32819
1943	RIVER POINT STADIUM 14	Sheridan, CO	CO	80110
1951	KAPOLEI 12	Honolulu, HI	HI	96707
1969	STONEFIELD STADIUM 14 & IMAX	Charlottesville, VA	VA	22901
1992	WINROCK 16	Albuquerque, NM	NM	87110
	THE GRAND ESPLANADE	Kenner	LA	70065

## Cinebarre

Unit #	Location	City, State	ST	Zip Code
	CINEBARRE ISSAQUAH 8	Issaquah, WA	WA	98027
	CINEBARRE MOUNTLAKE 8	Mountlake Terrace, WA	WA	98043
	CINEBARRE MOUNT PLEASANT 11	Mount Pleasant, SC	SC	29464
	CINEBARRE BOULDER 11	Louisville, CO	CO	80027
	CINEBARRE THORNTON TOWN CENTER 9	Thornton, CO	CO	80229
	CINEBARRE SALEM 7	Salem, OR	OR	97070
	CINEBARRE ARBORTUM 11	Charlotte, NC	NC	28262
	THEATERS AT CANAL PLACE	New Orleans	LA	70130

The above guide is intended as a general and quick reference guide for some of the local and state regulations governing specific theater locations as well as specific conditions of approval that were mandated pursuant to requests for Conditional Use Approvals, Special Use Approvals and administrative approvals. Review of local and state regulations as well as completing on-site server training programs offered by each State or private third party companies is strongly recommended and encouraged as enforcement practices are subject to interpretation and can change with changes in agency policy. Please note that the summary above is limited to the main topic areas identified and is not an all-inclusive review of all applicable alcohol

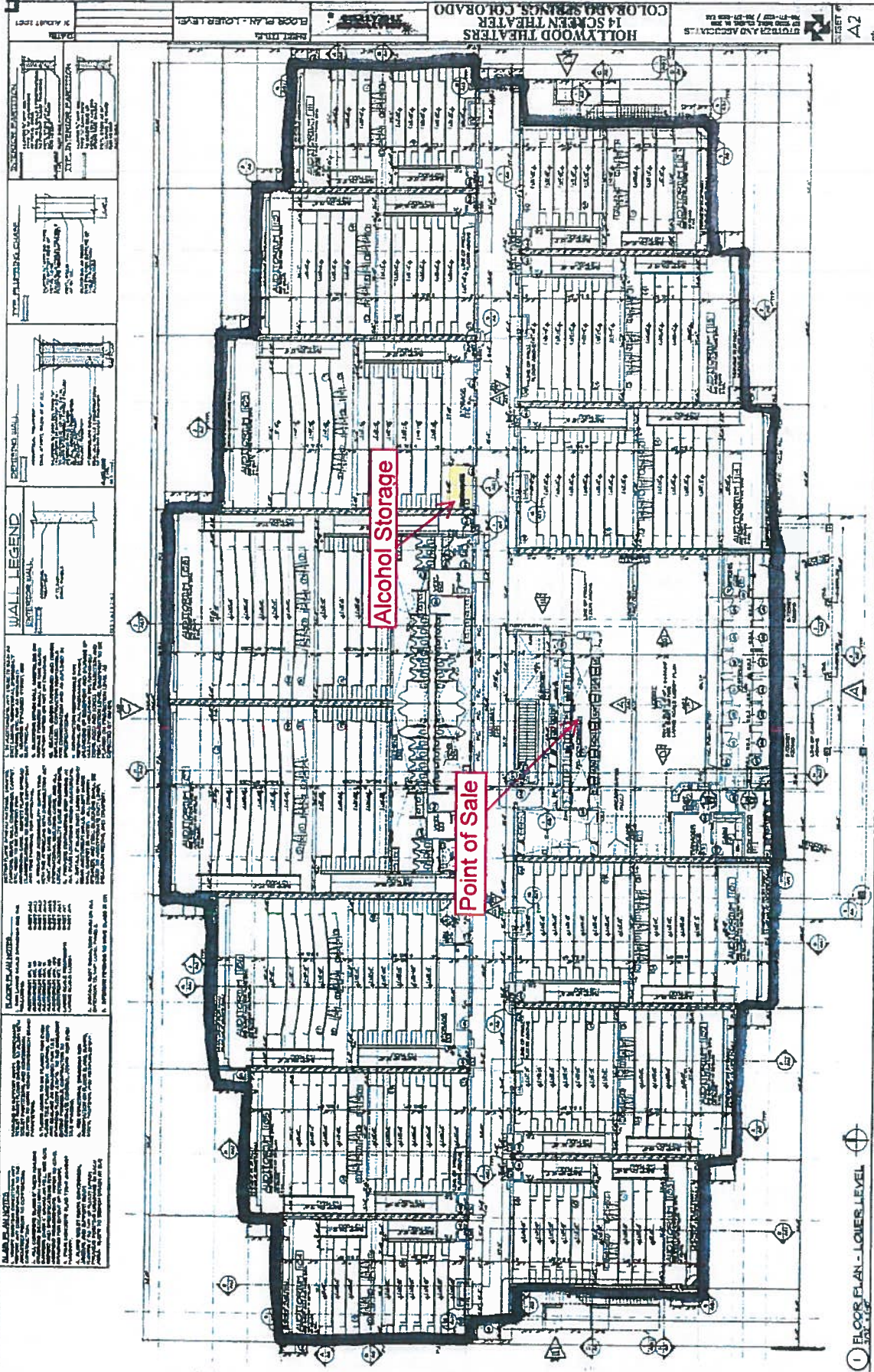

344' Lower Level

8.791



167'8"

1 FLOOR PLAN - UPPER LEVEL

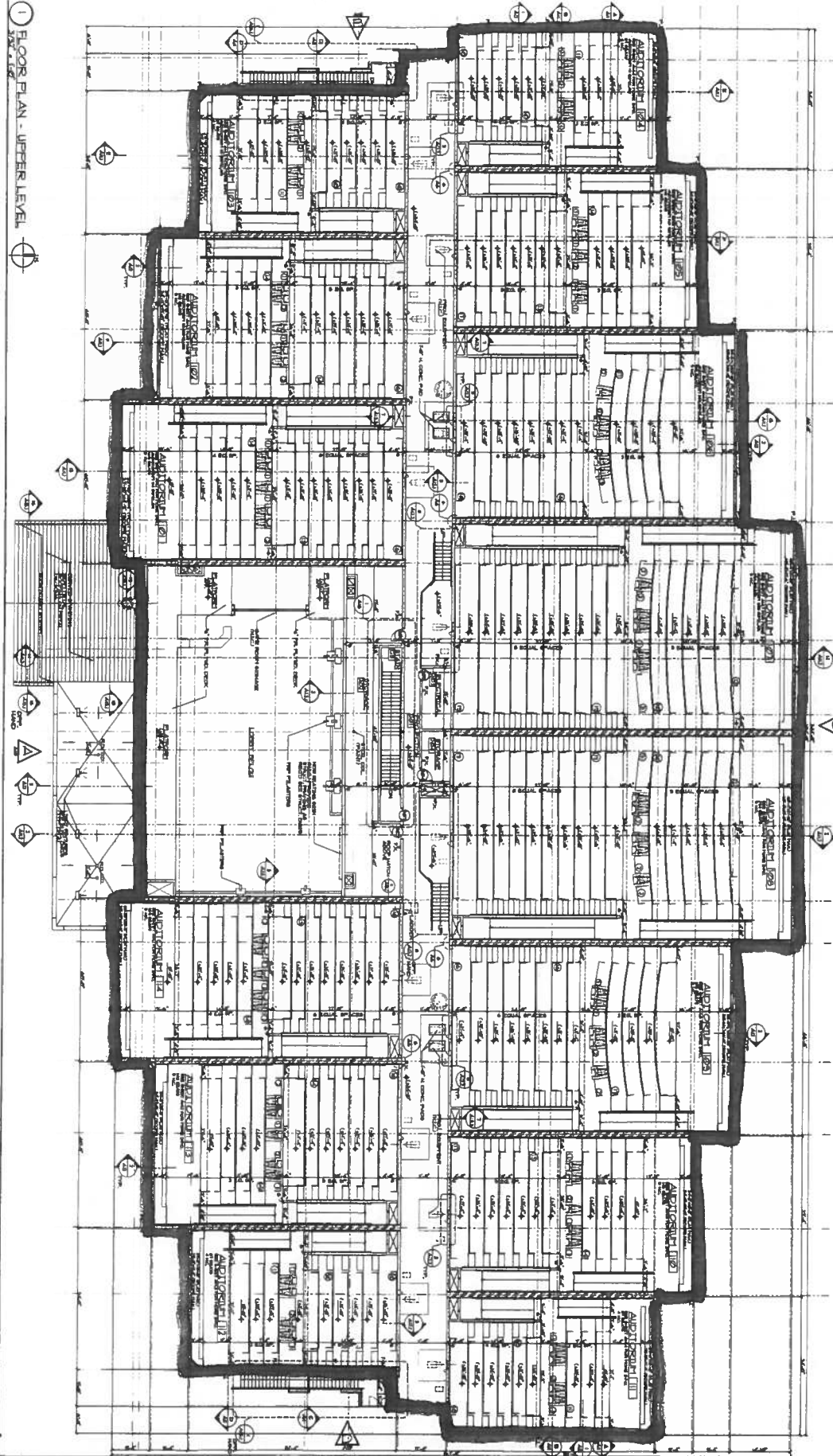

**FLOOR PLAN NOTES**

1. ALL ROOMS SHALL BE FINISHED TO THE FINISHES SHOWN ON THE FINISH SCHEDULE.
2. ALL ROOMS SHALL BE FINISHED TO THE FINISHES SHOWN ON THE FINISH SCHEDULE.
3. ALL ROOMS SHALL BE FINISHED TO THE FINISHES SHOWN ON THE FINISH SCHEDULE.
4. ALL ROOMS SHALL BE FINISHED TO THE FINISHES SHOWN ON THE FINISH SCHEDULE.
5. ALL ROOMS SHALL BE FINISHED TO THE FINISHES SHOWN ON THE FINISH SCHEDULE.
6. ALL ROOMS SHALL BE FINISHED TO THE FINISHES SHOWN ON THE FINISH SCHEDULE.
7. ALL ROOMS SHALL BE FINISHED TO THE FINISHES SHOWN ON THE FINISH SCHEDULE.
8. ALL ROOMS SHALL BE FINISHED TO THE FINISHES SHOWN ON THE FINISH SCHEDULE.
9. ALL ROOMS SHALL BE FINISHED TO THE FINISHES SHOWN ON THE FINISH SCHEDULE.
10. ALL ROOMS SHALL BE FINISHED TO THE FINISHES SHOWN ON THE FINISH SCHEDULE.
11. ALL ROOMS SHALL BE FINISHED TO THE FINISHES SHOWN ON THE FINISH SCHEDULE.
12. ALL ROOMS SHALL BE FINISHED TO THE FINISHES SHOWN ON THE FINISH SCHEDULE.
13. ALL ROOMS SHALL BE FINISHED TO THE FINISHES SHOWN ON THE FINISH SCHEDULE.
14. ALL ROOMS SHALL BE FINISHED TO THE FINISHES SHOWN ON THE FINISH SCHEDULE.
15. ALL ROOMS SHALL BE FINISHED TO THE FINISHES SHOWN ON THE FINISH SCHEDULE.
16. ALL ROOMS SHALL BE FINISHED TO THE FINISHES SHOWN ON THE FINISH SCHEDULE.
17. ALL ROOMS SHALL BE FINISHED TO THE FINISHES SHOWN ON THE FINISH SCHEDULE.
18. ALL ROOMS SHALL BE FINISHED TO THE FINISHES SHOWN ON THE FINISH SCHEDULE.
19. ALL ROOMS SHALL BE FINISHED TO THE FINISHES SHOWN ON THE FINISH SCHEDULE.
20. ALL ROOMS SHALL BE FINISHED TO THE FINISHES SHOWN ON THE FINISH SCHEDULE.

**WALL LEGEND**

**EXTENDING WALL**

**THICK PARTITION CHASE**

**INTERIOR PARTITION**

**DATE** 21 AUGUST 2007

Upper Level  
3441

A3  
STOTTER AND ASSOCIATES  
ARCHITECTS  
700 WEST 10TH AVENUE, SUITE 200  
DENVER, CO 80202  
TEL: 303.733.1111 FAX: 303.733.1112

HOLLYWOOD THEATERS  
14 SCREEN THEATER  
COLORADO SPRINGS, COLORADO

SHEET TITLE  
FLOOR PLAN - UPPER LEVEL

F-2

**BEFORE THE LOCAL LIQUOR AND BEER  
LICENSING AUTHORITY,  
CITY OF COLORADO SPRINGS,  
STATE OF COLORADO**

Address: 30 South Nevada Avenue, Suite 101  
Colorado Springs, CO 80903  
Telephone: (719) 385-5901  
Fax Number: (719) 385-5114  
Email: cityclerk@springsgov.com

CITY CLERK'S OFFICE

2019 NOV 14 A 11: 44

▲ CLERK USE ONLY ▲

**IN THE MATTER OF:**

**APPLICANT**

Hollywood Theaters, Inc.  
d/b/a **Regal Cinemas Interquest 14 & RPX**  
1120 Interquest Parkway  
Colorado Springs, CO 80920  
Mailing Address:  
10 E. Blount Avenue  
Knoxville, TN 37920

Application No: N-36486

**NOTICE OF HEARING AND INITIAL FINDINGS OF FACT**

**NOTICE OF HEARING**

This matter comes before the Local Licensing Authority Hearing Officer for hearing on **Friday, December 6, 2019 at 9:00 A.M. in Division 2, Municipal Court Building, 224 E. Kiowa Street, Colorado Springs, CO 80903** upon Hollywood Theaters, Inc. d/b/a Regal Cinemas Interquest 14 & RPX ("Applicant") application for a new Lodging and Entertainment Liquor License at 1120 Interquest Parkway, Colorado Springs, CO 80920.

At this meeting, the Hearing Officer will consider the factors outlined in Rule No. 9.08 of the Liquor and Beer Rules and Regulations for the City of Colorado Springs ("City Rules"), and it is the Applicant's burden to provide the necessary evidence to satisfy the Local Licensing Authority.

A public notice poster has been prepared for the Applicant to pick up from the City Clerk's Office at 30 S. Nevada Avenue, Suite 101. This notice poster must be posted by the Applicant at the proposed premises in a manner that is visible and conspicuous to the public no later than Tuesday, November 26, 2019. Any applicable needs and desires petitions, remonstrances, and other reports or statements in writing must be filed with the City Clerk's Office by 12:00 P.M. on Tuesday, December 3, 2019.

Pursuant to C.R.S. §44-3-312 and City Rule No. 7, the Local Licensing Authority, through the Office of the City Clerk, has conducted an investigation into Applicant's application. NOW THEREFORE these Initial Findings of Fact are presented.

## INITIAL FINDINGS OF FACT

- I. Applicant's application was filed on August 26, 2019, and within a two (2) year period prior to this date, the Local Licensing Authority has not denied an application at the above referenced location for the reason that the reasonable requirements of the neighborhood were satisfied by existing outlets, pursuant to C.R.S. §44-3-313(1)(a)(I) and City Rule 7.00(A)(1).
- II. Applicant will be entitled to possession of the premises for which the application is made pursuant to a lease, rental agreement, or other arrangement for possession of the premises, or by virtue of ownership thereof as evidenced by the possession documents submitted by Applicant and contained in the administrative file, pursuant to C.R.S. §44-3-313(1)(b) and City Rule 7.00(A)(2).
- III. The location of the premises to be licensed appears to be in compliance with the Zoning Ordinances of the City of Colorado Springs as evidenced by the Land use review report submitted by the Planning and Development Department of the City of Colorado Springs, pursuant to C.R.S. §44-3-313(1)(c) and City Rule 7.00(A)(3).
- IV. The location of the premises to be licensed appears to be in compliance with the distance prohibition in regard to any public or parochial school or the principal campus of any college, university or seminary, pursuant to C.R.S. §44-3-313(1)(d) and City Rule 7.00(A)(4).
- V. Pursuant to C.R.S. §44-3-307(1)(a)(VI), the Colorado Springs Police Department has conducted a background investigation into Applicant and there are no objections to Applicant at this time.
- VI. A review of Applicant's finances did not disclose any unlawful financial assistance as prohibited in C.R.S. §44-3-308.
- VII. Applicant is not a person prohibited as a licensee pursuant to C.R.S. §44-3-307.
- VIII. Pursuant to City Rule 6.01 neighborhood boundaries have been established, and a listing of existing licenses of a similar type that are within the established boundary area for the proposed establishment and boundary map are attached.

**ON BEHALF OF THE LOCAL LICENSING AUTHORITY done November 14, 2019.**

FOR  
THE CITY OF COLORADO SPRINGS  
LOCAL LICENSING AUTHORITY

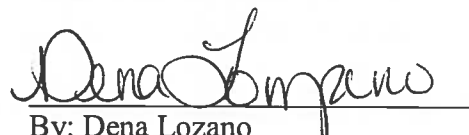
  
By: Dena Lozano  
Deputy City Clerk

Direct questions regarding this notice and hearing to Colin M. Gordon at 719-385-5107.

# Liquor Survey Boundaries

HOLLYWOOD THEATERS, INC.

d/b/a REGAL CINEMAS INTERQUEST 14 & RPX

1120 INTERQUEST PKWY



OFFICE OF THE CITY CLERK

License ID: 36486

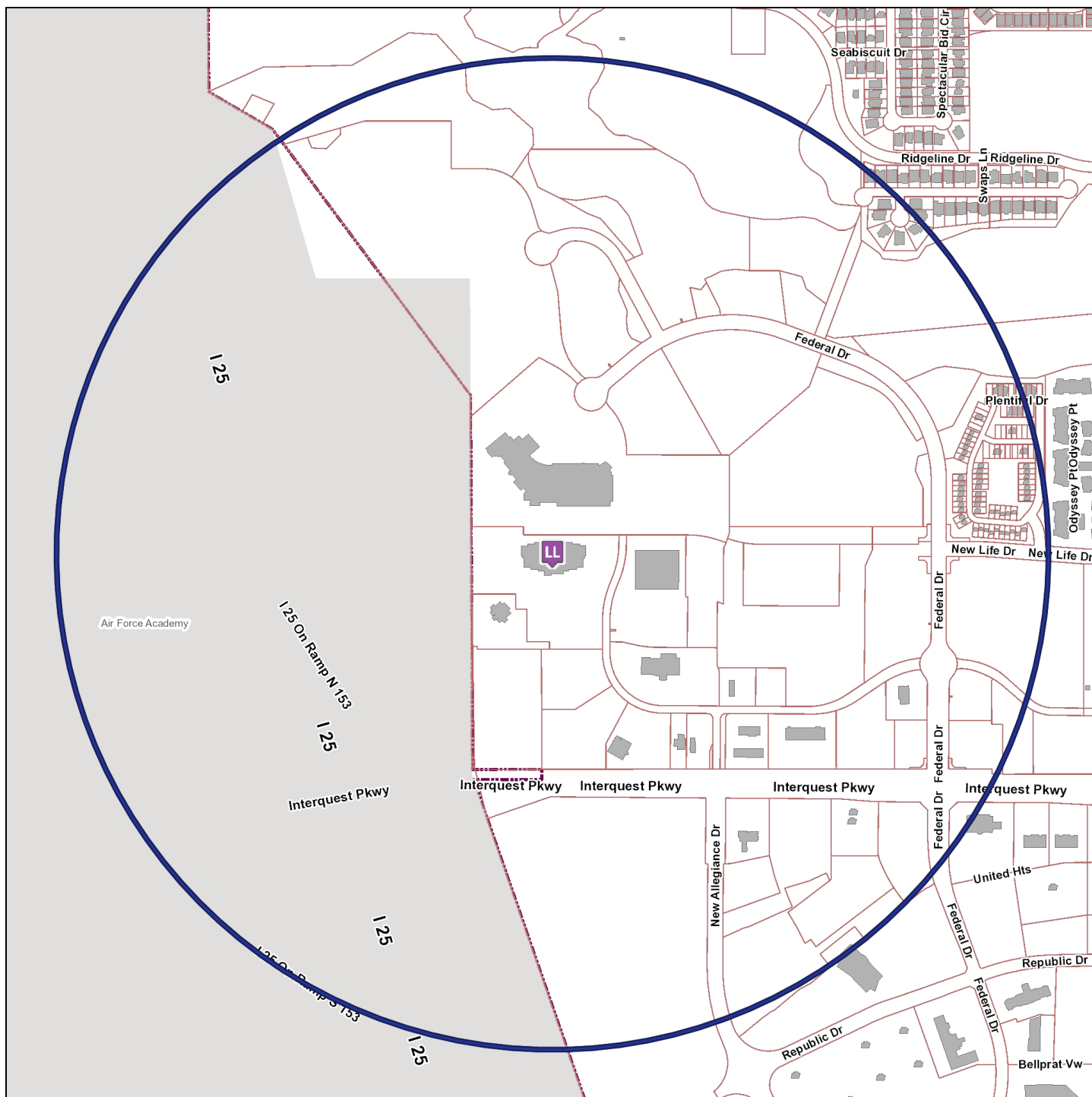

0 0.25 0.5 1 Mile

The survey boundary is 0.5 miles from the establishment

Map Prepared: 11/14/2019 10:00 AM

Copyright © 2019 City of Colorado Springs on behalf of the Colorado Springs Utilities. All rights reserved. This work, and/or the data contained hereon, may not be modified, republished, used to prepare derivative works or commercially exploited in any manner without the prior express written consent of the City of Colorado Springs. This work was prepared utilizing the best data available at the time of creation. Neither the City of Colorado Springs, the Colorado Springs Utilities, nor any of their employees makes any warranty, express or implied, or assumes any legal liability or responsibility for accuracy, completeness, or usefulness of any data contained hereon. The City of Colorado Springs, Colorado Springs Utilities, and their employees explicitly disclaim any responsibility for the data contained hereon.



## OFFICE OF THE CITY CLERK

### HEARING LETTER ATTACHMENT

License ID: 36486

HOLLYWOOD THEATERS, INC.

d/b/a REGAL CINEMAS INTERQUEST 14 & RPX

1120 INTERQUEST PKWY

COLORADO SPRINGS, CO 80920

### EXISTING SIMILAR LICENSES WITHIN BOUNDARY AREA

<u>Business d/b/a</u>	<u>Business Address</u>	<u>License Type</u>	
1) GREAT WOLF LODGE	9494 FEDERAL DR	Hotel & Restaurant	431.26 ft
2) COLORADO MOUNTAIN BREWERY	11202 RAMPART HILLS VW	Brew Pub	466.44 ft
3) THE SUMMIT INTERQUEST	1180 INTERQUEST PKWY	Hotel & Restaurant	555.32 ft
4) DRURY INN & SUITES - COLORADO SPRINGS	1170 INTERQUEST PKWY	Lodging & Entertainment	903.98 ft
5) CHEDDARS CASUAL CAFE	1140 INTERQUEST PKWY	Hotel & Restaurant	1,059.91 ft
6) DICKEY'S BARBECUE PIT	1252 INTERQUEST PKWY	Beer & Wine	1,634.40 ft

## **CERTIFICATE OF MAILING**

---

I, Colin M. Gordon, hereby certify that I have mailed a true copy of the foregoing **NOTICE OF HEARING AND INITIAL FINDINGS OF FACT** by United States mail, first class postage paid, on November 14, 2019 to the following address of record:

Hollywood Theaters, Inc.  
d/b/a Regal Cinemas Interquest 14 & RPX  
10 E. Blount Avenue  
Knoxville, TN 37920

---

Colin M. Gordon  
License Enforcement Officer  
City Clerk's Office  
30 S. Nevada Avenue, Suite 101  
Colorado Springs, CO 80903

CC: bproffitt@runprolaw.com  
aclark@runprolaw.com  
1609@regalcinemas.com