

CITY OF COLORADO SPRINGS LIQUOR OR 3.2% FERMENTED MALT BEVERAGE APPLICATION

☒ NEW LICENSE ☐ TRANSFER OF OWNERSHIP

Type of License applying for (Check One)

- | | | | | |
|--|---|---|--|-----------------------------------|
| <input checked="" type="checkbox"/> Hotel/Restaurant | <input type="checkbox"/> Hotel/Restaurant w/Optional Premises | <input type="checkbox"/> Tavern | <input type="checkbox"/> Beer & Wine | <input type="checkbox"/> Brew Pub |
| <input type="checkbox"/> Retail Liquor Store | <input type="checkbox"/> 3.2% Beer On Premises | <input type="checkbox"/> 3.2% Beer Off Premises | <input type="checkbox"/> 3.2% Beer On and Off Premises | |
| <input type="checkbox"/> Drugstore | <input type="checkbox"/> Racetrack | <input type="checkbox"/> Optional Premises | <input type="checkbox"/> Club | <input type="checkbox"/> Vinters |

APPLICANT INFORMATION

Name of Applicant: <u>Lastrella Enterprise, LLC</u>	Property Tax Schedule No. : <u>6301110113</u>
Trade Name (DBA): <u>Sushi Ring III</u>	Business Telephone: <u>Pending</u>
Address of Premises: <u>5490 Powers Center Point Suite 164 & 172</u>	Alternate Telephone: <u>719-213-4950</u>

IF THIS IS A TRANSFER OF AN EXISTING LICENSE - THE FOLLOWING MUST BE ANSWERED:

Present trade name of establishment (dba)	Present State License No.	Present Class of License	Present Expiration Date
<u>N/A</u>			

If the applicant is: a Corporation, Limited Liability Company, Partnership or Association, list all officers, directors, general partners and managing members, position held and percentage owned.

NAME	POSITION HELD	%OWNED
<u>Promencio Osio Lastrella</u>	<u>Member</u>	<u>50%</u>
<u>Emiliano Lastrella</u>	<u>Member</u>	<u>50%</u>

FINANCIAL INFORMATION

TOTAL INVESTMENT IN BUSINESS (include purchase, start up, inventory)	<u>\$ 90,000.00</u>	
Source(s) of funds invested (provide names, banks, and indicate checking, savings, loan, promissory note, gift or other). THE FOLLOWING INFORMATION MUST REFLECT THE SOLE SOURCE OF FUNDS INVESTED. NO OTHER PERSON OR PARTIES MAY HAVE A FINANCIAL INTEREST IN THE BUSINESS FOR WHICH THIS AFFIDAVIT IS SUBMITTED.		
NAME/ADDRESS OF FUNDING SOURCE (bank(s), individual(s), et al.)	FUNDING SOURCE (checking/savings/ loan/ note/ gift)	AMOUNT
<u>Cash Existing Funds</u>	<u>U.S Bank Checking</u>	<u>\$90,000.00</u>

List applicant(s) prior experience in the sale of alcoholic beverages. Include dates and locations.

Business Name & Address	Applicant's Name	Experience/Position	Dates
<u>None</u>			

DO NOT ALTER THESE FORMS IN ANY MANNER

Has the applicant previously been issued a liquor or beer license (include any of the partners, if a partnership; members or manager if a limited liability company; or officers, stockholders or directors if a corporation)? ☐ yes ☒ no

If yes, identify the business and any current or former financial interest in said business including any loans to or from a licensee.

Name of Business	Address	Type/amt. of Interest
N/A		

PREMISES/ESTABLISHMENT

Terms of legal possession of the premises for which the application is made? ☐ own ☒ lease

If leased provide terms: Start date 01-01-2016 End date 05-31-2023

Dimensions of premises 30' X 64" Square footage 1,928 Seating Capacity 49

Is there a patio area? ☐ yes ☒ no -- If yes, provide dimensions N/A

Anticipated number of employees? 10

Will training be offered or required? ☒ yes ☐ no -- If yes, through what agency? Liquor Licensing Professionals

Has the applicant or manager in Colorado, or any other State (include any of the partners, if a partnership; members or manager if a limited liability company; or officers, stockholders or directors if a corporation), ever:	YES	NO
Been denied an alcohol beverage license?		X
Had an alcohol beverage license suspended or revoked?		X
Had interest in another entity where an alcohol beverage license was suspended or revoked?		X
Ever been charged or convicted of a crime, received a suspended sentence, a deferred sentence, or have charges pending?		X
If yes, provide explanation, date(s) and location(s).		
N/A		

Has the applicant ever received a violation notice, suspension, or revocation for any liquor law violation, have charges pending; or has the applicant applied for and been denied a liquor or beer license anywhere in the United States?

Yes ☐ No ☒

If yes, provide explanation, date(s) and location(s):

I declare under the penalty of perjury in the second degree that this application and all attachments are true, correct, and complete to the best of my knowledge. I understand that any falsehood or omission will jeopardize the application as such falsehood or omission constitutes evidence regarding the character of the applicant.

State of Colorado
County of El Paso

Subscribed and sworn to before me this 17 day of February

My Commission Expires: 05/09/18

Title: Member

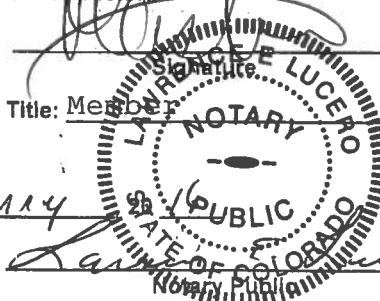

DO NOT ALTER THESE FORMS IN ANY MANNER

Lastrella Enterprise, I
 Sushi ring III
 5490 Powers Center Point C/S Co. 80920
 Suite 164 & 172

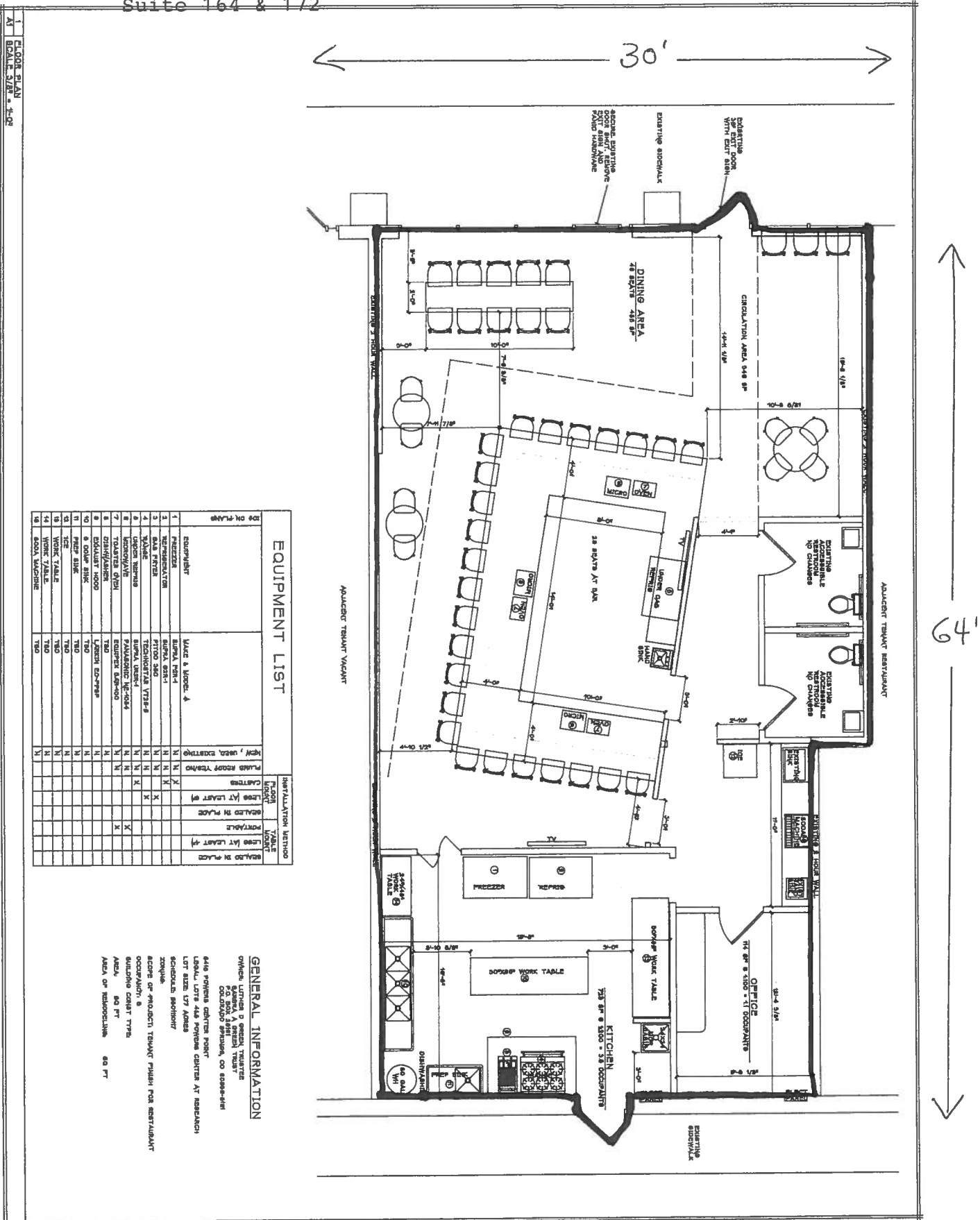

BEFORE THE COLORADO SPRINGS LIQUOR AND BEER LICENSING BOARD CITY OF COLORADO SPRINGS, STATE OF COLORADO Address: 107 North Nevada Avenue Council Chambers, City Hall Colorado Springs, CO 80903	CITY CLERK'S OFFICE 2016 MAR 28 P 12: 28
<hr/> IN THE MATTER OF: Lastrella Enterprise, LLC d/b/a Sushi Ring III 5490 Powers Center Point, #164 & 172 Colorado Springs, CO 80920 Mailing Address: 1050 Crosstrail Drive Colorado Springs, CO 80906	<hr/> <p style="text-align: center;">▲ BOARD USE ONLY ▲</p> <hr/> <p style="text-align: right;">Application No: N-30426</p>
NOTICE OF HEARING AND INITIAL FINDINGS OF FACT	

NOTICE OF HEARING

This matter comes before the Board for hearing on **Friday, April 15, 2016 at 9:00 A.M. in the City Council Chambers of City Hall at 107 N. Nevada Avenue** upon Lastrella Enterprise, LLC d/b/a Sushi Ring III ("Applicant") application for a new Hotel and Restaurant Liquor License at 5490 Powers Center Point, #164 & 172, Colorado Springs, CO 80920.

At this meeting, the Board will consider the factors outlined in Rule No. 9.08 of the Local Rules of Procedure, and it is the Applicant's burden to provide the necessary evidence to satisfy the Board.

A public notice poster has been prepared for the Applicant to pick up from the City Clerk's Office at 30 S. Nevada Avenue, Suite 101. This notice poster must be posted by the Applicant at the proposed premises in a manner that is visible and conspicuous to the public no later than **Tuesday, April 5, 2016.** Any applicable needs and desires petitions, remonstrances, and other reports or statements in writing must be filed with the City Clerk's Office by 12:00 P.M. on Tuesday, April 12, 2016.

Pursuant to C.R.S. §12-47-312 and Local Rule No. 7 the Local Licensing Authority, through the Office of the City Clerk, has conducted an investigation into Applicant's application. NOW THEREFORE these Initial Findings of Fact are presented.

INITIAL FINDINGS OF FACT

- I. Applicant's application was filed on February 17, 2016, and within a two (2) year period prior to this date, the Local Licensing Authority has not denied an application at the above referenced location for the reason that the reasonable requirements of the neighborhood were satisfied by existing outlets.
- II. Applicant will be entitled to possession of the premises for which the application is made pursuant to a lease, rental agreement, or other arrangement for possession of the premises, or by virtue of ownership thereof as evidence by the possession documents submitted by Applicant and contained in the administrative file.
- III. The location of the premises to be licensed appears to be in compliance with the Zoning Ordinances of the City of Colorado Springs as evidenced by the Land use review report submitted by the Planning and Development Department of the City of Colorado Springs.
- IV. The location of the premises to be licensed appears to be in compliance with the distance prohibition in regard to any public or parochial school or the principal campus of any college, university or seminary.
- V. The Colorado Springs Police Department has conducted a background investigation into Applicant and there are no objections to Applicant at this time.
- VI. A review of Applicant's finances did not disclose any unlawful financial assistance as prohibited in C.R.S. §12-47-308.
- VII. Applicant is not a person prohibited as a licensee pursuant to C.R.S. §12-47-307.
- VIII. Pursuant to Local Rule 6.01 neighborhood boundaries have been established, and a listing of existing licenses of a similar type that are within the established boundary area for the proposed establishment and boundary map are attached.

ON BEHALF OF THE LOCAL LICENSING AUTHORITY done March 28, 2016.

FOR THE CITY OF COLORADO
SPRINGS LIQUOR AND BEER
LICENSING BOARD



By: Sarah B. Johnson
City Clerk

Direct questions regarding this notice and hearing to Lee McRae at 719-385-5106.

Liquor Survey Boundaries

LASTRELLA ENTERPRISE, LLC

d/b/a SUSHI RING III

5490 POWERS CENTER PT #164 & 172



OFFICE OF THE CITY CLERK

License ID: 30426

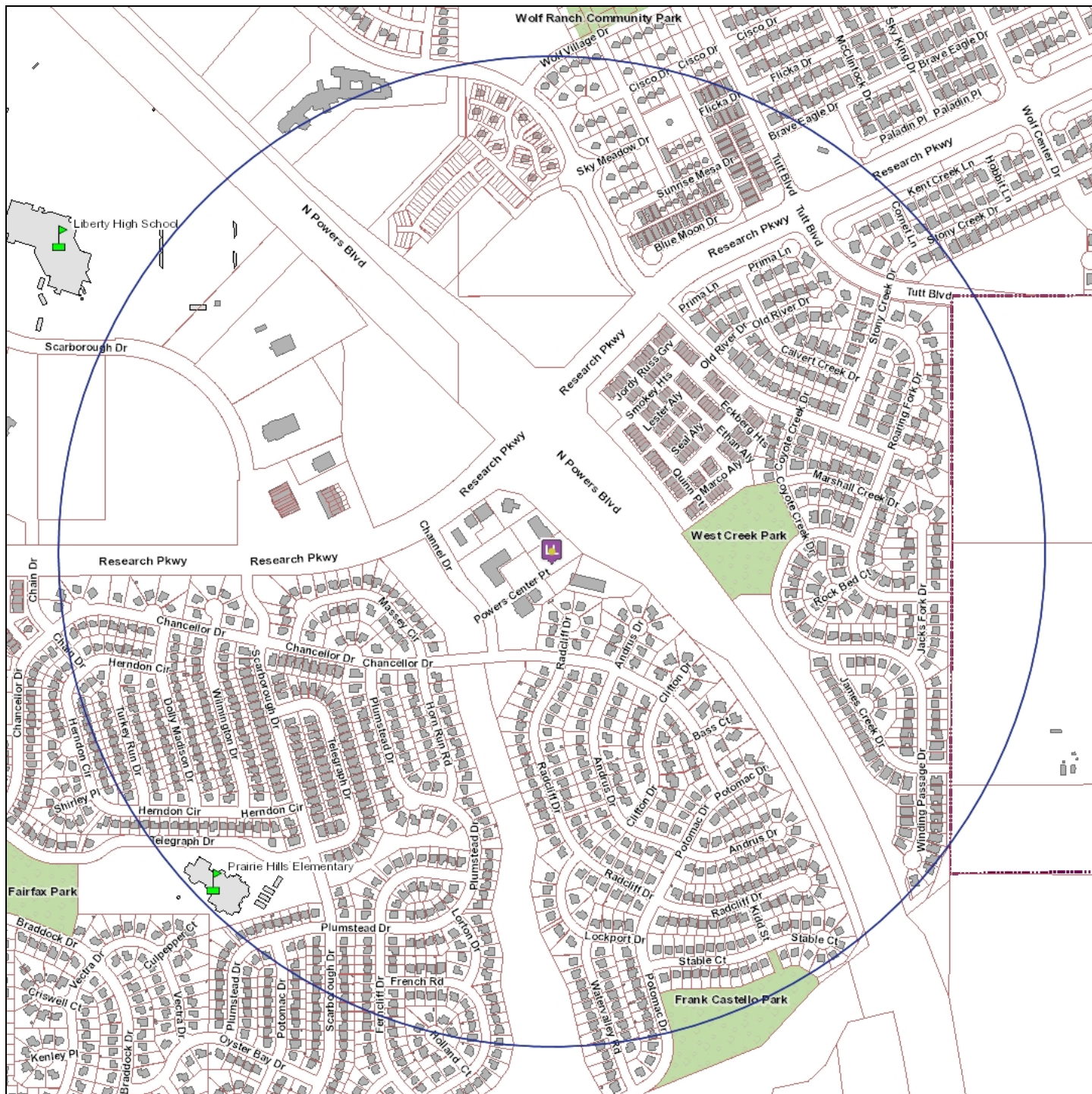

The survey boundary is 0.5 miles from the establishment

Map Prepared: 3/24/2016 9:52 AM

Copyright © 2016 City of Colorado Springs on behalf of the Colorado Springs Utilities. All rights reserved. This work, and/or the data contained hereon, may not be modified, republished, used to prepare derivative works or commercially exploited in any manner without the prior express written consent of the City of Colorado Springs. This work was prepared utilizing the best data available at the time of creation. Neither the City of Colorado Springs, the Colorado Springs Utilities, nor any of their employees makes any warranty, express or implied, or assumes any legal liability or responsibility for accuracy, completeness, or usefulness of any data contained hereon. The City of Colorado Springs, Colorado Springs Utilities, and their employees explicitly disclaim any responsibility for the data contained hereon.



OFFICE OF THE CITY CLERK

HEARING LETTER ATTACHMENT

License ID: 30426

LASTRELLA ENTERPRISE, LLC

d/b/a SUSHI RING III

5490 POWERS CENTER PT #164 & 172

COLORADO SPRINGS, CO 80920

EXISTING SIMILAR LICENSES WITHIN BOUNDARY AREA

<u>Business d/b/a</u>	<u>Business Address</u>	<u>License Type</u>	
1) BORRIELLO BROTHERS NY PIZZA	5490 POWERS CENTER PT	Hotel & Restaurant	54.02 ft

CERTIFICATE OF MAILING

I, Lee McRae, hereby certify that I have mailed a true copy of the foregoing **NOTICE OF HEARING AND INITIAL FINDINGS OF FACT** by United States mail, first class postage paid, on March 28, 2016 to the following address of record:

Lastrella Enterprise, LLC
dba Sushi Ring III
1050 Crosstrail Drive
Colorado Springs, CO 80906

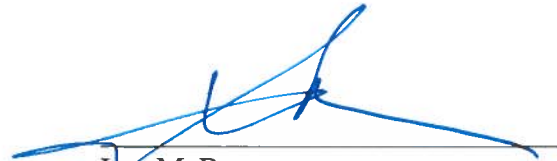

Lee McRae
License Enforcement Officer
City Clerk's Office
30 S. Nevada Avenue, Suite 101
Colorado Springs, CO 80903

CC: elastrella@aol.com