

# CITY OF COLORADO SPRINGS

## LIQUOR OR 3.2% FERMENTED MALT BEVERAGE APPLICATION

☒ **NEW LICENSE**
                         
 ☐ **TRANSFER OF OWNERSHIP**

*Type of License applying for (Check One)*

- |  |   |   |  |                                   |
|--|---|---|--|-----------------------------------|
| <input type="checkbox"/> Hotel/Restaurant    | <input type="checkbox"/> Hotel/Restaurant w/Optional Premises | <input checked="" type="checkbox"/> Tavern      | <input type="checkbox"/> Beer & Wine                   | <input type="checkbox"/> Brew Pub |
| <input type="checkbox"/> Retail Liquor Store | <input type="checkbox"/> 3.2% Beer On Premises                | <input type="checkbox"/> 3.2% Beer Off Premises | <input type="checkbox"/> 3.2% Beer On and Off Premises |                                   |
| <input type="checkbox"/> Drugstore           | <input type="checkbox"/> Racetrack                            | <input type="checkbox"/> Optional Premises      | <input type="checkbox"/> Club                          | <input type="checkbox"/> Vinters  |

### APPLICANT INFORMATION

<b>Name of Applicant:</b> Drury Colorado Springs LLC & Drury Hotels Company LLC	<b>Property Tax Schedule No. :</b> 622-020-1023
<b>Trade Name (DBA):</b> Drury Inn & Suites - Colorado Springs	<b>Business Telephone:</b> 719-592-2500
<b>Address of Premises:</b> 1170 Interquest Pkwy, Colorado Springs, CO 80921	<b>Alternate Telephone:</b> 314-429-2255

IF THIS IS A TRANSFER OF AN EXISTING LICENSE – THE FOLLOWING MUST BE ANSWERED:			
Present trade name of establishment (dba)	Present State License No.	Present Class of License	Present Expiration Date
N/A			

If the applicant is: a Corporation, Limited Liability Company, Partnership or Association, list all officers, directors, general partners and managing members, position held and percentage owned.		
NAME	POSITION HELD	%OWNED
Please see Attachment C.		

### FINANCIAL INFORMATION

<b>TOTAL INVESTMENT IN BUSINESS</b> (include purchase, start up, inventory)	<b>\$ 238,370</b>	
<b>Source(s) of funds invested</b> (provide names, banks, and indicate checking, savings, loan, promissory note, gift or other).		
<b>THE FOLLOWING INFORMATION MUST REFLECT THE SOLE SOURCE OF FUNDS INVESTED. NO OTHER PERSON OR PARTIES MAY HAVE A FINANCIAL INTEREST IN THE BUSINESS FOR WHICH THIS AFFIDAVIT IS SUBMITTED.</b>		
NAME/ADDRESS OF FUNDING SOURCE (bank(s), individual(s), et al.)	TYPE OF FUNDING SOURCE (checking, savings, loan, note, gift)	AMOUNT
Drury Development Corporation	Checking, US Bank	238,370

List applicant(s) prior experience in the sale of alcoholic beverages. Include dates and locations.			
Business Name & Address	Applicant's Name	Experience/Position	Dates
Please see Attachment B.			

THESE FORMS SHOULD NOT BE ALTERED IN ANY MANNER

Has the applicant previously been issued a liquor or beer license (include any of the partners, if a partnership; members or manager if a limited liability company; or officers, stockholders or directors if a corporation)? ☒ yes ☐ no

If yes, identify the business and any current or former financial interest in said business including any loans to or from a licensee.

Name of Business	Address	Type/amt. of Interest
See attached B		

### PREMISES/ESTABLISHMENT

Terms of legal possession of the premises for which the application is made? ☒ own ☐ lease

If leased provide terms: Start date N/A End date N/A

Dimensions of premises Approx 99' x 52' Square footage 4,370 SF Seating Capacity 104

Is there a patio area? ☐ yes ☒ no -- If yes, provide dimensions N/A

Anticipated number of employees? 35-40

Will training be offered or required? ☒ yes ☐ no -- If yes, through what agency? Drury In-House Training

Has the applicant or manager in Colorado, or any other State (include any of the partners, if a partnership; members or manager if a limited liability company; or officers, stockholders or directors if a corporation), ever:	YES	NO
Been denied an alcohol beverage license?		<input checked="" type="checkbox"/>
Had an alcohol beverage license suspended or revoked?		<input checked="" type="checkbox"/>
Had interest in another entity where an alcohol beverage license was suspended or revoked?		<input checked="" type="checkbox"/>
Ever been charged or convicted of a crime, received a suspended sentence, a deferred sentence, or have charges pending?		<input checked="" type="checkbox"/>
If yes, provide explanation, date(s) and location(s).		
See attached A		

Has the applicant ever received a violation notice, suspension, or revocation for any liquor law violation, have charges pending; or has the applicant applied for and been denied a liquor or beer license anywhere in the United States?

Yes ☒ No ☐

If yes, provide explanation, date(s) and location(s):  
See attached A

I declare under the penalty of perjury in the second degree that this application and all attachments are true, correct, and complete to the best of my knowledge. I understand that any falsehood or omission will jeopardize the application as such falsehood or omission constitutes evidence regarding the character of the applicant.



State of MISSOURI  
County of ST. LOUIS

Jacqueline Pung  
Signature  
Title: Vice President & Secretary

Subscribed and sworn to before me this 2nd day of March, 20 15.

My Commission Expires: 04/14/2015

Dana L. Hunter  
Notary Public

THESE FORMS SHOULD NOT BE ALTERED IN ANY MANNER

ATTACHMENT C: OWNERSHIP  
DRURY INN & SUITES – COLORADO SPRINGS

Re: #20. If applicant is a corporation, partnership, association or limited liability company, applicant **must list all officers, directors, general partners, and managing members.** In addition, applicant **must list** any stockholders, partners, or members with **ownership of 10% of more in the applicant.** **All persons with ownership of 10% or more must** also attach form DR8404-I (Individual History Record), and submit fingerprint cards to their local licensing authority. Limited Liability Companies and Partnerships must account for 100% of ownership. Corporations must account for the President, Vice-President, Secretary and Treasurer.

**CO-LICENSEE:**  
**DRURY HOTELS COMPANY, LLC, a Nevada limited liability company (“DHC”)**

<u>MEMBER NAME</u>	<u>ADDRESS</u>	<u>DOB</u>	<u>TITLE</u>	<u>%</u>
DDC Hotels, Inc.	721 Emerson Road, Suite 200, St. Louis, MO 63141	N/A	Member	50%
DSW Industries, Inc	101 S. Farrar Dr., Cape Girardeau, MO 63701	N/A	Member	50%
Charles L. Drury, Jr.*	1 Woodbridge Manor Road, St. Louis, MO 63141	11/04/55	President	
Lambert Carr Trovillion*	8111 Westmoreland Ave, St. Louis, MO 63105	03/15/55	VP, Treasurer	
Joseph B. Pereles*	13456 Maple Ridge Court, St. Louis, MO 63141	04/21/53	VP, Secretary	
Eric C. Strand	12915 Woodlark Lane, St. Louis, MO 63131	08/18/60	VP- Operations	
<b>Total:</b>				100%

**DDC HOTELS, INC., a Missouri corporation (“DDC”)**

<u>MEMBER NAME</u>	<u>ADDRESS</u>	<u>DOB</u>	<u>TITLE</u>	<u>% OF DDC</u>	<u>% OF DHC</u>
Drury Development Corporation	721 Emerson Road, Suite 200 St. Louis, MO 63141	N/A	Sole Shareholder	100%	50%
Janice Roupp*	433 Farrar Drive Cape Girardeau, MO 63701	11/22/59	Director of Drury Development Corporation		
Charles L. Drury, Sr.*	10 Woodbridge Manor Road St. Louis, MO 63141	10/25/27	Chairman, CEO, Director		
Timothy M. Drury*	15 Squires Lane St. Louis, MO 63131	12/01/58	President, Director		

ATTACHMENT C: OWNERSHIP STRUCTURE OF DRURY INN & SUITES – COLORADO SPRINGS  
UPDATED 3/2015

Shirley J. Drury*	10 Woodbridge Manor Road St. Louis, MO 63141	05/26/35	Director, Sr VP		
Charles L. Drury, Jr.*	1 Woodbridge Manor Road St. Louis, MO 63141	11/04/55	Sr VP, Director		
Larry Hasselfeld	13812 Wellington Manor Court St. Louis, MO 63017	06/05/56	Asst Secretary, Sr VP		
Jacqueline Pollvogt*	601 N. Spode Road St. Louis, MO 63141	08/16/63	Sr VP, Secretary		
<b>Total:</b>			100%		50%

**DSW INDUSTRIES, INC., a Nevada corporation ("DSW")**

<b>MEMBER NAME</b>	<b>ADDRESS</b>	<b>DOB</b>	<b>TITLE</b>	<b>% OF DSW</b>	<b>% OF DHC</b>
Drury Southwest, Inc.	101 S. Farrar Drive Cape Girardeau, MO 63701	N/A	Sole Shareholder	100%	50%
Richard G. Drury*	1503 Blue Crest Lane San Antonio, TX 78232	04/20/61	Director of Drury Southwest, Inc.		
Dennis Vollink*	1903 Sherwood Drive Cape Girardeau, MO 63701	03/06/52	President, Director		
Carolyn F. Bohnert	3312 Shenandoah Ridge Cape Girardeau, MO 63701	09/23/42	Sr VP, Treasurer, Director		
Larry J. Westrich	381 Royal Lake Drive Cape Girardeau, MO 63701	04/15/62	VP, Director		
Herbert J. Wedemeier*	180 East Lake Drive Cape Girardeau, MO 63701	10/03/56	Director		
<b>Total:</b>				100%	50%

\* Individual qualified on liquor licensing

**CO-LICENSEE:****DRURY COLORADO SPRINGS, LLC, a Missouri limited liability company ("DCS")**

<u>MEMBER NAME</u>	<u>ADDRESS</u>	<u>DOB</u>	<u>TITLE</u>	<u>%</u>
DDC Colorado Springs, LLC	721 Emerson Road, Suite 200, St. Louis, MO 63141	N/A	Managing Member	50%
Interquest Drury, LLC	111 S. Tejon St, Ste 222, Colo Springs, CO 80903	N/A	Member	50%
<b>Total:</b>				100%

**DDC COLORADO SPRINGS, LLC, a Missouri limited liability company ("DDC")**

<u>MEMBER NAME</u>	<u>ADDRESS</u>	<u>DOB</u>	<u>TITLE</u>	<u>% OF DDC</u>	<u>% OF DCS</u>
Drury Development Corporation, Inc.	721 Emerson Road, Suite 200 St. Louis, MO 63141	N/A	Member	100%	50%
Timothy M. Drury*	15 Squires Lane St. Louis, MO 63131	12/01/58	Manager, President		
Larry Hasselfeld	13812 Wellington Manor Court St. Louis, MO 63017	06/05/56	Manager, VP		
Jacqueline D. Pollvogt*	601 N. Spoeede Road St. Louis, MO 63141	08/16/63	Manager, VP, Secretary		
Anthony C. Right	695 West Glendale Road St. Louis, MO 63119	01/28/71	VP		
<b>Total:</b>				100%	50%

**INTERQUEST DRURY, LLC, a Colorado limited liability company ("ID")**

<u>MEMBER NAME</u>	<u>ADDRESS</u>	<u>DOB</u>	<u>TITLE</u>	<u>% OF ID</u>	<u>% OF DCS</u>
Nor'wood Limited, Inc.	4065 Sinton Road, Suite 200 Colorado Springs, CO 80907	N/A	Manager	0	0
No Individual Members own 10% or more of Applicant.				100%	50%
<b>Total:</b>				100%	50%

\* Individual qualified on liquor licensing

ATTACHMENT C: OWNERSHIP STRUCTURE OF DRURY INN & SUITES – COLORADO SPRINGS  
UPDATED 3/2015

ATTACHMENT B: OTHER INTERESTS  
DRURY INN & SUITES – COLORADO SPRINGS

DR8404 Q #11: Has a liquor or beer license ever been issued to the applicant (including any of the partners, if a partnership; members or manager if a limited liability company; or officers, stockholders or directors if a corporation)?

DR8404-I Q #8: Have you ever applied for, held, or had an interest in a State of Colorado Liquor or Beer License, or loaned money, furniture or fixtures, equipment or inventory, to any liquor or beer licensee?

1. Drury Plaza Hotel- Chesterfield
  - a. 355 Chesterfield Center East Chesterfield, MO 63017
2. Drury Inn- Columbia
  - a. 1000 Knipp Street Columbia, MO 65203
3. Drury Inn & Suites- Creve Coeur
  - a. 11980 Olive Blvd. Creve Coeur, MO 63141
4. Drury Inn & Suites- Fenton
  - a. 1088 South Highway Drive Fenton, MO 63026
5. Drury Inn- Rolla
  - a. 2006 North Bishop Avenue Rolla, MO 65401
6. Drury Inn & Suites- St. Louis Convention Center
  - a. 711 N. Broadway St. Louis, MO 3102
7. Drury Inn & Suites- St. Louis Southwest
  - a. 5 Lambert Drury Place St. Louis, MO 63088
8. Drury Inn- St. Louis Union Station
  - a. 201 South 20<sup>th</sup> Street St. Louis, MO 63103
9. Drury Inn- St. Peters
  - a. 80 Mid Rivers Mall Drive St. Peters, MO 63376
10. Drury Inn- St. Louis Airport
  - a. 10490 Natural Bridge Road St. Louis, MO 63134
11. Drury Inn & Suites- St. Louis near Forest Park
  - a. 2111 Sulphur Ave. St. Louis, MO 63139
12. Pear Tree Inn – St. Louis Airport
  - a. 10810 Pear Tree Lane, St. Louis, MO 63074
13. Drury Inn & Suites – Westport
  - a. 12220 Dorsett Road, Maryland Heights, MO 63043
14. Pear Tree Inn-Arnold

- a. 1201 Drury Lane, Arnold, MO 63010
- 15. Drury Inn & Suites – Arnold
  - a. 3800 State Route 141, Arnold, MO 63010
- 16. Drury Inn & Suites – Kansas City Stadium
  - a. 3830 Blue Ridge Cutoff, Kansas City, MO 64133
- 17. Drury Inn & Suites – Joplin
  - a. 3601 Range Line Road, Joplin, MO 64804
- 18. Drury Inn & Suites – Sikeston
  - a. 2602 East Malone, Sikeston, MO 63801
- 19. Drury Inn & Suites – Independence
  - a. 20300 E. 42<sup>nd</sup> Street South, Blue Springs, MO 64015
- 20. Drury Inn – Bowling Green
  - a. 325 Scottsville Road, Bowling Green, KY 42104
- 21. Drury Inn – Marion
  - a. 2706 W. Deyoung, Marion, IL 62959
- 22. Drury Inn & Suites – Memphis South
  - a. 735 Goodman Road West, Horn Lake, MS 38637
- 23. Drury Inn & Suites – Nashville Airport
  - a. 555 Donelson Pike, Nashville, TN 37214
- 24. Drury Inn & Suites – Jackson
  - a. 610 County Line Road, Ridgeland, MS 39158
- 25. Drury Inn & Suites – Evansville East
  - a. 100 Cross Point Blvd., Evansville, IN 47711
- 26. Drury Inn & Suites – Findlay
  - a. 820 West Trenton, Findlay, OH 45840
- 27. Drury Inn & Suites – Memphis Northeast
  - a. 1556 Sycamore View Road, Memphis, TN 38134
- 28. Drury Inn & Suites – O'Fallon
  - a. 1118 Central Park Drive, O'Fallon, IL 62269
- 29. Drury Inn – Terre Haute
  - a. 3040 US Highway 41 South, Terre Haute, IN 47802
- 30. Drury Inn – Denver East
  - a. 4380 East Peoria Street, Denver, CO 80239

31. Drury Inn & Suites – Denver Near the Tech Center
  - a. 9445 E. Dry Creek Road, Centennial, CO 80112
32. Drury Inn – Pikes Peak
  - a. 8155 N. Academy Blvd., Colorado Springs, CO 80920
33. Drury Inn – Evansville North
  - a. 3901 North Highway 41, Evansville, IN 47711
34. Drury Inn & Suites – Indianapolis NE
  - a. 8180 Shadeland Blvd., Indianapolis, IN 46250
35. Drury Inn & Suites – Des Moines
  - a. 5505 Mills Civic Parkway, Des Moines, IA 50266
36. Drury Inn & Suites – Baton Rouge
  - a. 7939 Essen Park, Baton Rouge, LA 70809
37. Drury Inn – Troy
  - a. 575 W. Big Beaver Road, Troy, MI 48084
38. Drury Inn & Suites – Columbus South
  - a. 88 E. Nationwide Blvd., Grove City, OH 43123
39. Drury Inn & Suites – Montgomery
  - a. 1124 Eastern Blvd., Montgomery, AL 36117
40. Drury Inn & Suites – Birmingham SE
  - a. 3510 Grandview Parkway, Birmingham, AL 35243
41. Drury Inn & Suites – Birmingham SW
  - a. 160 State Farm Parkway, Birmingham, AL 35209
42. Drury Inn – Collinsville
  - a. 610 North Bluff Road, Collinsville, IL 62234
43. Drury Inn – Mount Vernon
  - a. 145 North 44<sup>th</sup> Street, Mt. Vernon, IL 62864
44. Drury Inn – Indianapolis
  - a. 9320 N. Michigan Road, Indianapolis, IN 46268
45. Drury Inn & Suites – Charlotte North
  - a. 415 West. W.T. Harris Blvd., Charlotte, NC 28262
46. Drury Inn & Suites – Dayton
  - a. 6616 Miller Lane, Dayton, OH 45414
47. Drury Inn & Suites – Greenville
  - a. 10 Carolina Point Parkway, Greenville, SC 29607

- 48. Drury Inn & Suites – Denver/ Stapleton
  - a. 4550 N. Central Park Blvd, Denver, CO 80238
- 49. Drury Inn & Suites – Denver/ Westminster
  - a. 10393 Reed Street, Westminster, Co 80021
- 50. Drury Plaza Hotel in Sante Fe
  - a. 228 East Palace Avenue, Santa Fe, NM 87501
- 51. Drury Inn & Suites – Mount Vernon
  - a. 145 North 44<sup>th</sup> Street, Mt. Vernon, IL 62864
- 52. Drury Inn & Suites – Brentwood
  - a. 8700 Eager Road, St. Louis, MO 63144
- 53. Drury Inn & Suites – Phoenix/Tempe
  - a. 1780 W. Ranch Road, Tempe, AZ 85284

ATTACHMENT A: VIOLATION HISTORY  
DRURY INN & SUITES – COLORADO SPRINGS

DR8404 Q #8: Has the applicant (including any of the partners, if a partnership; members or manager if a limited liability company; or officers, stockholders or directors if a corporation) or manager ever (in Colorado or any other state): (a) been denied an alcohol beverage license? (b) had an alcohol beverage license suspended or revoked? (c) had interest in another entity that had an alcohol beverage license suspended or revoked?

DR8404-I Q #9: Have you ever received a violation notice suspension or revocation, for a liquor law violation, or have you applied for or been denied a liquor or beer license anywhere in the U.S.?

1. DSW Inns, LLC d/b/a Drury Inn & Suites Memphis Northeast, 1556 Sycamore View Road, Memphis, TN 38134; 11/10/2011; Failure to properly and timely renew LBD permit by date due; penalty was fine of \$250.00; Fine paid 2/15/2012.
2. Drury Capital Corporation d/b/a Drury Inn-Terre Haute, 3040 US Hwy. 41 South, Terre Haute, IN 47802; 2/23/2011; Sale of Alcoholic Beverage to a Minor; penalty was fine of \$500.00; Fine paid 5/13/2011. Note: General Manager of Hotel also attended Vigo County Local Board meeting to explain steps taken to prevent any future violations of this nature.
3. DDC Hotels, Inc. d/b/a Drury Inn & Suites-Findlay, 820 West Trenton Avenue, Findlay, OH 45840; 6/11/2011; Giving away alcoholic beverages in connection with operation of a business (alcohol is complimentary at our evening 5:30 Kickback – however, cost of alcohol is built into room rate); Pending hearing.
4. Drury Development Corporation d/b/a Drury Inn & Suites – Nashville Airport, 555 Donelson Pike, Nashville, TN 37214; 3/16/2011; Failure to properly and timely renew LBD permit by date due; After review Consent order was downgraded to a warning and no fine was charged.
5. Drury Development Corporation d/b/a Drury Inn & Suites – Nashville Airport, 555 Donelson Pike, Nashville, TN 37214; 10/02/2009; Failure to properly display permit in a conspicuous place; penalty was fine of \$100.00; fine paid 10/07/2009.
6. Drury Development Corporation d/b/a Drury Inn & Suites – O'Fallon, 1118 Central Park Drive, O'Fallon, IL 62269; 7/27/2009; Improper transfer of liquor; penalty was fine of \$500.00; fine paid 2/18/2010.
7. Drury Hotels Company LLC d/b/a Drury Inn & Suites – Kansas City/ Independence, 20300 East 42<sup>nd</sup> Street South, Independence, MO 64015; 07/21/2014; Unlawful sale to a minor; penalty was fine of \$200; Fine paid 2/13/2015

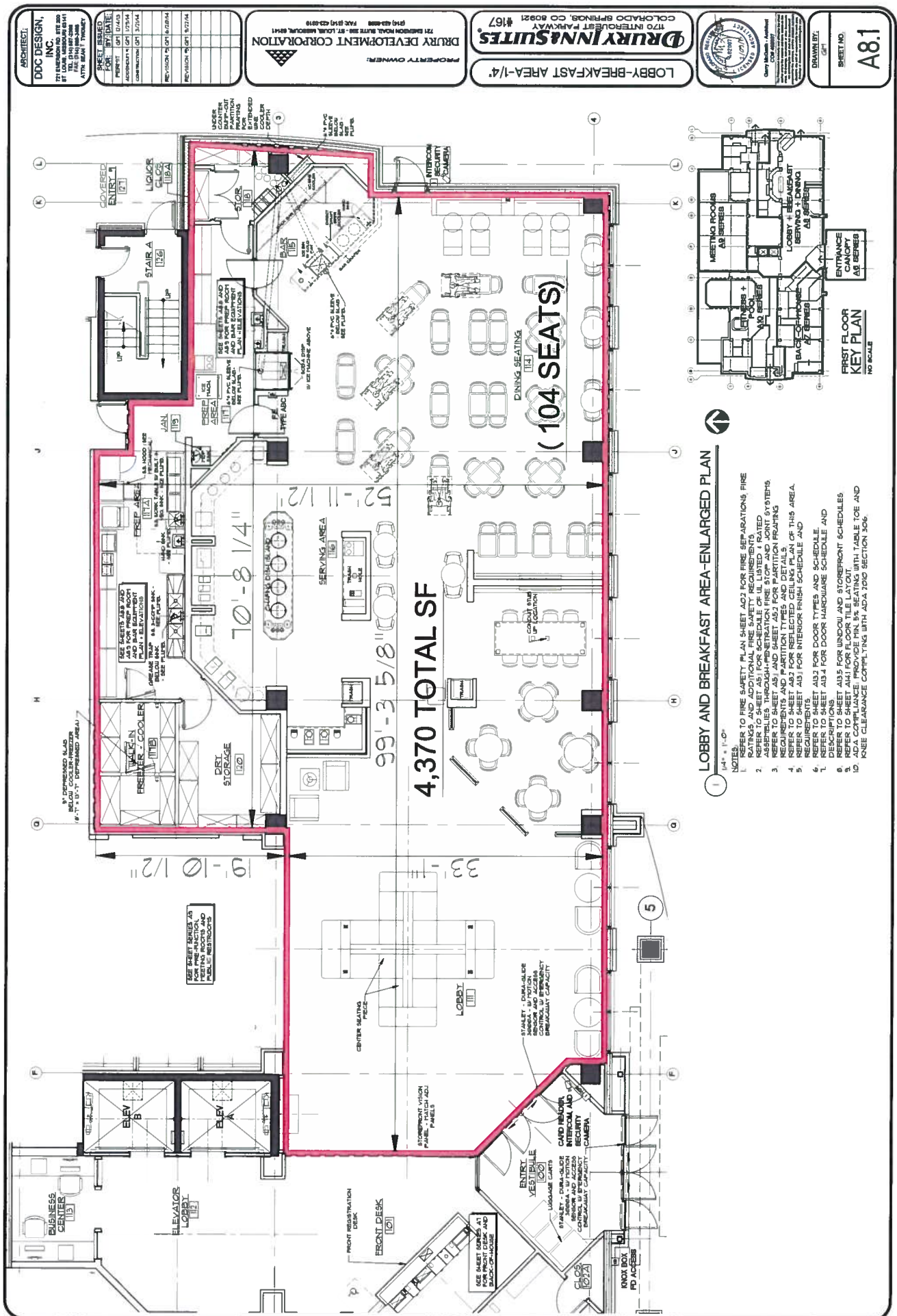



April 10, 2015

**Certified Mail # 7011 1150 0000 0281 9880**

Drury Colorado Springs, LLC  
& Drury Hotels CO, LLC  
dba Drury Inn & Suites – Colorado Springs  
721 Emerson Road, #400  
St. Louis, MO 63141

Dear Applicant:

Pursuant to 12-47-312 of the Colorado Revised Statutes and Rule No. 7 of the Local Rules of Procedure, I have the following report to make concerning the results of my investigation of the application you have filed for a new Tavern Liquor License, at Drury Colorado Springs, LLC & Drury Hotels CO, LLC dba Drury Inn & Suites – Colorado Springs, 1170 Interquest Parkway, Colorado Springs, Colorado. Your application was filed on March 18, 2015 and within a two (2) year period prior to this date, the Local Licensing Authority has not denied an application at said location for the reason that the reasonable requirements of the neighborhood were satisfied by existing outlets.

It appears that you will be entitled to possession of the premises for which the application is made.

At this time, the premises you desire to license does not appear to be in violation of any Zoning Ordinances of the City of Colorado Springs, Colorado.

There are no schools within the limits as prohibited by law.

To date, the Police Department has not reported any objections to this application.

Pursuant to Rule 6.01 neighborhood boundaries have been established and a map has been enclosed for your convenience.

North:	South side of Ridgeline Drive extended
South:	North side of Federal Drive extended
East:	West side of Wildwood Pass Drive extended
West:	East side of Interstate 25 extended

Within the established neighborhood boundary of the proposed establishment, there are four (4) existing licenses of a similar type as listed below.

A public hearing will be held on your application at the meeting of the Liquor and Beer Licensing Board, commencing at 9:00 a.m., May 1, 2015 in the Council Chambers, City Hall, 107 North Nevada Avenue, and you must be present at that meeting. At this meeting the Board will consider the factors outlined in Rule No 9.08 of the Local Rules of Procedure and it is your burden to provide the necessary evidence to satisfy the Board.

A public notice poster has been prepared for you to pick up from the City Clerk's Office. This notice poster must be posted by you at the proposed premises in a manner that is visible and conspicuous to the public no later than Tuesday, April 21, 2015.

If you have any questions please contact Lee McRae at (719) 385-5106.

Sincerely,



Sarah B. Johnson  
City Clerk

### **HOTEL AND RESTAURANT/BREW PUB LIQUOR LICENSES**

- |                                 |                             |
|---------------------------------|-----------------------------|
| 1. Colorado Mountain Brewery    | 11202 Rampart Hills Parkway |
| 2. Cheddars Casual Café         | 1140 Interquest Parkway     |
| 3. Brunswick Zone XL Interquest | 1180 Interquest Parkway     |
| 4. Residence Inn                | 9805 Federal Boulevard      |

### **TAVERN LIQUOR LICENSES**

### **BEER AND WINE LICENSES**

# Liquor Survey Boundaries

DRURY COLORADO SPRINGS, LLC & DRURY HOTELS CO. LLC  
D/b/a DRURY INN & SUITES - COLORADO SPRINGS  
1170 INTERQUEST PKWY



LIID: 29002



North: South side of Ridgeline Dr extended  
(0.662 miles)

South: North side of Federal Dr extended  
(0.622 miles)

East: West side of Wildwood Pass Dr extended  
(0.669 miles)

West: East side of Interstate 25 extended  
(0.535 miles)

Map prepared 3/23/2015 7:04:45 AM

Copyright © 2015 City of Colorado Springs on behalf of the Colorado Springs Utilities. All rights reserved. This work, and/or the data contained herein, may not be modified, republished, used to prepare derivative works or commercially exploited in any manner without the prior express written consent of the City of Colorado Springs. This work was prepared utilizing the best data available at the time creation. Neither the City of Colorado Springs, the Colorado Springs Utilities, nor any of their employees makes any warranty, express or implied, or assumes any legal liability or responsibility for accuracy, completeness, or usefulness of any data contained herein. The City of Colorado Springs, Colorado Springs Utilities and their employees explicitly disclaim any responsibility for the data contained herein.