

CITY OF COLORADO SPRINGS LIQUOR OR 3.2% FERMENTED MALT BEVERAGE APPLICATION

☒ **NEW LICENSE** ☐ **TRANSFER OF OWNERSHIP**

Type of License applying for (Check One)

- | | | | | |
|-------------------------------------------------------------|----------------------------------------------------------------------|--------------------------------------------------------|---------------------------------------------------------------|------------------------------------------|
| <input checked="" type="checkbox"/> Hotel/Restaurant | <input type="checkbox"/> Hotel/Restaurant w/Optional Premises | <input type="checkbox"/> Tavern | <input type="checkbox"/> Beer & Wine | <input type="checkbox"/> Brew Pub |
| <input type="checkbox"/> Retail Liquor Store | <input type="checkbox"/> 3.2% Beer On Premises | <input type="checkbox"/> 3.2% Beer Off Premises | <input type="checkbox"/> 3.2% Beer On and Off Premises | |
| <input type="checkbox"/> Drugstore | <input type="checkbox"/> Racetrack | <input type="checkbox"/> Optional Premises | <input type="checkbox"/> Club | <input type="checkbox"/> Vinters |

APPLICANT INFORMATION

| | |
|------------------------------------------------------------------------------------------|-----------------------------------------------------------------------|
| Name of Applicant: SHAE'S, LLC | Property Tax Schedule No. : 7411232039 |
| Trade Name (DBA): SHAE'S | Business Telephone: Not yet set-up |
| Address of Premises: 2521 West Colorado Ave., #101, Colorado Springs, CO 80904 | Alternate Telephone: 719-229-3621 (Ashley Harter cellphone) |

IF THIS IS A TRANSFER OF AN EXISTING LICENSE – THE FOLLOWING MUST BE ANSWERED:

| Present trade name of establishment (dba) | Present State License No. | Present Class of License | Present Expiration Date |
|-------------------------------------------|---------------------------|--------------------------|-------------------------|
| N/A | N/A | N/A | N/A |

If the applicant is: a Corporation, Limited Liability Company, Partnership or Association, list all officers, directors, general partners and managing members, position held and percentage owned.

| NAME | POSITION HELD | %OWNED |
|---------------|---------------------|--------|
| Ashley Harter | Sole Member/Manager | 100 |
| | | |
| | | |
| | | |
| | | |

FINANCIAL INFORMATION

| | |
|----------------------------------------------------------------------|----------|
| TOTAL INVESTMENT IN BUSINESS (include purchase, start up, inventory) | \$70,000 |
|----------------------------------------------------------------------|----------|

Source(s) of funds invested (provide names, banks, and indicate checking, savings, loan, promissory note, gift or other).

THE FOLLOWING INFORMATION MUST REFLECT THE SOLE SOURCE OF FUNDS INVESTED. NO OTHER PERSON OR PARTIES MAY HAVE A FINANCIAL INTEREST IN THE BUSINESS FOR WHICH THIS AFFIDAVIT IS SUBMITTED.

| NAME/ADDRESS OF FUNDING SOURCE (bank(s), individual(s), et al.) | TYPE OF FUNDING SOURCE (checking, savings, loan, note, gift) | AMOUNT |
|--------------------------------------------------------------------|-----------------------------------------------------------------|----------|
| J.P. Morgan Chase | Checking | \$55,000 |
| 1783 Cheyenne Mtn Blvd., Colorado Springs, CO 80906 | | |
| Penny Hopley | Gift | \$15,000 |
| 5251 SE Cheyenne Tr., Lathrop, MO 64465 | | |
| | | |
| | | |

List applicant(s) prior experience in the sale of alcoholic beverages. Include dates and locations.

| Business Name & Address | Applicant's Name | Experience/Position | Dates |
|------------------------------------------|------------------|---------------------|-------------|
| Thunder & Buttons II | Ashley Harter | Bartender/Asst. Mgr | 2010 - 2014 |
| 2415 W. Colorado Ave., C/S CO 80904 | | | |
| Meadow Muffins | Ashley Harter | Bartender/Asst. Mgr | 2007-2010 |
| 2432 W. Colorado Ave., C/S CO 80904 | | | |
| The Hatch Cover | Ashley Harter | Bartender/Server | 2004-2007 |
| 252 E. Cheyenne Mtn. Blvd., C/S CO 80906 | | | |

THESE FORMS SHOULD NOT BE ALTERED IN ANY MANNER

Has the applicant previously been issued a liquor or beer license (include any of the partners, if a partnership; members or manager if a limited liability company; or officers, stockholders or directors if a corporation)? ☐ yes ☒ no

If yes, identify the business and any current or former financial interest in said business including any loans to or from a licensee.

| Name of Business | Address | Type/amt. of Interest |
|------------------|---------|-----------------------|
| N/A | | |
| N/A | | |

PREMISES/ESTABLISHMENT

Terms of legal possession of the premises for which the application is made? ☐ own ☒ lease

If leased provide terms: Start date November 1, 2014 End date October 31, 2017

Dimensions of premises 15'3.5" X 90.85' Square footage Approx. 1685 sq. ft. Seating Capacity 45

Is there a patio area? ☒ yes ☐ no --- If yes, provide dimensions 25' X 12'

Anticipated number of employees? 5

Will training be offered or required? ☒ yes ☐ no --- If yes, through what agency? Liquor Licensing Professionals

| Has the applicant or manager in Colorado, or any other State (include any of the partners, if a partnership; members or manager if a limited liability company; or officers, stockholders or directors if a corporation), ever: | YES | NO |
|---------------------------------------------------------------------------------------------------------------------------------------------------------------------------------------------------------------------------------|-------------------------------------|-------------------------------------|
| Been denied an alcohol beverage license? | <input type="checkbox"/> | <input checked="" type="checkbox"/> |
| Had an alcohol beverage license suspended or revoked? | <input type="checkbox"/> | <input checked="" type="checkbox"/> |
| Had interest in another entity where an alcohol beverage license was suspended or revoked? | <input type="checkbox"/> | <input checked="" type="checkbox"/> |
| Ever been charged or convicted of a crime, received a suspended sentence, a deferred sentence, or have charges pending? | <input type="checkbox"/> | <input type="checkbox"/> |
| If yes, provide explanation, date(s) and location(s). | <input checked="" type="checkbox"/> | <input type="checkbox"/> |
| <u>DUI, 2004, Colorado Springs, CO. All sentencing conditions completed.</u> | | |
| | | |
| | | |

Has the applicant ever received a violation notice, suspension, or revocation for any liquor law violation, have charges pending; or has the applicant applied for and been denied a liquor or beer license anywhere in the United States?

Yes ☐ No ☒

If yes, provide explanation, date(s) and location(s):

I declare under the penalty of perjury in the second degree that this application and all attachments are true, correct, and complete to the best of my knowledge. I understand that any falsehood or omission will jeopardize the application as such falsehood or omission constitutes a crime regarding the character of the applicant.

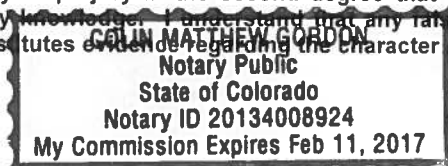

[Signature]
Signature
Title: Sole Member & Manager

State of COLORADO
County of EL PASO

Subscribed and sworn to before me this 12th day of December, 20 14.

My Commission Expires: 02/11/2017

[Signature]
Notary Public

THESE FORMS SHOULD NOT BE ALTERED IN ANY MANNER

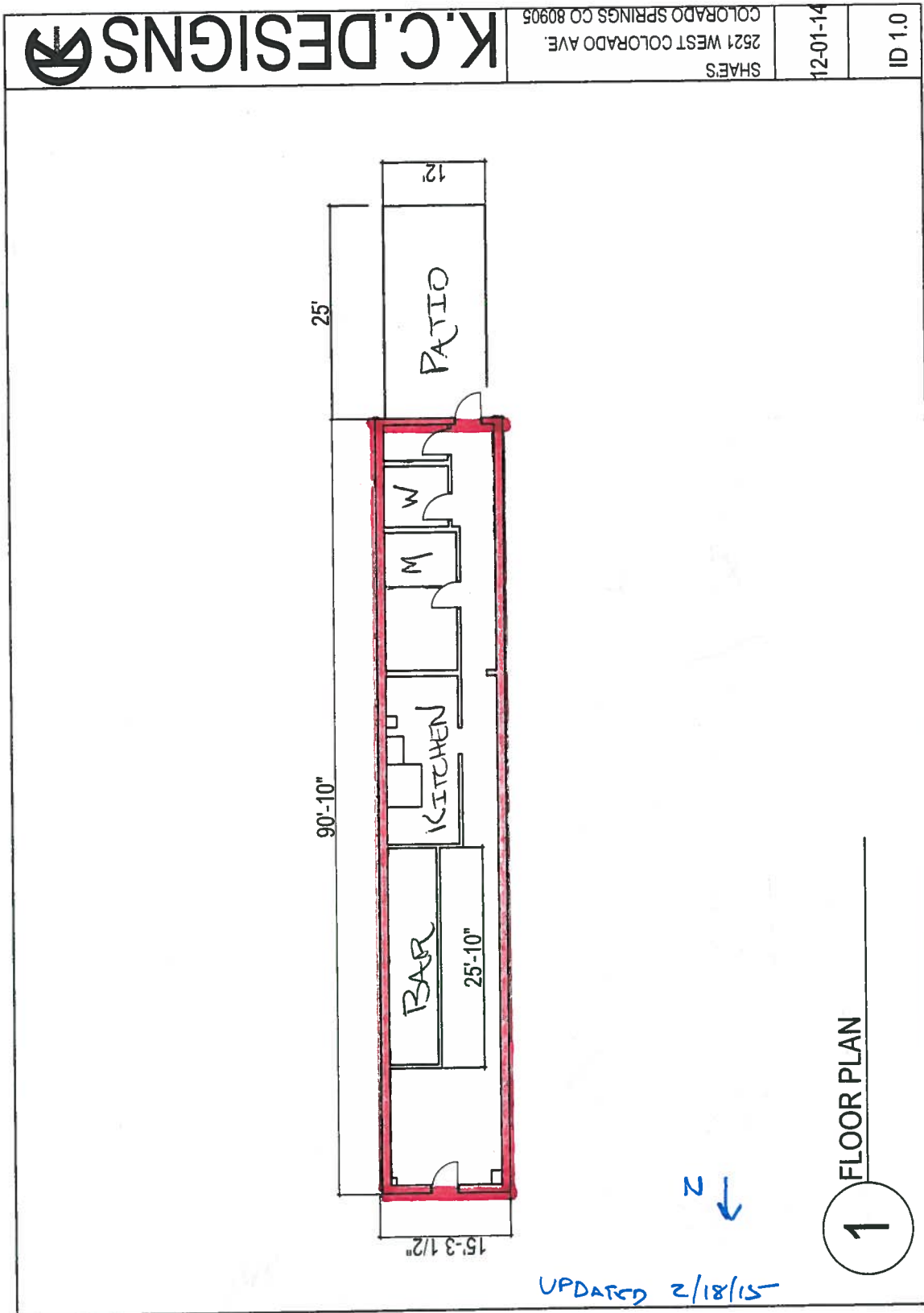



February 12, 2015

Certified Mail # 7014 0150 0000 9222 2447

Shae's, LLC
dba Shae's
1316 Florence Avenue
Colorado Springs, CO 80905

Dear Applicant:

Pursuant to 12-47-312 of the Colorado Revised Statutes and Rule No. 7 of the Local Rules of Procedure, I have the following report to make concerning the results of my investigation of the application you have filed for a new Hotel and Restaurant Liquor License, at Shae's, LLC, dba Shae's, LLC, 2521 W. Colorado Avenue, #101, Colorado Springs, Colorado. Your application was filed on December 22, 2014 and within a two (2) year period prior to this date, the Local Licensing Authority has not denied an application at said location for the reason that the reasonable requirements of the neighborhood were satisfied by existing outlets.

It appears that you will be entitled to possession of the premises for which the application is made.

At this time, the premises you desire to license does not appear to be in violation of any Zoning Ordinances of the City of Colorado Springs, Colorado, except for the declared patio area. **No outdoor seating or patio is permitted until a development plan is submitted and approved.**

There are no schools within the limits as prohibited by law.

To date, the Police Department has not reported any objections to this application.

Pursuant to Rule 6.01 neighborhood boundaries have been established and a map has been enclosed for your convenience.

| | |
|--------|------------------------------------------------|
| North: | South side of King Street extended |
| South: | North side of 19 th Street extended |
| East: | West side of 21 st Street extended |
| West: | East side of 32 nd Street extended |

Within the established neighborhood boundary of the proposed establishment, there are twenty-one (21) existing licenses of a similar type as listed below.

A public hearing will be held on your application at the meeting of the Liquor and Beer Licensing Board, commencing at 9:00 a.m., March 6, 2015 in the Council Chambers, City Hall, 107 North Nevada Avenue, and you must be present at that meeting. At this meeting the Board will consider the factors outlined in Rule No 9.08 of the Local Rules of Procedure and it is your burden to provide the necessary evidence to satisfy the Board.

A public notice poster has been prepared for you to pick up from the City Clerk's Office. This notice poster must be posted by you at the proposed premises in a manner that is visible and conspicuous to the public no later than Tuesday, February 24, 2015.

If you have any questions please contact Lee McRae at (719) 385-5106.

Sincerely,



Sarah B. Johnson
City Clerk

HOTEL AND RESTAURANT/BREW PUB LIQUOR LICENSES

| | |
|---------------------------------------------|--------------------------------|
| 1. The Mason Jar | 2925 W. Colorado Avenue |
| 2. Paravicini Italian Bistro | 2802 W. Colorado Avenue |
| 3. Alchemy | 2625 W. Colorado Avenue |
| 4. Jake and Telly's Greek Cuisine | 2616 W. Colorado Avenue |
| 5. Tapateria | 2607 W. Colorado Avenue |
| 6. Bon Ton's Cafe | 2601 W. Colorado Avenue |
| 7. Pizzeria Rustica | 2525 W. Colorado Avenue |
| 8. Garden of the Gods Gourmet Market & Café | 410 S. 26 th Street |
| 9. Dat's Italian | 2514 W. Colorado Avenue, #102 |
| 10. 2 South | 2n S. 25 th Street |
| 11. Mother Muff's | 2432 W. Colorado Avenue |
| 12. Jorge's | 2427 W. Colorado Avenue |
| 13. La Baguette | 2417 W. Colorado Avenue |
| 14. Thunder & Buttons II | 2415 W. Colorado Avenue |
| 15. Front Range Barbeque Inc | 2330 W. Colorado Avenue |
| 16. Mountain Shadows Restaurant | 2223 W. Colorado Avenue |
| 17. Colorado Mountain Brewery | 600 S. 21 st Street |

TAVERN LIQUOR LICENSES

| | |
|---------------------------|-----------------------------------|
| 18. Motif | 115 South 25 th Street |
| 19. Cucuru | 2332 W. Colorado Avenue |
| 20. Thirsty's Tavern | 2028 Sheldon Avenue |
| 21. Secret Garden Nursery | 420 S. 19 th Street |

Liquor Survey Boundaries

SHAE'S, LLC
D/b/a SHAE'S
2521 W COLORADO AVE #101

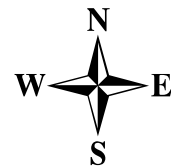

LIID: 28767



North: South side of King St extended
(0.539 miles)

South: North side of 19th St extended
(0.524 miles)

East: West side of 21st St extended
(0.546 miles)

West: East side of 32nd St extended
(0.608 miles)

Map prepared 12/31/2014 9:34:20 AM

Copyright © 2014 City of Colorado Springs on behalf of the Colorado Springs Utilities. All rights reserved. This work, and/or the data contained herein, may not be modified, republished, used to prepare derivative works or commercially exploited in any manner without the prior express written consent of the City of Colorado Springs. This work was prepared utilizing the best data available at the time creation. Neither the City of Colorado Springs, the Colorado Springs Utilities, nor any of their employees makes any warranty, express or implied, or assumes any legal liability or responsibility for accuracy, completeness, or usefulness of any data contained herein. The City of Colorado Springs, Colorado Springs Utilities and their employees explicitly disclaim any responsibility for the data contained herein.