

ANNEXATION PLAT - EXTOL PARK VISTA ADDITION NO. 2
ZONE CHANGE LEGAL DESCRIPTION

EXHIBIT "A"

PROPERTY DESCRIPTION: 4401, 4405, 4409 and 4413 Siferd Boulevard

A tract of land being a portion of the Northwest Quarter of Section 26, Township 13 South, Range 66 West of the 6th P.M., situate in El Paso County, Colorado, described as follows:

Lots 12, 13, 14 and 15, Block Thirteen, PARK VISTA ADDITION (Plat Book W, Page 69, El Paso County, Colorado records);

Containing 0.659 acres (28,714 square feet), more or less

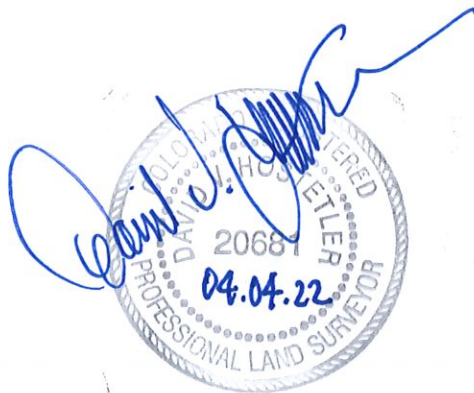

CITY FILE NO. ZONE-23-0001

Sheet 1 of 2

ANNEXATION PLAT - EXTOL PARK VISTA ADDITION NO. 2 - ZONE CHANGE EXHIBIT ... EXHIBIT "B"

DATE STREET
(60' PUBLIC R.O.W.)
(PLAT BOOK W, PAGE 69)

Lot 2
EXTOL PARK VISTA
SUBDIVISION NO. 1
Lot 3 (Reception No.
223715097)
CITY "R-5 AO" ZONE
Lot 4
S89°51'10"W 120.00'

Lot 5
63261-01-056
Lot 4
63261-01-055

63262-03-039
Portion of Lot 35
Block Three
PARK VISTA
ADDITION
Plat Book W, Page
69) COUNTY
"RM-30"
ZONE

SIFERD BOULEVARD
(PUBLIC R.O.W. WIDTH VARIES)
(PLAT BOOK W, PAGE 69)

Tract A
S00°08'50"E 220.00'
Lot 12
63262-01-012
120.00'
Lot 13
63262-01-013
COUNTY "RM-30" ZONE
120.00'
Block Thirteen
PARK VISTA ADDITION
(Plat Book W, Page 69)
Lot 14
63262-01-014
120.00'
Lot 15
63262-01-015

INDICATES EL PASO
COUNTY ASSESSOR
PARCEL NUMBER
Lot 3
63261-01-054
LARSON ADDITION
(Plat Book N-2, Page 20)
Lot 2
63261-01-053
Lot 1
63261-01-052
CITY "R1-6 AO"
ZONE
Block 1
DOHERTY VILLAGE
(Plat Book G-3, Page 20)

Lot 36
63262-03-036
Lots 1 and 2
63262-03-037

N00°08'50"W 240.00'
12' PUBLIC UTILITY
EASEMENT (PLATTED)

Δ=90°00'00"
R=20.00'
L=31.42'
PARK VISTA
ADDITION NO. 10
(Recording
Pending)

N89°51'10"E 100.00'
(60' PUBLIC R.O.W.)
PARK VISTA ADDITION
NO. 9
(Reception No.
222714924)

HOPEFUL DRIVE
(70' PUBLIC R.O.W.)
(PLAT BOOK G-3, PAGE 20)



SCALE: 1" = 50'

TO ROSALE
STREET

SITE DATA:
EXISTING ZONING: "RM-30" (Residential
Multi-Dwelling (30du/ac))
PROPOSED ZONING: CITY "R-5 AO"
(Multi-Family Residential w/Airport Overlay)
AREA = 0.659 ACRES

CITY FILE NO. ZONE-23-0001



PLANNING · SURVEYING

www.ldc-inc.com · TEL: (719) 528-6133 · FAX: (719) 528-6848
3898 MAIZELAND ROAD · COLORADO SPRINGS, CO 80909

F:\21000\21017 - Extol Park Vista\Surveying\Exhibit\21017 EPV2 ZONE CHANGE EXHIBIT.dwg