

## Permit Application and Report of Changes

**All Answers Must Be Printed in Black Ink or Typewritten**

1. Applicant is a <input type="checkbox"/> Corporation..... <input type="checkbox"/> Individual <input type="checkbox"/> Partnership ..... <input checked="" type="checkbox"/> Limited Liability Company		License Number <b>944737-006-LQE</b>							
2. Name of Licensee <b>Trolley Holding, LLC</b>		3. Trade Name of Establishment (DBA) <b>Pikes Peak Brewing Co., COATI</b>							
4. Address of Premises (specify exact location of premises) <b>514 S. Tejon St.</b>		5. Business Email Address <b>info@pikespeakbrewing.com</b>							
City <b>Colorado Springs</b>	County <b>El Paso</b>	State <b>CO</b>	ZIP <b>80903</b>						
		Business Phone Number <b>719-208-4098</b>							
<b>SELECT THE APPROPRIATE SECTION BELOW AND PROCEED TO THE INSTRUCTIONS ON PAGE 2.</b>									
<b>Section A – Manager Reg/Change</b>		<b>Section C</b>							
<input type="checkbox"/> Manager's Registration (Hotel & Restr.) ..... \$30.00  <input type="checkbox"/> Manager's Registration (Tavern) ..... \$30.00  <input type="checkbox"/> Manager's Registration (Lodging & Entertainment) ..... \$30.00  <input type="checkbox"/> Change of Manager (Other Licenses pursuant to section 44-3-301(8), C.R.S.) NO FEE  <i>Please note that Manager's Registration for Hotel &amp;                  Restaurant, Lodging &amp; Entertainment, and Tavern licenses                  requires a local fee with submission to the local licensing                  authority as well. Please reach out to local licensing                  authorities directly regarding local processing and fees.</i>		<input type="checkbox"/> Retail Warehouse Storage Permit (ea) ..... \$100.00  <input type="checkbox"/> Wholesale Branch House Permit (ea)..... \$100.00  <input type="checkbox"/> Change Corp. or Trade Name Permit (ea) ..... \$50.00  <input type="checkbox"/> Change Location Permit (ea) ..... \$150.00  <input type="checkbox"/> Winery/Limited Winery Noncontiguous or Primary Manufacturing Location Change..... \$150.00  <input checked="" type="checkbox"/> Change, Alter or Modify Premises <table style="width: 100%; border: none;"> <tr> <td style="border: 1px solid black; width: 50%; padding: 2px;">\$150.00 x</td> <td style="border: 1px solid black; width: 50%; padding: 2px;">Total Fee: 150.00</td> </tr> </table> <input type="checkbox"/> Addition of Optional Premises to Existing H/R <table style="width: 100%; border: none;"> <tr> <td style="border: 1px solid black; width: 50%; padding: 2px;">\$100.00 x</td> <td style="border: 1px solid black; width: 50%; padding: 2px;">Total Fee:</td> </tr> </table> <input type="checkbox"/> Addition of Related Facility to an Existing Resort or Campus Liquor Complex <table style="width: 100%; border: none;"> <tr> <td style="border: 1px solid black; width: 50%; padding: 2px;">\$160.00 x</td> <td style="border: 1px solid black; width: 50%; padding: 2px;">Total Fee:</td> </tr> </table> <input type="checkbox"/> Campus Liquor Complex Designation ..... No Fee  <input type="checkbox"/> Sidewalk Service Area ..... \$75.00		\$150.00 x	Total Fee: 150.00	\$100.00 x	Total Fee:	\$160.00 x	Total Fee:
\$150.00 x	Total Fee: 150.00								
\$100.00 x	Total Fee:								
\$160.00 x	Total Fee:								
<b>Section B – Duplicate License</b>									
<input type="checkbox"/> Duplicate License ..... \$50.00									

<b>Do Not Write in This Space – For Department of Revenue Use Only</b>			
Date License Issued	License Account Number	Period	
The State may convert your check to a one time electronic banking transaction. Your bank account may be debited as early as the same day received by the State. If converted, your check will not be returned. If your check is rejected due to insufficient or uncollected funds, the Department of Revenue may collect the payment amount directly from your bank account electronically.		<b>TOTAL AMOUNT DUE</b>	<b>\$ .00</b>

## Instruction Sheet

**For All Sections, Complete Questions 1-5 Located on Page 1**

☐ **Section A**

**To Register or Change Managers**, check the appropriate box in section A and complete question 9 on page 4. Proceed to the Oath of Applicant for signature. Submit to State Licensing Authority for approval.

☐ **Section B**

**For a Duplicate license**, be sure to include the liquor license number in section B on page 1 and proceed to page 5 for Oath of Applicant signature.

☒ **Section C**

Check the appropriate box in section C and proceed below.

- 1) **For a Retail Warehouse Storage Permit**, go to page 3 complete question 5 (be sure to check the appropriate box). Submit the necessary information and proceed to page 5 for Oath of Applicant signature. Submit to State Licensing Authority for approval.
- 2) **For a Wholesale Branch House Permit**, go to page 3 and complete question 5 (be sure to check the appropriate box). Submit the necessary information and proceed to page 5 for Oath of Applicant signature. Submit to State Licensing Authority for approval.
- 3) **To Change Trade Name or Corporation Name**, go to page 3 and complete question 6 (be sure to check the appropriate box). Submit the necessary information and proceed to page 5 for Oath of Applicant signature. Retail Liquor License submit to Local Liquor Licensing Authority (City or County). Manufacturer, Wholesaler and Importer's Liquor Licenses submit to State Liquor Licensing Authority.
- 4) **To modify Premise, or add Sidewalk Service Area**, go to page 4 and complete question 10. Submit the necessary information and proceed to page 5 for Oath of Applicant signature. Retail Liquor License submit to Local Liquor Licensing Authority (City or County). Manufacturer, Wholesaler and Importer's Liquor Licenses submit to State Liquor Licensing Authority.
- 5) **For Optional Premises** go to page 4 and complete question 10. Submit the necessary information and proceed to page 5 for Oath of Applicant signature. Retail Liquor License submit to Local Liquor Licensing Authority (City or County).
- 6) **To Change Location**, go to page 3 and complete question 7. Submit the necessary information and proceed to page 5 for Oath of Applicant signature. Retail Liquor License submit to Local Liquor Licensing Authority (City or County). Manufacturer, Wholesaler and Importer's Liquor Licenses submit to State Liquor Licensing Authority.
- 7) **Winery/Limited Winery Noncontiguous or Primary Manufacturing Location Change**, go to page 4, and complete question 8. Use this section to make a current Noncontiguous Manufacturing Location into a Primary Manufacturing Location, or a Primary Manufacturing Location into a Noncontiguous Manufacturing Location. To be eligible for a Winery/Limited Winery Noncontiguous or Primary Manufacturing Location Change, you must be a Colorado state licensed manufacturer of vinous liquor pursuant to section 44-3-402 or 44-3-403, C.R.S.
- 8) **Campus Liquor Complex Designation**, go to page 5 and complete question 11. Submit the necessary information and proceed to page 5 for Oath of Applicant signature.
- 9) **To add another Related Facility** to an existing Resort or Campus Liquor Complex, go to page 5 and complete question 12.

<b>Storage Permit</b>	<p><b>5. Retail Warehouse Storage Permit or a Wholesalers Branch House Permit</b></p> <p><input type="checkbox"/> <b>Retail Warehouse Permit for:</b></p> <p style="margin-left: 20px;"><input type="checkbox"/> On-Premises Licensee (Taverns, Restaurants etc.)</p> <p style="margin-left: 20px;"><input type="checkbox"/> Off-Premises Licensee (Liquor stores)</p> <p><input type="checkbox"/> <b>Wholesalers Branch House Permit</b></p> <p>Address of storage premise: _____</p> <p>City _____, County _____ ZIP _____</p> <p>Attach a deed/lease or rental agreement for the storage premises.</p> <p>Attach a detailed diagram of the storage premises.</p>				
<b>Change Trade Name or Corporate Name</b>	<p><b>6. Change of Trade Name or Corporation Name</b></p> <p><input type="checkbox"/> Change of Trade name/DBA only</p> <p><input type="checkbox"/> Corporate Name Change (Attach the following supporting documents)</p> <p style="margin-left: 20px;">1. Certificate of Amendment filed with the Secretary of State, or</p> <p style="margin-left: 20px;">2. Statement of Change filed with the Secretary of State, <u>and</u></p> <p style="margin-left: 20px;">3. Minutes of Corporate meeting, Limited Liability Members meeting, Partnership agreement.</p> <table border="1" style="width: 100%; border-collapse: collapse; margin-top: 5px;"> <tr> <td style="width: 50%; padding: 2px;">Old Trade Name</td><td style="width: 50%; padding: 2px;">New Trade Name</td></tr> <tr> <td style="padding: 2px;">Old Corporate Name</td><td style="padding: 2px;">New Corporate Name</td></tr> </table>	Old Trade Name	New Trade Name	Old Corporate Name	New Corporate Name
Old Trade Name	New Trade Name				
Old Corporate Name	New Corporate Name				
<b>Change of Location</b>	<p><b>7. Change of Location</b></p> <p><b>NOTE TO RETAIL LICENSEES:</b> An application to change location has a local application fee of \$750 payable to your local licensing authority. You may only change location within the same jurisdiction as the original license that was issued. Pursuant to 44-3-311(1) C.R.S. Your application must be on file with the local authority thirty (30) days before a public hearing can be held.</p> <p><b>Date filed with Local Authority</b> _____ <b>Date of Hearing</b> _____</p> <p>(a) Address of current premises _____</p> <p style="margin-left: 20px;">City _____ County _____ ZIP _____</p> <p>(b) Address of proposed New Premises (Attach copy of the deed or lease that establishes possession of the premises by the licensee)</p> <p style="margin-left: 20px;">Address _____</p> <p style="margin-left: 20px;">City _____ County _____ ZIP _____</p> <p>(c) New mailing address if applicable.</p> <p style="margin-left: 20px;">Address _____</p> <p style="margin-left: 20px;">City _____ County _____ State _____ ZIP _____</p> <p>(d) Attach detailed diagram of the premises showing where the alcohol beverages will be stored, served, possessed or consumed. Include kitchen area(s) for hotel and restaurants.</p>				

Winery/Limited Winery Noncontiguous or Primary Manufacturing Location Change	<p><b>8. Winery/Limited Winery Noncontiguous or Primary Manufacturing Location Change</b></p> <p>Select the option that applies to your situation:</p> <p><input type="checkbox"/> Make a current Primary Manufacturing Location (Location 1) into a Noncontiguous Location (Location 2); or</p> <p><input type="checkbox"/> Make a current Noncontiguous Manufacturing Location (Location 1) into a Primary Manufacturing Location (Location 2).</p> <p>(a) Address of Location 1: _____</p> <p>City _____ County _____ ZIP _____</p> <p>(b) Address of Location 2: _____</p> <p>City _____ County _____ ZIP _____</p>
Change of Manager	<p><b>9. Change of Manager or to Register the Manager of a Tavern, Hotel and Restaurant, Lodging &amp; Entertainment liquor license or licenses pursuant to section 44-3-301(8), C.R.S.</b></p> <p>(a) Change of Manager</p> <p>Former manager's name _____</p> <p>New manager's name _____</p> <p>(b) Date of Employment _____</p> <p>Has manager ever managed a liquor licensed establishment? ..... <input type="checkbox"/> Yes <input type="checkbox"/> No</p> <p>Does manager have a financial interest in any other liquor licensed establishment? ..... <input type="checkbox"/> Yes <input type="checkbox"/> No</p> <p>If yes, give name and location of establishment _____</p>
Modify Premises or Addition of Optional Premises, Related Facility, or Sidewalk Service Area	<p><b>10. Modification of Premises, Addition of an Optional Premises, Addition of Related Facility, or Addition of a Sidewalk Service Area</b></p> <p><b>NOTE:</b> Licensees may not modify or add to their licensed premises until approved by state and local authorities.</p> <p>(a) Describe change proposed <u>Modification of premise license to include alley directly behind property</u></p> <p>_____</p> <p>_____</p> <p>(b) If the modification is temporary, when will the proposed change:</p> <p>Start _____ (mo/day/year) End _____ (mo/day/year)</p> <p><b>NOTE: THE TOTAL STATE FEE FOR TEMPORARY MODIFICATION IS \$300.00</b></p> <p>(c) Will the proposed change result in the licensed premises now being located within 500 feet of any public or private school that meets compulsory education requirements of Colorado law, or the principal campus of any college, university or seminary?</p> <p>(If yes, explain in detail and describe any exemptions that apply) ..... <input type="checkbox"/> Yes <input checked="" type="checkbox"/> No</p> <p>(d) Is the proposed change in compliance with local building and zoning laws? ..... <input checked="" type="checkbox"/> Yes <input type="checkbox"/> No</p> <p>(e) If this modification is for an additional Hotel and Restaurant Optional Premises has the local authority authorized by resolution or ordinance the issuance of optional premises? ..... <input type="checkbox"/> Yes <input type="checkbox"/> No</p> <p>(f) Attach a diagram of the current licensed premises and a diagram of the proposed changes for the licensed premises.</p> <p>(g) Attach any existing lease that is revised due to the modification.</p> <p>(h) For the addition of a Sidewalk Service Area per Regulation 47-302(A)(4), 1 C.C.R. 203-2, include documentation received from the local governing body authorizing use of the sidewalk. Documentation may include but is not limited to a statement of use, permit, easement, or other legal permissions.</p>

<b>Campus Liquor Complex Designation</b>	<b>11. Campus Liquor Complex Designation</b> An institution of higher education or a person who contracts with the institution to provide food services (a) I wish to designate my existing _____ Liquor License # _____ to a Campus Liquor Complex ..... <input type="checkbox"/> Yes <input type="checkbox"/> No
<b>Additional Related Facility</b>	<b>12. Additional Related Facility</b> To add a Related Facility to an existing Resort or Campus Liquor Complex, include the name of the Related Facility and include the address and an outlined drawing of the Related Facility Premises. (a) Address of Related Facility _____ (b) Outlined diagram provided ..... <input type="checkbox"/> Yes <input type="checkbox"/> No

<b>Oath of Applicant</b>		
I declare under penalty of perjury in the second degree that I have read the foregoing application and all attachments thereto, and that all information therein is true, correct, and complete to the best of my knowledge		
Signature 	Print name and Title Christopher Wright, Managing Member	Date 7/22/2022
<b>Report and Approval of LOCAL Licensing Authority (CITY / COUNTY)</b>		
The foregoing application has been examined and the premises, business conducted and character of the applicant is satisfactory, and we do report that such permit, if granted, will comply with the applicable provisions of Title 44, Articles 4 and 3, C.R.S., as amended. <b>Therefore, This Application is Approved.</b>		
Local Licensing Authority (City or County)		Date filed with Local Authority
Signature	Title	Date
<b>Report of STATE Licensing Authority</b>		
The foregoing has been examined and complies with the filing requirements of Title 44, Article 3, C.R.S., as amended.		
Signature	Title	Date

Diagram of Brewery Premises  
 Applicant: Trolley Holding, LLC  
 1st Floor



Current Licensed Premise  
 Boundary  
 Proposed Modified Boundary  
 addition to current boundary



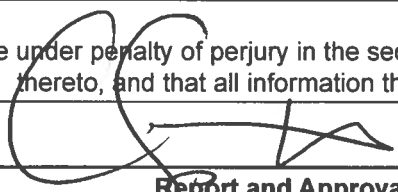
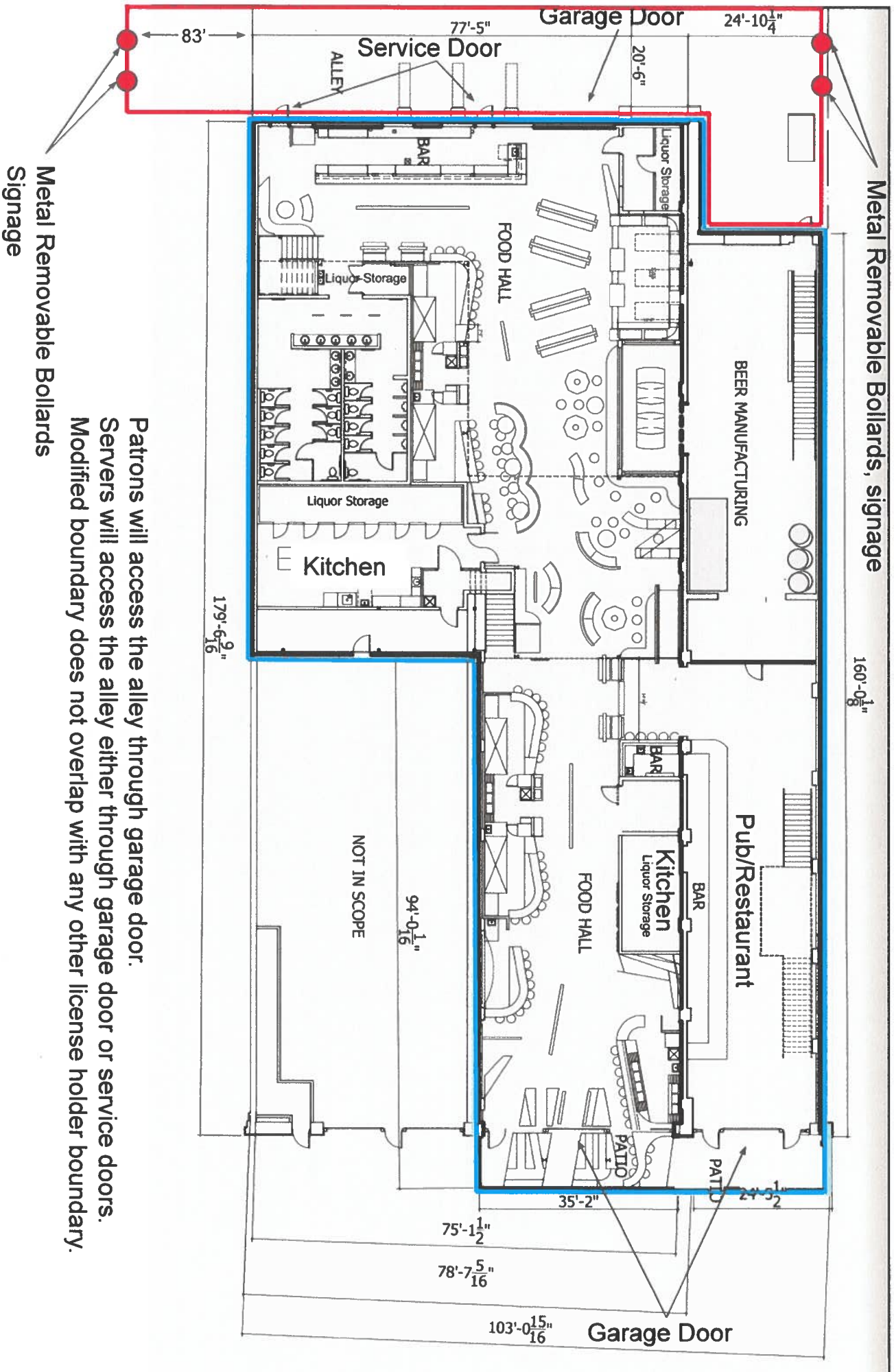
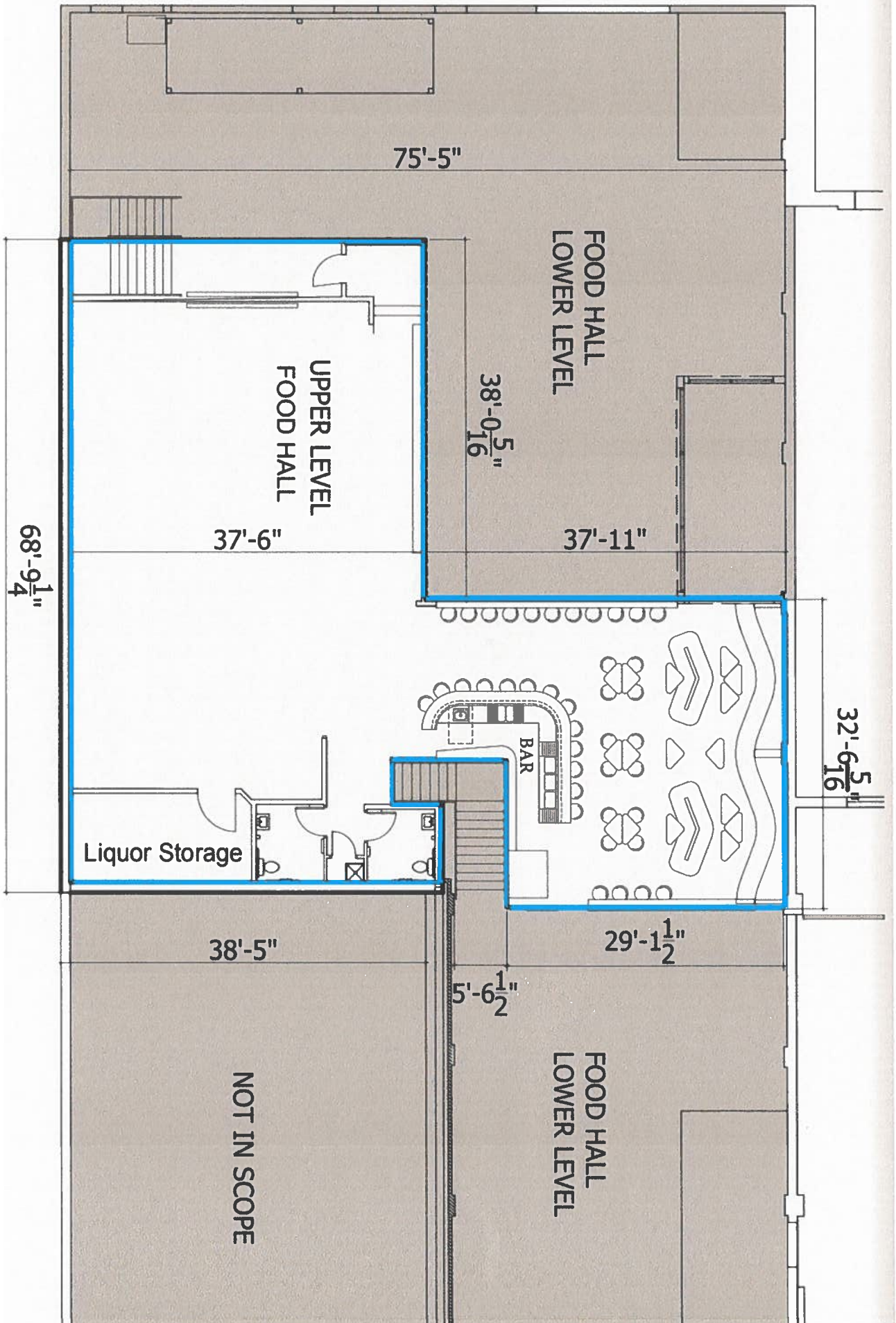

## Licensed Premise Boundary

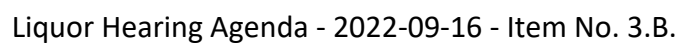



### Authorization of Use

In regards to the lease dated Jun 1, 2020 between 528 S. Tejon, LLC and Trolley Holding, LLC for the property located at 514 S. Tejon St., Colorado Springs, CO 80903 Suites 100,105, 110, 120, 140, 150 and 200. The landlord hereby authorizes Trolley Holding, LLC to utilize the alley behind the 514- 528 S. Tejon St. This is in order to secure a modification of licensed premise. Trolley Holding may activate this area starting at 5 pm daily and Saturday and Sunday during normal business hours.

IN WITNESS WHEREOF, the Landlord, and Tennant have executed this agreement on July 22, 2022.

LANDLORD:

528 S. Tejon, LLC  
A Colorado Limited Liability Company  
Company

By:   
Name: Joseph Niebur  
Title: Manager

TENNANT:

Trolley Holding, LLC  
A Colorado Limited Liability

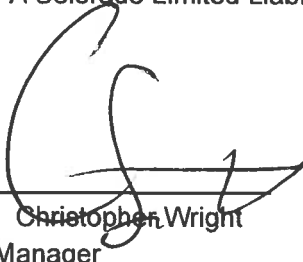
By:   
Name: Christopher Wright  
Title: Manager

**BEFORE THE LOCAL LIQUOR AND BEER  
LICENSING AUTHORITY,  
CITY OF COLORADO SPRINGS,  
STATE OF COLORADO**

Address: 30 South Nevada Avenue, Suite 101  
Colorado Springs, CO 80903  
Telephone: (719) 385-5901  
Fax Number: (719) 385-5114  
Email: cityclerk@coloradosprings.gov

CITY CLERK'S OFFICE  
2022 AUG 26 A 7:56

▲ CLERK USE ONLY ▲

**IN THE MATTER OF:**

**APPLICANT**

Trolley Holding, LLC  
d/b/a **Pikes Peak Brewing Co., COATI**  
514 S Tejon Street  
Colorado Springs, CO 80903  
Mailing Address:  
524 S Tejon Street  
Colorado Springs, CO 80903

Application No: M-0730985

**NOTICE OF HEARING AND INITIAL FINDINGS OF FACT**

**NOTICE OF HEARING**

This matter comes before the Local Licensing Authority Hearing Officer for hearing on **Friday, September 16, 2022 at 9:00 A.M. in Division 2, Municipal Court Building, 224 E. Kiowa Street, Colorado Springs, CO 80903** upon Trolley Holding, LLC d/b/a Pikes Peak Brewing Co., COATI ("Applicant") application for a Modification of Premises of the existing Brew Pub License at 514 S Tejon Street, Colorado Springs, CO 80903.

At this meeting, the Hearing Officer will consider the factors outlined in Rule No. 21.00 of the Liquor and Beer Rules and Regulations for the City of Colorado Springs ("City Rules"), and it is the Applicant's burden to provide the necessary evidence to satisfy the Local Licensing Authority.

A public notice poster has been prepared for the Applicant to pick up from the City Clerk's Office at 30 S. Nevada Avenue, Suite 101. This notice poster must be posted by the Applicant at the proposed premises in a manner that is visible and conspicuous to the public no later than Tuesday, September 6, 2022. Any applicable needs and desires petitions, remonstrances, and other reports or statements in writing must be filed with the City Clerk's Office by 12:00 P.M. on Tuesday, September 13, 2022.

Pursuant to C.R.S. §44-3-312 and City Rule No. 7, the Local Licensing Authority, through the Office of the City Clerk, has conducted an investigation into Applicant's application. NOW THEREFORE these Initial Findings of Fact are presented.

## INITIAL FINDINGS OF FACT

I. Applicant's application was filed on July 25, 2022, and within a two (2) year period prior to this date, the Local Licensing Authority has not denied an application at the above referenced location for the reason that the reasonable requirements of the neighborhood were satisfied by existing outlets, pursuant to C.R.S. §44-3-313(1)(a)(I) and City Rule 7.00(A)(1).

II. Applicant will be entitled to possession of the premises for which the application is made pursuant to a lease, rental agreement, or other arrangement for possession of the premises, or by virtue of ownership thereof as evidence by the possession documents submitted by Applicant and contained in the administrative file, pursuant to C.R.S. §44-3-313(1)(b) and City Rule 7.00(A)(2).

III. The location of the premises to be licensed appears to be in compliance with the Zoning Ordinances of the City of Colorado Springs as evidenced by the Land use review report submitted by the Planning and Development Department of the City of Colorado Springs, pursuant to C.R.S. §44-3-313(1)(c) and City Rule 7.00(A)(3).

IV. The location of the premises to be licensed appears to be in compliance with the distance prohibition in regard to any public or parochial school or the principal campus of any college, university or seminary, pursuant to C.R.S. §44-3-313(1)(d) and City Rule 7.00(A)(4).

**ON BEHALF OF THE LOCAL LICENSING AUTHORITY done August 26, 2022.**

FOR  
THE CITY OF COLORADO SPRINGS  
LOCAL LICENSING AUTHORITY



By: Sarah B. Johnson  
City Clerk

Direct questions regarding this notice and hearing to Brittany Morris at 719-385-5115.

## CERTIFICATE OF MAILING

---

I, Brittany Morris, hereby certify that I have mailed a true copy of the foregoing **NOTICE OF HEARING AND INITIAL FINDINGS OF FACT** by United States mail, first class postage paid, on August 26, 2022 to the following address of record:

Trolley Holding, LLC  
d/b/a Pikes Peak Brewing Co., COATI  
524 S Tejon Street  
Colorado Springs, CO 80903

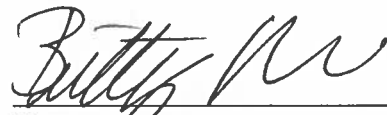

---

Brittany Morris  
License Sepcialist II  
City Clerk's Office  
30 S. Nevada Avenue, Suite 101  
Colorado Springs, CO 80903

CC: info@pikespeakbrewing.com

# Liquor Survey Boundaries



TROLLEY HOLDING, LLC

d/b/a PIKES PEAK BREWING CO., COATI

514 S TEJON ST

OFFICE OF THE CITY CLERK

License ID: 0730985

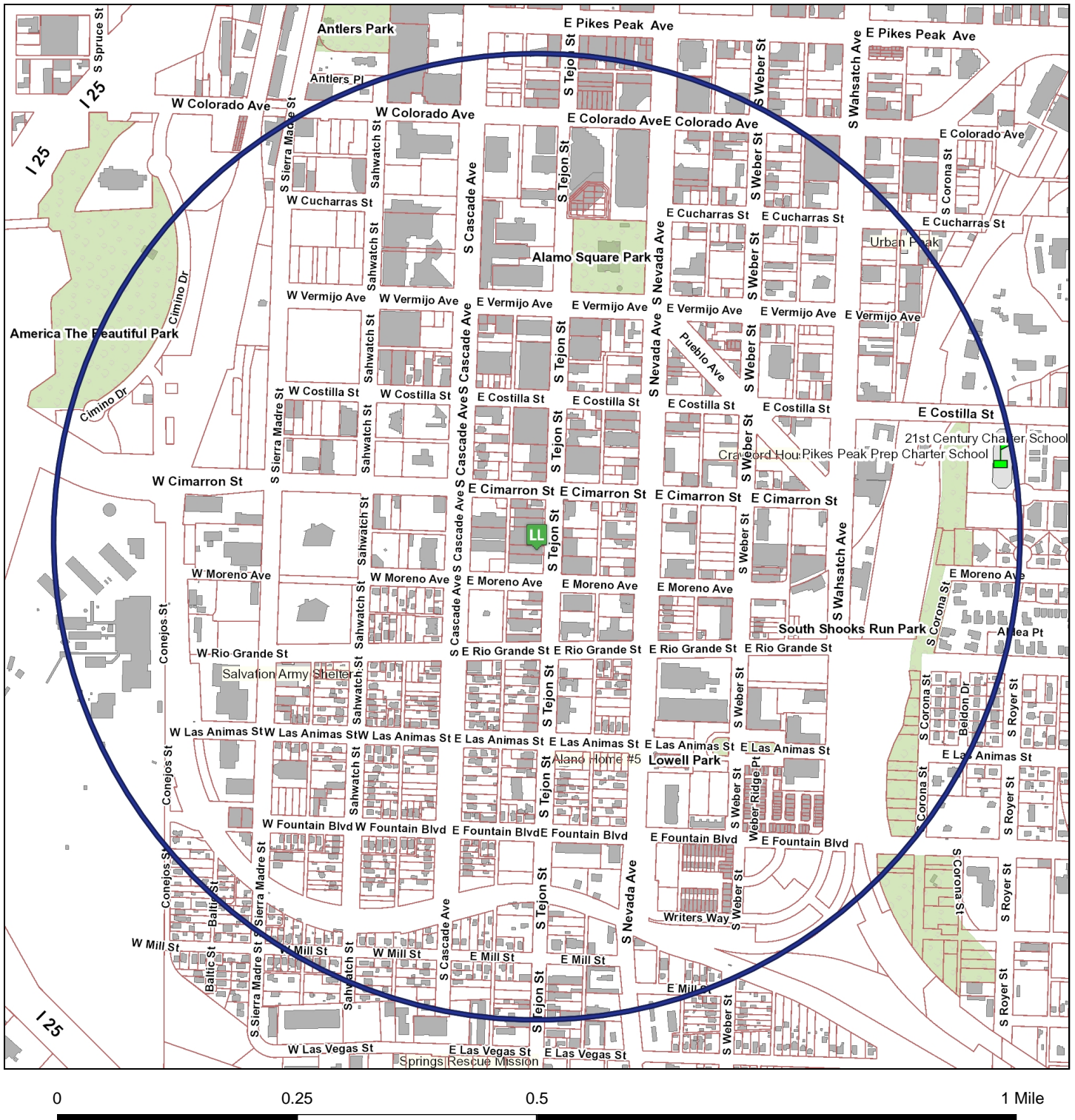

The survey boundary is 0.5 miles from the establishment

Map Prepared: 8/24/2022 1:46 PM

Copyright © 2022 City of Colorado Springs on behalf of the Colorado Springs Utilities. All rights reserved. This work, and/or the data contained hereon, may not be modified, republished, used to prepare derivative works or commercially exploited in any manner without the prior express written consent of the City of Colorado Springs. This work was prepared utilizing the best data available at the time of creation. Neither the City of Colorado Springs, the Colorado Springs Utilities, nor any of their employees makes any warranty, express or implied, or assumes any legal liability or responsibility for accuracy, completeness, or usefulness of any data contained hereon. The City of Colorado Springs, Colorado Springs Utilities, and their employees explicitly disclaim any responsibility for the data contained hereon.



## OFFICE OF THE CITY CLERK

### HEARING LETTER ATTACHMENT

License ID: 0730985

TROLLEY HOLDING, LLC  
d/b/a PIKES PEAK BREWING CO., COATI  
514 S TEJON ST  
COLORADO SPRINGS, CO 80903

### EXISTING SIMILAR LICENSES WITHIN BOUNDARY AREA

<u>Business d/b/a</u>	<u>Business Address</u>	<u>License Type</u>	
1) STREETCAR520	520 S TEJON ST	Hotel & Restaurant Liquor License	61.76 ft
2) THE COFFEE EXCHANGE	526 S TEJON ST	Hotel & Restaurant Liquor License	76.10 ft
3) DOS SANTOS	70 E MORENO AVE	Hotel & Restaurant Liquor License	131.47 ft
4) ATOMIC COWBOY/DENVER BISCUIT CO. et al	528 S TEJON ST	Hotel & Restaurant Liquor License	135.32 ft
5) CORK AND CASK DRINKS	60 E MORENO AVE	Tavern Liquor License	171.06 ft
6) GARDEN OF THE GODS GOURMET MARKET & CAFE, BLIND LARK, TILL, VINE & WHEEL	616 S TEJON ST	Hotel & Restaurant Liquor License	487.62 ft
7) SPRINGHILL SUITES/ELEMENT COLORADO SPRINGS	402 S TEJON ST	Hotel and Restaurant	665.18 ft
8) V F W CLUB 101	702 S TEJON ST	Club Liquor License	702.18 ft
9) LOYAL COFFEE	408 S NEVADA AVE	Hotel & Restaurant Liquor License	810.69 ft
10) STEEL PAN P & P	402 S NEVADA AVE	Hotel and Restaurant	834.22 ft
11) THE BLOCK BAR & GRILL	333 S TEJON ST	Hotel & Restaurant Liquor License	844.94 ft
12) THE WAREHOUSE RESTAURANT	25 W CIMARRON ST	Hotel & Restaurant Liquor License	874.60 ft
13) SHUGA'S	702 S CASCADE AVE	Hotel & Restaurant Liquor License	878.86 ft
14) KINSHIP LANDING	415 S NEVADA AVE	Hotel & Restaurant Liquor License	888.43 ft
15) BAR-K	124 E COSTILLA ST	Tavern Liquor License	923.60 ft
16) WHITE PIE PIZZERIA	330 S NEVADA AVE	Hotel & Restaurant Liquor License	944.95 ft
17) THE GARDEN	401 S NEVADA AVE	Tavern Liquor License	988.89 ft
18) CHINA TOWN RESTAURANT	326 S NEVADA AVE	Hotel & Restaurant Liquor License	1,015.80 ft
19) DOWNTOWN STADIUM	111 W CIMARRON ST	Optional Premises	1,353.31 ft





## OFFICE OF THE CITY CLERK

20) THE CARTER PAYNE	320 S WEBER ST	Brew Pub Liquor License	1,442.02 ft
21) PIKES PEAK CENTER	190 S CASCADE AVE	Tavern Liquor License	1,798.23 ft
22) MACKENZIES CHOPHOUSE	128 S TEJON ST	Hotel & Restaurant Liquor License	1,870.17 ft
23) UNITED STATES OLYMPIC & PARALYMPIC MUSEUM	200 S SIERRA MADRE ST	Hotel & Restaurant Liquor License	2,007.95 ft
24) LUIGIS RESTAURANT	947 S TEJON ST	Hotel & Restaurant Liquor License	2,228.64 ft
25) EPIPHANY	32 S TEJON ST	Tavern Liquor	2,367.43 ft
26) SAIGON CAFÉ	20 E COLORADO AVE	Beer & Wine Liquor License	2,369.93 ft
27) URBAN EGG A DAYTIME EATERY	28 S TEJON ST	Hotel & Restaurant Liquor License	2,418.75 ft
28) EAST COAST DELI	24 S TEJON ST	Hotel & Restaurant Liquor License	2,453.76 ft
29) RED GRAVY	23 S TEJON ST	Hotel & Restaurant Liquor License	2,461.59 ft
30) FUJIYAMA	22 S TEJON ST	Hotel & Restaurant Liquor License	2,480.31 ft
31) JACK QUINN'S IRISH ALE HOUSE AND PUB	21 S TEJON ST	Hotel & Restaurant Liquor License	2,489.06 ft
32) CHIPOTLE MEXICAN GRILL	17 S TEJON ST	Hotel & Restaurant Liquor License	2,533.39 ft
33) THIRTY THREE	18 S NEVADA AVE	Tavern Liquor License	2,562.98 ft
34) MINING EXCHANGE HOTEL OR THE GOLD ROOM	18 S NEVADA AVE	Tavern Liquor License	2,566.75 ft
35) HIGH GRADE JAMAICAN RESTAURANT	1020 S TEJON ST	Hotel & Restaurant Liquor License	2,568.08 ft
36) 3E's COMEDY CLUB	1 S NEVADA AVE	Tavern Liquor License	2,574.80 ft
37) THE PERK DOWNTOWN	14 S TEJON ST	Hotel & Restaurant Liquor License	2,591.02 ft
38) JAX FISH HOUSE AND OYSTER BAR	11 S TEJON ST	Hotel & Restaurant Liquor License	2,633.69 ft