

## ZONE CHANGE LEGAL DESCRIPTION – EXHIBIT A

A TRACT OF LAND BEING ALL OF WARRANTY DEED RECORDED AT RECEPTION NO. 203183974, LOCATED IN THE WEST HALF OF SECTION 36, TOWNSHIP 14 SOUTH, RANGE 66 WEST OF THE 6TH P. M., EL PASO COUNTY, COLORADO, MORE PARTICULARLY DESCRIBED AS FOLLOWS:

**COMMENCING** AT THE NORTHWEST CORNER OF A TRACT OF LAND AS RECORDED IN BOOK 5741 AT PAGE 1365 OF THE RECORDS OF SAID EL PASO COUNTY, SAID POINT ALSO BEING ON THE SOUTH LINE OF MY PLACE SUBDIVISION AS RECORDED IN PLAT BOOK U-3 AT PAGE 70 OF THE RECORDS OF SAID EL PASO COUNTY;

THENCE SOUTH 87 DEGREES 32 MINUTES 07 SECONDS EAST ALONG THE NORTH LINE OF SAID TRACT IN BOOK 5741 AT PAGE 1365 AND THE SOUTH LINE OF MY PLACE SUBDIVISION, A DISTANCE OF 9.75 FEET TO THE **TRUE POINT OF BEGINNING** OF THIS DESCRIPTION;

1. THENCE CONTINUING SOUTH 87 DEGREES 32 MINUTES 07 SECONDS EAST ALONG SAID LINES A DISTANCE OF 836.12 FEET TO THE NORTHEAST CORNER OF SAID TRACT IN BOOK 5741 AT PAGE 1365;
2. THENCE SOUTH 00 DEGREES 39 MINUTES 38 SECONDS EAST ALONG SAID EAST LINE OF SAID TRACT IN BOOK 5741 AT PAGE 1365, A DISTANCE OF 299.77 FEET TO THE NORTHERLY LINE OF A TRACT OF LAND AS RECORDED AT RECEPTION NO. 097098321 OF THE RECORDS OF THE RECORDS OF SAID EL PASO COUNTY;

THE FOLLOWING EIGHT (8) COURSES FOLLOW SAID NORTHERLY LINE OF SAID TRACT AT RECEPTION NO. 97098321:

3. THENCE SOUTH 53 DEGREES 51 MINUTES 40 SECONDS WEST A DISTANCE OF 60.18 FEET;
4. THENCE SOUTH 79 DEGREES 49 MINUTES 47 SECONDS WEST A DISTANCE OF 57.18 FEET;
5. THENCE SOUTH 83 DEGREES 40 MINUTES 49 SECONDS WEST A DISTANCE OF 101.12 FEET;
6. THENCE SOUTH 85 DEGREES 22 MINUTES 06 SECONDS WEST A DISTANCE OF 100.72 FEET;
7. THENCE SOUTH 89 DEGREES 55 MINUTES 14 SECONDS WEST A DISTANCE OF 200.16 FEET;
8. THENCE SOUTH 88 DEGREES 46 MINUTES 39 SECONDS WEST A DISTANCE OF 100.18 FEET;
9. THENCE SOUTH 89 DEGREES 20 MINUTES 55 SECONDS WEST A DISTANCE OF 218.82 FEET;
10. THENCE NORTH 46 DEGREES 44 MINUTES 20 SECONDS WEST A DISTANCE OF 41.51 FEET TO A POINT ON THE BOUNDARY LINE OF A TRACT OF LAND AS RECORDED AT RECEPTION NO. 097043242 OF THE RECORDS OF SAID EL PASO COUNTY;
11. THENCE NORTH 02 DEGREES 28 MINUTES 46 SECONDS EAST ALONG SAID BOUNDARY LINE A DISTANCE OF 377.37 FEET TO THE **TRUE POINT OF BEGINNING**, COUNTY OF EL PASO, STATE OF COLORADO.

CONTAINING AN AREA OF 7.324 ACRES, (319,031 SQUARE FEET), MORE OR LESS.

BRADY J. MOORHEAD, PLS 38668  
COLORADO LICENSED PROFESSIONAL LAND SURVEYOR  
FOR AND ON BEHALF OF AZTEC CONSULTANTS, INC.  
300 E. MINERAL AVENUE, SUITE 1  
LITTLETON, CO 80122

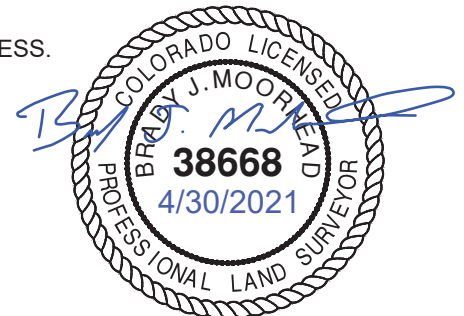

CITY FILE NO.CPC PUZ 21-00019