

# Black Forest Rd. Roadway Improvements: Woodmen Rd. to Research Pkwy. Project School District 20 Land Acquisition

January 10, 2022

Gayle Sturdivant, City Engineer/Deputy  
Public Works Director



# Project Limits



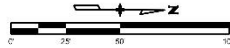

**LEGEND**

- EXISTING ROW
- EXISTING PERMANENT EASEMENT
- PROPOSED ROW
- PROPOSED ROW AREA
- PROPOSED PERMANENT IMPROVEMENT EASEMENT
- PROPOSED PERMANENT IMPROVEMENT EASEMENT AREA
- PROPOSED TEMPORARY EASEMENT
- PROPOSED TEMPORARY EASEMENT AREA
- PROPOSED UTILITY EASEMENT AREA

**NOTES:**

1. RIGHT OF WAY PLANS ARE SHOWN FOR INFORMATION ONLY.
2. SEE LEGAL DESCRIPTIONS AND EXHIBITS DEVELOPED FOR EACH PARCEL FOR MORE INFORMATION AS PROPOSED ROW AND EASEMENTS MAY HAVE BEEN UPDATED DURING ACQUISITION PROCESS.

## El Paso County School District 20

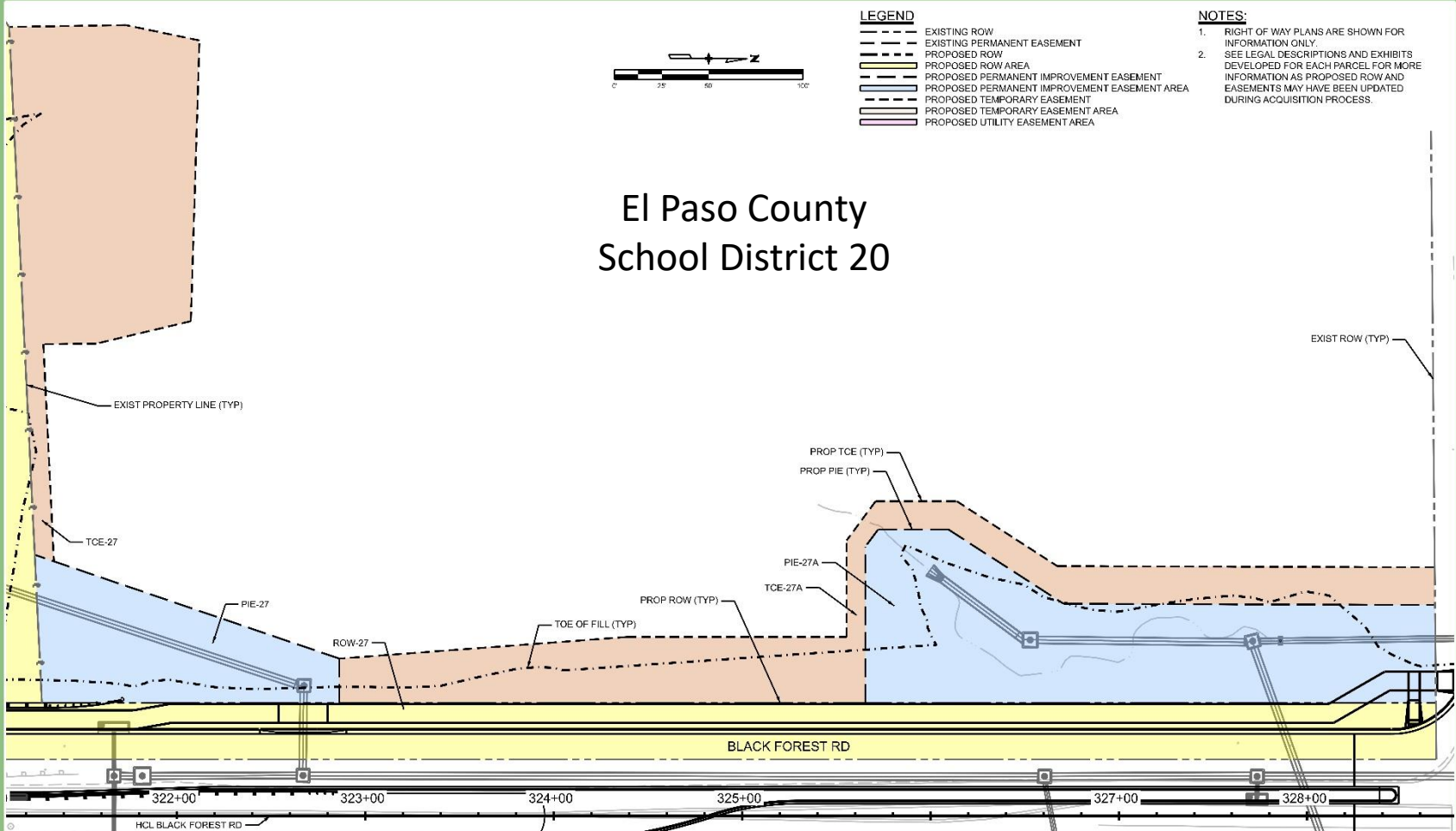

**BLACK FOREST ROAD  
DISTRICT 20 PROPERTY**