



VERMIJO AVE & SIERRA MADRE ST

RECONSTRUCTION UPDATE

9.25.2017

Vermijo and Sierra
Madre Streetscape

What foundation planning
has occurred over the last
20+ years?

1971	The Downtown Plan
1992	Downtown Action Plan
1998	Springs Community Improvement Program (SCIP)
2001	Confluence Park Master Plan
2001	SW Downtown Urban Renewal Plan
2007	Imagine Downtown Plan of Development
2007	Imagine Downtown Master Plan & Form Based Code
2012	ULI Panel Study for Downtown Colorado Springs
2013	City for Champions
2016	Experience Downtown Masterplan
2017	Vermijo & Sierra Madre Streetscape RFP issued

Progress to date

April 2017

AECOM Team Received Notice to Proceed

May 2017

Design Charrette 1

June 2017

Design Charrette 2

September 2017

AECOM Team Submitted Concept Package

Progress to date	April 2017	AECOM Team Received Notice to Proceed
	May 2017	Design Charrette 1
	June 2017	Design Charrette 2
	September 2017	AECOM Team Submitted Concept Package

Next Steps	September 2017	City Issues Request for CMGC Proposals
	December 2017	Contractor to Receive Notice to Proceed
		Begin Construction:
	Early 2018	▪ Relocate CSU Water and Sanitary Lines
	Early 2018	▪ Construct Underground Water Quality Vault
	Spring 2018	▪ Construct Sierra Madre then Vermijo
Summer 2019	▪ Construction Substantially Completed	

GUIDING PRINCIPLES

01 FLEXIBLE: Spaces designed at the human scale for year-round use for day-to-day and events of all sizes.

02 DESTINATION: A place for visitors and the community to come socialize and have a different experience each time.

03 SUSTAINABILITY: A premier green street that sets the standard for the district to be a leader in sustainable practices.

04 TIMELESS: A street that draws on the rich history of Colorado Springs and the promising future of the Southwest Downtown District.

05 CATALYST: A space designed for uses that spur revitalization and build community throughout Downtown.

06 UNIQUE: A place like no other that people remember and return to.

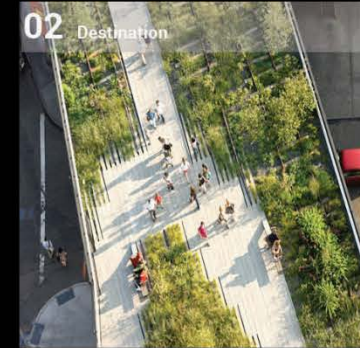

UNITY in MOTION

INTENT

Colorado Springs opens its doors to all. This beautiful city was founded as a resort destination for visitors from all corners of the world and the Olympic presence continues to attract people to Colorado Springs. The new Vermijo Street will be a popular destination; bringing people of diverse cultures and backgrounds together. Vermijo Street will be a place where everyone is welcome to sit back, relax and have a good time together. The international relay of the Olympic torch is abstracted as a 'flame trail' that travels the length of Vermijo; connecting the activated spaces in between. Paving patterns that reflect patterns of various cultures are used at special locations to highlight people coming together.

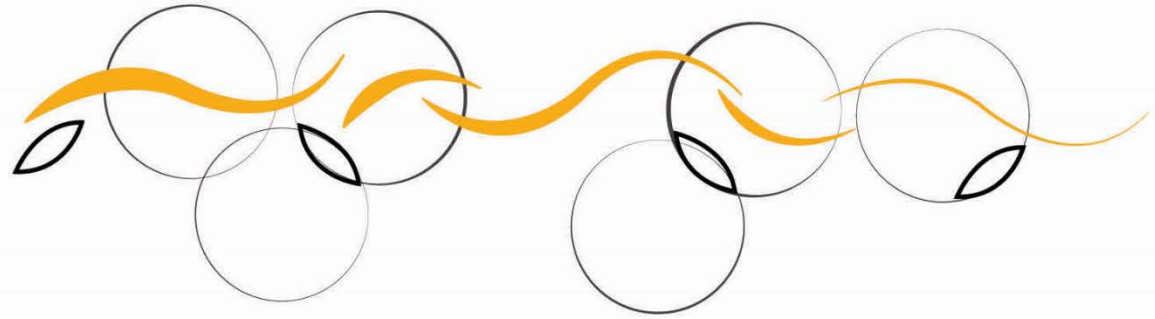

DESIGN INSPIRATION



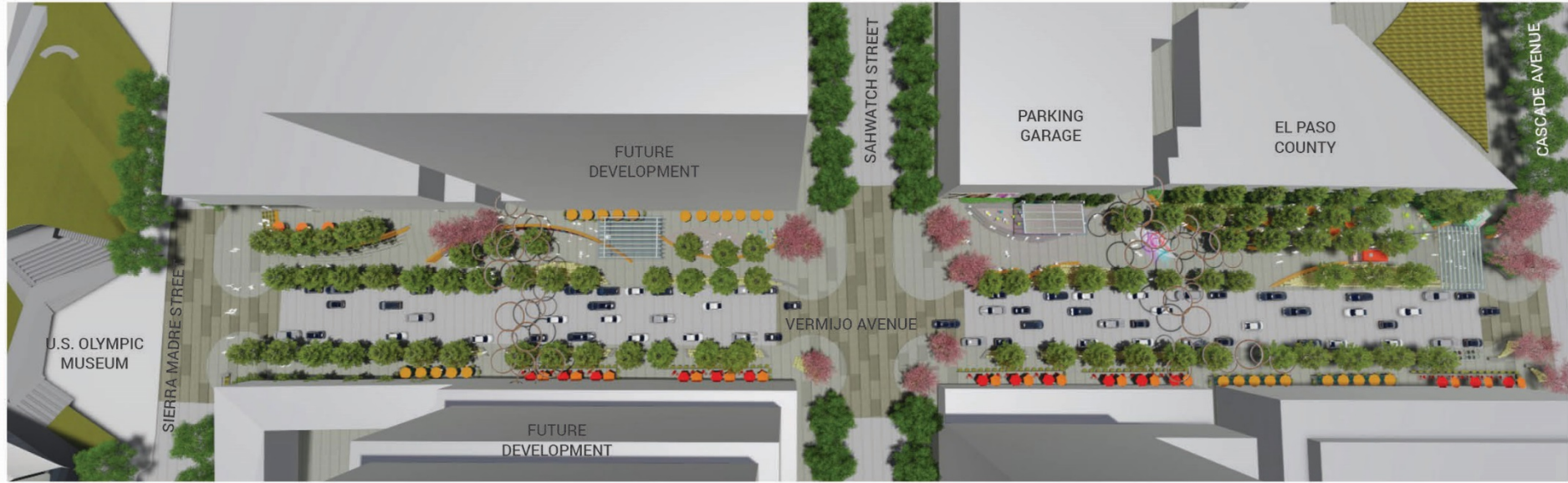

Vermijo Avenue & Sierra Madre Street | VERMIJO AVE - PHASE 1

STREETScape GENERAL CHARACTER IMAGES



2nd Street District, Austin



Assembly Row, Somerville



One Arts Plaza, Dallas



Aomori Shiba Park, Tokyo



Lincoln Road, Miami



Jewelry District, Providence

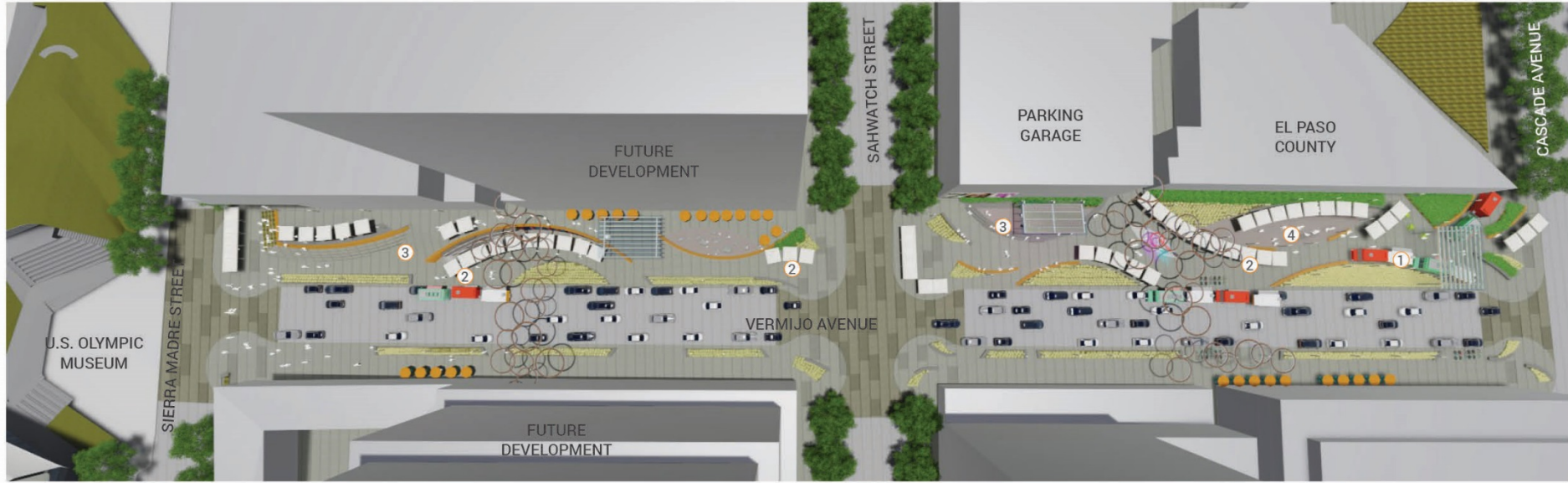

- ① FOOD TRUCK AREA
- ② MARKET TENTS (59 TENTS SHOWN)
- ③ STAGE AREA
- ④ BEER GARDEN

STREETSCAPE GENERAL EVENT IMAGES





- ① INTERACTIVE ELEMENT / LIGHT WALL
- ② FLAME TRAIL
- ③ DINING OVERLOOK
- ④ WATER/MIST ELEMENT
- ⑤ TERRACED SEATING
- ⑥ WATER QUALITY PLANTING
- ⑦ GATEWAY INTERSECTION
- ⑧ PLATFORM SEATING/STAGE
- ⑨ ICONIC OVERHEAD LIGHT ELEMENT
- ⑩ SHADE STRUCTURE
- ⑪ MARKET GROVE
- ⑫ CAFE SEATING
- ⑬ MONOLITHIC BENCH
- ⑭ UNIT PAVING
- ⑮ DECOMPOSED GRANITE PAVING
- ⑯ CONCRETE PAVING
- ⑰ SCULPTURAL / PLAY AREA
- ⑱ ZERO BARRIER EDGE

Vermijo Avenue & Sierra Madre Street | SIERRA MADRE STREET - looking North from Costilla St. intersection

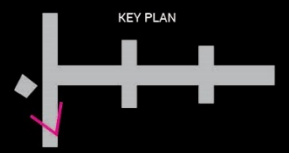



- | | | | | |
|------------------------------------|--------------------------|---------------------------------|------------------------------|---------------------------|
| 1 INTERACTIVE ELEMENT / LIGHT WALL | 5 TERRACED SEATING | 9 ICONIC OVERHEAD LIGHT ELEMENT | 13 MONOLITHIC BENCH | 17 SCULPTURAL / PLAY AREA |
| 2 FLAME TRAIL | 6 WATER QUALITY PLANTING | 10 SHADE STRUCTURE | 14 UNIT PAVING | 18 ZERO BARRIER EDGE |
| 3 DINING OVERLOOK | 7 GATEWAY INTERSECTION | 11 MARKET GROVE | 15 DECOMPOSED GRANITE PAVING | |
| 4 WATER/MIST ELEMENT | 8 PLATFORM SEATING/STAGE | 12 CAFE SEATING | 16 CONCRETE PAVING | |

Vermijo Avenue & Sierra Madre Street | VERMIJO AVE. - looking West towards USOM (& Pikes Peak)

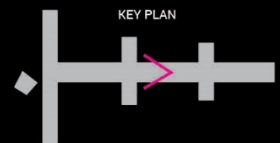



- ① INTERACTIVE ELEMENT / LIGHT WALL
- ② FLAME TRAIL
- ③ DINING OVERLOOK
- ④ WATER/MIST ELEMENT
- ⑤ TERRACED SEATING
- ⑥ WATER QUALITY PLANTING
- ⑦ GATEWAY INTERSECTION
- ⑧ PLATFORM SEATING/STAGE
- ⑨ ICONIC OVERHEAD LIGHT ELEMENT
- ⑩ SHADE STRUCTURE
- ⑪ MARKET GROVE
- ⑫ CAFE SEATING
- ⑬ MONOLITHIC BENCH
- ⑭ UNIT PAVING
- ⑮ DECOMPOSED GRANITE PAVING
- ⑯ CONCRETE PAVING
- ⑰ SCULPTURAL / PLAY AREA
- ⑱ ZERO BARRIER EDGE

Vermijo Avenue & Sierra Madre Street | VERMIJO AVE. - looking East from within public space near Sahwatch

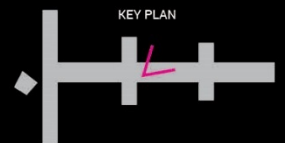



- ① INTERACTIVE ELEMENT / LIGHT WALL
- ② FLAME TRAIL
- ③ DINING OVERLOOK
- ④ WATER/MIST ELEMENT
- ⑤ TERRACED SEATING
- ⑥ WATER QUALITY PLANTING
- ⑦ GATEWAY INTERSECTION
- ⑧ PLATFORM SEATING/STAGE
- ⑨ ICONIC OVERHEAD LIGHT ELEMENT
- ⑩ SHADE STRUCTURE
- ⑪ MARKET GROVE
- ⑫ CAFE SEATING
- ⑬ MONOLITHIC BENCH
- ⑭ UNIT PAVING
- ⑮ DECOMPOSED GRANITE PAVING
- ⑯ CONCRETE PAVING
- ⑰ SCULPTURAL / PLAY AREA
- ⑱ ZERO BARRIER EDGE

Vermijo Avenue & Sierra Madre Street | VERMIJO AVE. - looking Northwest near mid-block of Block 2

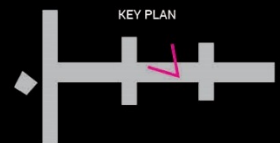



- ① INTERACTIVE ELEMENT / LIGHT WALL
- ② FLAME TRAIL
- ③ DINING OVERLOOK
- ④ WATER/MIST ELEMENT
- ⑤ TERRACED SEATING
- ⑥ WATER QUALITY PLANTING
- ⑦ GATEWAY INTERSECTION
- ⑧ PLATFORM SEATING/STAGE
- ⑨ ICONIC OVERHEAD LIGHT ELEMENT
- ⑩ SHADE STRUCTURE
- ⑪ MARKET GROVE
- ⑫ CAFE SEATING
- ⑬ MONOLITHIC BENCH
- ⑭ UNIT PAVING
- ⑮ DECOMPOSED GRANITE PAVING
- ⑯ CONCRETE PAVING
- ⑰ SCULPTURAL / PLAY AREA
- ⑱ ZERO BARRIER EDGE

Vermijo Avenue & Sierra Madre Street | VERMIJO AVE. - looking Northwest near mid-block of Block 2

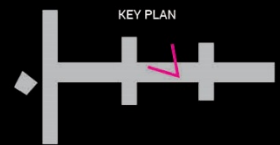



- | | | | | |
|------------------------------------|--------------------------|---------------------------------|-----------------------------|--------------------------|
| ① INTERACTIVE ELEMENT / LIGHT WALL | ⑤ TERRACED SEATING | ⑨ ICONIC OVERHEAD LIGHT ELEMENT | ⑬ MONOLITHIC BENCH | ⑰ SCULPTURAL / PLAY AREA |
| ② FLAME TRAIL | ⑥ WATER QUALITY PLANTING | ⑩ SHADE STRUCTURE | ⑭ UNIT PAVING | ⑱ ZERO BARRIER EDGE |
| ③ DINING OVERLOOK | ⑦ GATEWAY INTERSECTION | ⑪ MARKET GROVE | ⑮ DECOMPOSED GRANITE PAVING | |
| ④ WATER/MIST ELEMENT | ⑧ PLATFORM SEATING/STAGE | ⑫ CAFE SEATING | ⑯ CONCRETE PAVING | |

Vermijo Avenue & Sierra Madre Street | VERMIJO AVE. - looking West from Cascade

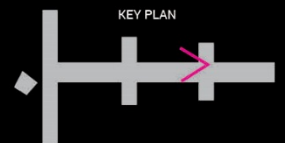

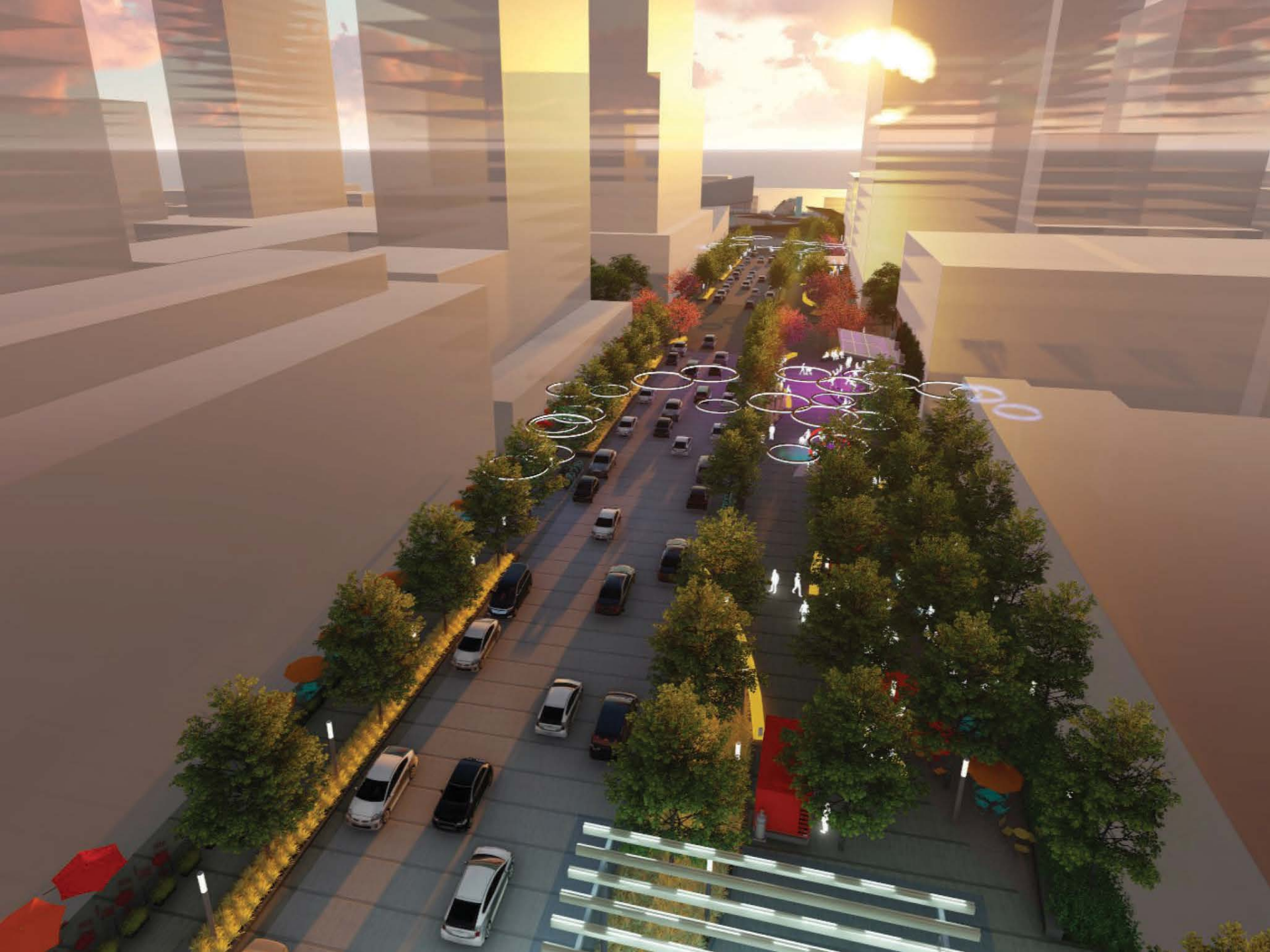

Funding Summary

USOM Commitment \$ 250,000

USOM Tourism Bonds \$ 1,700,000

PPRTA (Program Funds) \$ 400,000

PPRTA (Maintenance Fund) \$ 2,800,000

SECURED FUNDING TO DATE \$ 5,150,000

Questions?



VERMIJO AVE & SIERRA MADRE ST

RECONSTRUCTION UPDATE

9.25.2017