

TSN: 5329210012  
 PROPERTY ADDRESS: 4181 KNOLLVALE DRIVE

OWNER(S):  
 SARITA AND ALEX LEWIS  
 4181 KNOLLVALE DRIVE  
 COLORADO SPRINGS, CO 80922

LEGAL DESCRIPTION: LOT 11 NORTH RANGE AT SPRINGS RANCH FILING NO. 4  
 ZONE: R-1 6000/AO/DF (SINGLE FAMILY RESIDENTIAL WITH AIRPORT AND DESIGN FLEXIBILITY OVERLAYS)

CONDITIONAL USE PROPOSAL: TO OPERATE A LARGE HOME DAYCARE (NOTE: HALF OF THE MAIN LEVEL AND WHOLE BASEMENT WILL BE FOR CHILDCARE).

SURROUNDING ZONING AND LAND USE(S):  
 NORTH, SOUTH, EAST AND WEST OF KNOLLVALE DRIVE:  
 ZONE: R-1 6000/AO/DF (SINGLE FAMILY RESIDENTIAL WITH AIRPORT AND DESIGN FLEXIBILITY OVERLAYS)  
 LAND USE: SINGLE FAMILY RESIDENCE

RESIDENCE: 1,242 SQ. FT.  
 LOT COVERAGE: 24.7%  
 LOT SIZE: 5,033 SQ. FT. (0.115 ACRES)  
 CITY PLANNING FILE NO.: CPC CU 16-00005

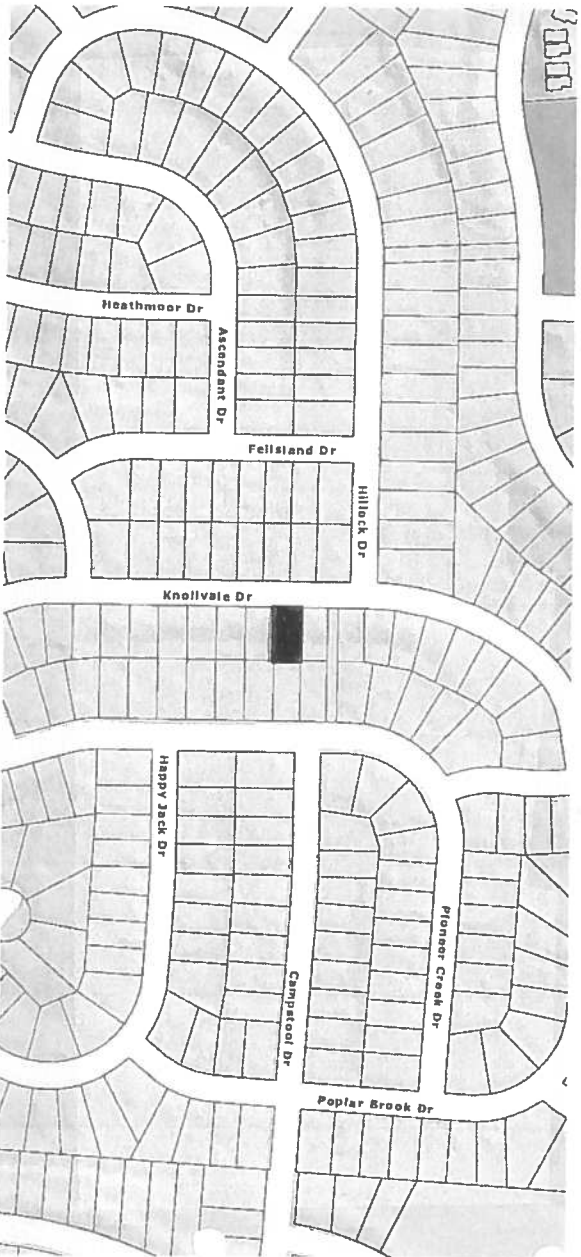

KNOLLVALE DR

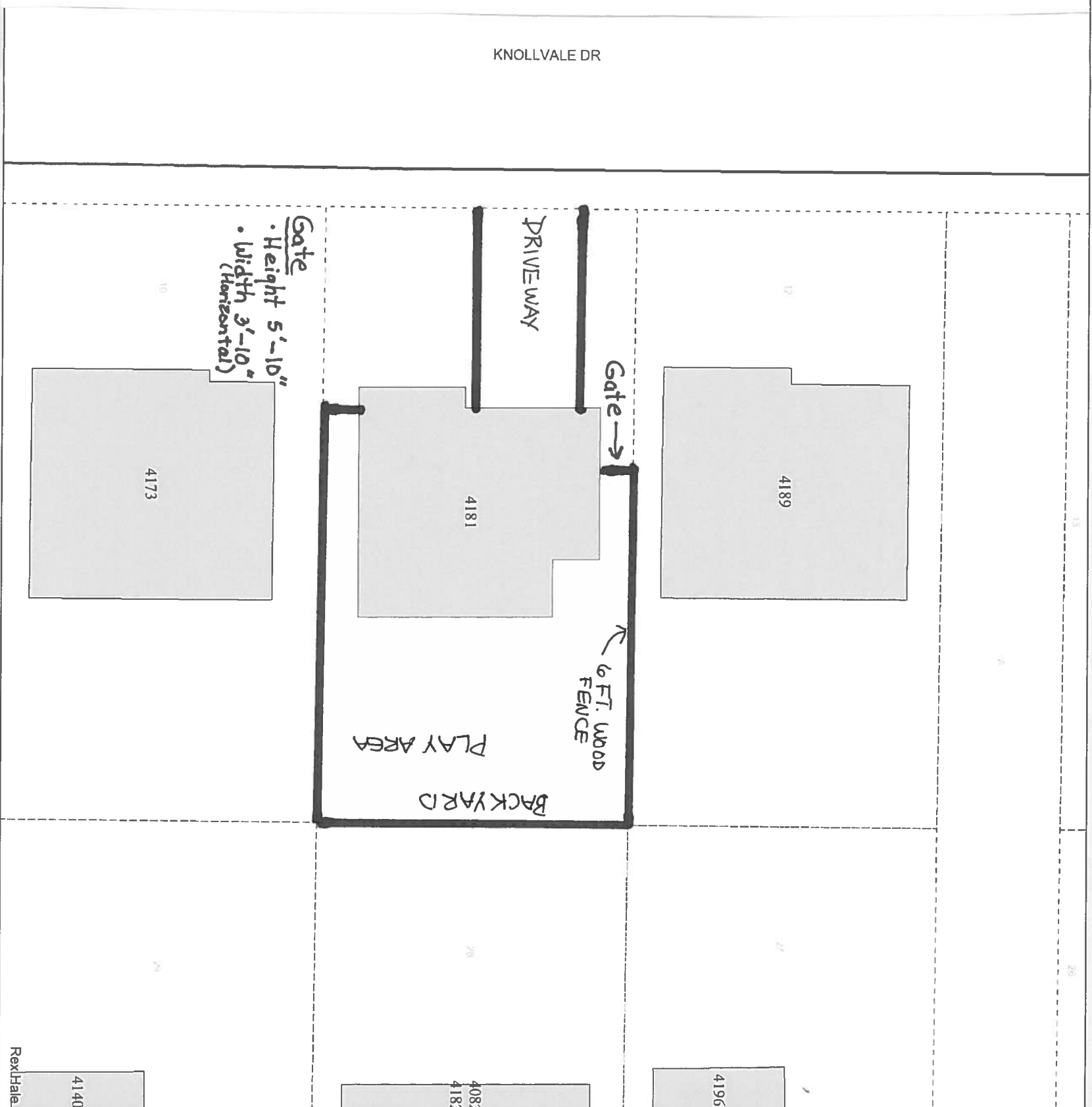

Copyright © 2016 City of Colorado Springs on behalf of the Colorado Springs Utilities. All rights reserved. This work, and/or the data contained herein, may not be reproduced, modified, distributed, republished, or applied in any manner without the prior written consent of the City of Colorado Springs and Colorado Springs Utilities. No warranty is made by the City of Colorado Springs or Colorado Springs Utilities, or any of its employees, agents, or contractors, for the accuracy, completeness, or timeliness of the data contained herein.

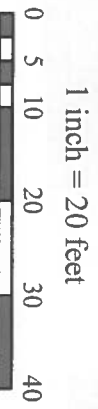

Plot File Created: February 10, 2016

Requestor: 4181 Knollvale  
 Company: -  
 Address: 4181 Knollvale Dr, Colorado Springs, Colorado, 80922

**CPC CU 16-00005** Parcel Map

Call Before You Dig "811"

FIGURE 1