

**ZONE CHANGE EXHIBIT – EXHIBIT B**

**SOUTH POWERS BOULEVARD**

(PUBLIC ROW WIDTH VARIES)

**SILVER HAWK  
SUBDIVISION FILING  
NO. 1**

REC. NO. 204154550

NW 1/4 SEC. 36,  
T.14S., R.66W., SIXTH P.M.

**POINT OF COMMENCEMENT**

NORTHWEST CORNER  
BOOK 5741 PAGE 1365

**TRUE POINT OF  
BEGINNING**

LOT 1  
**MY PLACE SUBDIVISION**  
BOOK U-3, PAGE 70  
REC NO. 1041834

L2

NORTHERLY BOUNDARY BOOK 5741 PAGE 1365  
(BASIS OF BEARINGS)

**SILVER HAWK AVENUE**

(56' WIDE PUBLIC ROW)  
REC. NO. 96130176

PARCEL CONTAINS  
319,031 (SQ.FT.)  
7.324 ACRES  
MORE OR LESS

**UNPLATTED**

RIGHT-OF-WAY LINE  
REC. NO. 97043242

RIGHT-OF-WAY LINE  
REC. NO. 97043241

RIGHT-OF-WAY LINE  
REC. NO. 97043242



**UNPLATTED**

L11 L10 L9 L8 L7 L6 L5 L4

**HANCOCK EXPRESSWAY**

(PUBLIC ROW WIDTH VARIES)  
REC. NO. 97098321

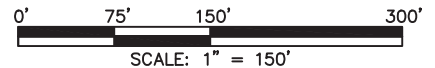

CITY FILE NO. CPC PUZ 21-00019

NOTE: THIS DRAWING DOES NOT REPRESENT A MONUMENTED LAND SURVEY AND IS ONLY INTENDED TO DEPICT THE ATTACHED LEGAL DESCRIPTION.

PATH: Q:\151121-01\DWG\EXHIBITS\  
DWG NAME: 2021-04-27 SKY VIEW ZONING  
DWG: **BJM** CHK: **JRW**  
DATE: 4/27/2021  
SCALE: 1" = 150'



**AZTEC**  
CONSULTANTS, INC.

300 East Mineral Ave,  
Suite 1  
Littleton, Colorado 80122  
Phone: (303)713-1898  
Fax: (303)713-1897  
[www.aztecconsultants.com](http://www.aztecconsultants.com)

**ZONE CHANGE EXHIBIT**

W2 SEC. 36, T14S, R66W, 6TH P.M.  
EL PASO COUNTY, COLORADO

JOB NUMBER 151121-01

2 OF 3 SHEETS

**EXHIBIT B**

## ZONE CHANGE EXHIBIT – EXHIBIT B

LINE TABLE		
LINE	BEARING	LENGTH
L1	S87°32'07"E	9.75'
L2	S87°32'07"E	836.12'
L3	S00°39'38"E	299.77'
L4	S53°51'40"W	60.18'
L5	S79°49'47"W	57.18'
L6	S83°40'49"W	101.12'
L7	S85°22'06"W	100.72'
L8	S89°55'14"W	200.16'
L9	S88°46'39"W	100.18'
L10	S89°20'55"W	218.82'
L11	N46°44'20"W	41.51'
L12	N02°28'46"E	377.37'

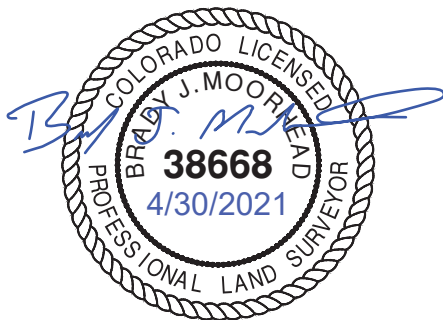

CITY FILE NO. CPC PUZ 21-00019

NOTE: THIS DRAWING DOES NOT REPRESENT A MONUMENTED LAND SURVEY AND IS ONLY INTENDED TO DEPICT THE ATTACHED LEGAL DESCRIPTION.

PATH: Q:151121-01\DWG\EXHIBITS\  
 DWG NAME: 2021-04-27 SKY VIEW ZONING  
 DWG: BJM CHK: JRW  
 DATE: 4/27/2021  
 SCALE: N/A



**ZONE CHANGE EXHIBIT**  
 W2 SEC. 36, T14S, R66W, 6TH P.M.  
 EL PASO COUNTY, COLORADO  
 JOB NUMBER 151121-01 3 OF 3 SHEETS

**EXHIBIT B**