

# EXHIBIT A

A portion of Lot 157, Gold Hill Mesa Filing No. 13, as recorded under Reception No. 224715431, City of Colorado Springs, County of El Paso, State of Colorado, described as follows:

BEGINNING at the most Northerly corner of said Lot 157;

thence the following two (2) courses along the Northerly and Easterly lines of said Lot 157:

1) S 67°22'03" E, a distance of 620.85 feet;

2) S 22°37'57" W, a distance of 2.85 feet;

thence N 67°22'03" W, a distance of 620.85 feet to the Westerly line of said Lot 157;

thence N 22°37'41" E along said Westerly line, a distance of 2.85 feet to the POINT OF BEGINNING.

Containing a total calculated area of 1,767 square feet (0.041 acres) of land, more or less.



Kirk P. Bode  
Colorado Professional Land Surveyor No. 38254  
For and on behalf of Barron Land, LLC

## BARRON LAND

BOUNDARY Δ MAPPING Δ SURVEYING Δ CONSTRUCTION  
2790 N. Academy Blvd. Suite 311 P: 719.360.6827  
Colorado Springs, CO 80917 F: 719.466.6527

[www.BARRONLAND.com](http://www.BARRONLAND.com)

DATE: 01/28/2025

REV. DATE:

PROJECT No.: 22-062

SHEET 1 OF 2

# EXHIBIT A



LINE	BEARING	DISTANCE
L1	S 22°37'57" W	2.85'
L2	N 22°37'41" E	2.85'

TRACT FF

TRACT A

LOT 155

L2  
POINT OF BEGINNING

BROADWAY POINT  
(VARIABLE WIDTH PRIVATE STREET)

S 67°22'03" E 620.85'  
N 67°22'03" W 620.85'

TRACT A

LOT 157

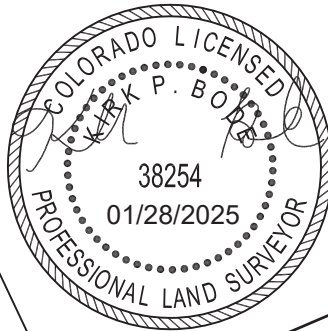

TRACT B

WHEELER AVENUE  
(60' PUBLIC R.O.W.)

TRACT AA

LOT 158

ESCALANTE HEIGHTS  
(VARIABLE WIDTH PRIVATE STREET)

TRACT CC

TRACT T

TRACT B

TRACT F

TRACT BB

TRACT E

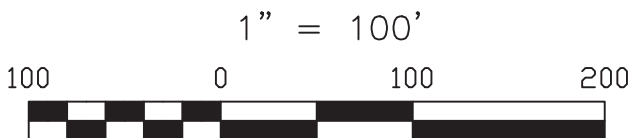

## BARRON LAND

BOUNDARY Δ MAPPING Δ SURVEYING Δ CONSTRUCTION  
2790 N. Academy Blvd. Suite 311 P: 719.360.6827  
Colorado Springs, CO 80917 F: 719.466.6527

www.BARRONLAND.com

DATE: 01/28/2025

REV. DATE:

PROJECT No.: 22-062

SHEET 2 OF 2