

EXHIBIT A

A parcel of land located in northwest one-quarter of SECTION 1, TOWNSHIP 14 SOUTH, RANGE 67 WEST OF THE SIXTH P.M., El Paso County, Colorado. a portion of a tract of land conveyed to the CITY OF COLORADO SPRINGS as described in a document recorded in book 3570 page 910 in the records of El Paso County, Colorado. More particularly described as follows;

The west 13.58 feet of the east 185.0 feet of the north 92.0 feet of the south 217.0 feet of the southwest quarter of the northeast quarter of the northwest quarter of the southeast quarter of section 1, township 14 south, Range 67 west of the 6th P.M., city of Colorado Springs, El Paso, Colorado.

Said portion containing a protracted area of 1,249 Square feet.

This legal description was prepared for and on behalf of The City of Colorado Springs by
Robert A. Pisciotta, Jr., Colorado P.L.S. 38224
30 S. Nevada Ave., Suite 402
Colorado Springs, CO.
719-385-5545

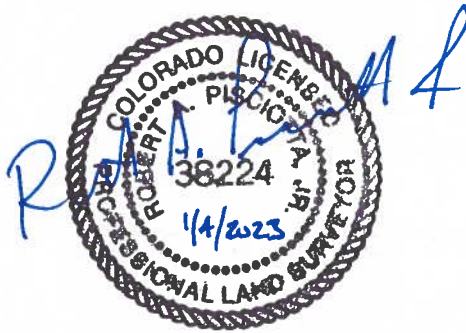

ZONE-22-020



Parcel
Southeast 1/4 of Section 1,
Township 14 South, Range 67
West of the 6th P.M.

Drawn By: R. Kotwica Date: 07/07/2020

Job Number: 2018055 PAGE 1 OF 2

THIS DOCUMENT IS INCOMPLETE WITHOUT PAGE 2

EXHIBIT A