

FIGURE 1











DATE:	BY:	DESCRIPTION:
09.10.19	B.L.	PER CITY COMMENTS

**SCHEMATIC LANDSCAPE DIAGRAM**

Name of Project: Downtown Stadium Entry No. 1 Date: 09.10.19

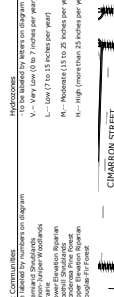

- Plant Communities**
- 1 - Seeded Grasslands
  - 2 - Prairie
  - 3 - Open Woodland
  - 4 - Open Woodland
  - 5 - Open Woodland
  - 6 - Open Woodland
- Hardscapes**
- 1 - Very Low (0 to 3 inches per year)
  - 2 - Low (3 to 8 inches per year)
  - 3 - Moderate (8 to 25 inches per year)
  - 4 - High (more than 25 inches per year)

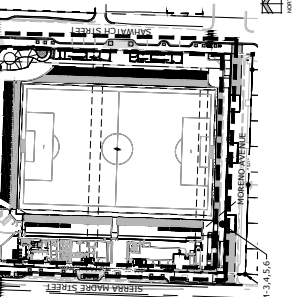

**STREET TREES**  
Form Based Zone Street Tree Standards 2.8.4.1

Street Name	Tree/Foot	No. of Trees	Plant Abb.
SIERRA MADRE ST	1,740	13,115	SM
CHARRON ST	430	11,714	CM
SIERRA VICH ST	500	1,740	SH

**LANDSCAPE NOTES**

1. ALL LANDSCAPE INSTALLATIONS SHALL BE IN ACCORDANCE WITH THE CITY OF COLORADO SPRINGS LANDSCAPE MAINTENANCE AND CARE MANUAL. APPROVED FOR APPROVED EQUAL OR BUILDS UP TO THESE AREAS. INCORPORATE 2 QUART VANDERWEG'S AREA OF ORGANIC COMPOST AND 2 QUARTS OF ORGANIC FERTILIZER PER 1000 SQ FT OF AREA. SEE LANDSCAPE DETAILS. FERTILIZER REQUIREMENTS BELOW ARE BASED ON SOIL ANALYSIS.
2. CONTRACTOR TO DELIVER STOCKED TOPSOIL FROM GRADING OPERATION AS AVAILABLE. TILL INTO TOP 10" OF SOIL.
3. STRIPES FOR PLANTING TO UTILIZE STRUCTURAL SOILS.
4. FOR FINISHING LIGHTING AND LIGHTING, REFER TO ARCHITECTURAL PLAN.
5. ALL PLANTING SHALL BE INSTALLED AND MAINTAINED IN ACCORDANCE WITH THE CITY OF COLORADO SPRINGS LANDSCAPE MAINTENANCE AND CARE MANUAL.
6. ALL PLANTING SHALL BE INSTALLED AND MAINTAINED IN ACCORDANCE WITH THE CITY OF COLORADO SPRINGS LANDSCAPE MAINTENANCE AND CARE MANUAL.
7. A FULL AUTOMATIC SPRINKLER IRRIGATION SYSTEM WILL SERVE ALL TREE, SHRUB, AND GROUND COVER PLANTING. THE SYSTEM SHALL BE INSTALLED AND MAINTAINED IN ACCORDANCE WITH THE CITY OF COLORADO SPRINGS LANDSCAPE MAINTENANCE AND CARE MANUAL.
8. ALL PLANTS AND TREES NOT INSTALLED IN PLANTING BEDS TO RECEIVE 1" DEPT WOOD MULCH RING UNLESS SPECIFIED OTHERWISE.
9. ALL SOUTHERN PINE, SAGE, SHRUB BEDS TO BE SEPARATED BY SOLID STEEL BEAMS. ALL SHRUB BEDS TO BE SEPARATED BY SOLID STEEL BEAMS.
10. ALL SOUTHERN PINE, SAGE, SHRUB BEDS TO BE SEPARATED BY SOLID STEEL BEAMS.
11. ALL TREES TO BE SPACED WITH WOOD STAKES. FOR 7" CAL. DECIDUOUS TREES AND EVERGREEN TREES OVER 8" CAL. ALL TREES TO BE SPACED WITH WOOD STAKES. FOR 7" CAL. DECIDUOUS TREES AND EVERGREEN TREES OVER 8" CAL. ALL TREES TO BE SPACED WITH WOOD STAKES. FOR 7" CAL. DECIDUOUS TREES AND EVERGREEN TREES OVER 8" CAL.
12. ALL TREES TO BE SPACED WITH WOOD STAKES. FOR 7" CAL. DECIDUOUS TREES AND EVERGREEN TREES OVER 8" CAL.
13. APPROVAL PRIOR TO INSTALLATION.
14. A FINAL LANDSCAPE PLAN AND AN IRRIGATION PLAN, WITH APPLICABLE SUPPORT MATERIAL, MAY BE SUBMITTED AT THE DISCRETION OF THE LANDSCAPE ARCHITECT. APPROVAL OF THE CITY OF COLORADO SPRINGS LANDSCAPE MAINTENANCE AND CARE MANUAL IS REQUIRED PRIOR TO INSTALLATION. APPROVAL OF THE CITY OF COLORADO SPRINGS LANDSCAPE MAINTENANCE AND CARE MANUAL IS REQUIRED PRIOR TO INSTALLATION.
15. INSPECTOR AND APPROVAL. NOTIFICATION FOR IRRIGATION INSPECTION ATTENDANT SHALL BE GIVEN DURING CONSTRUCTION. THE LANDSCAPE ARCHITECT SHALL BE NOTIFIED AT LEAST 48 HOURS PRIOR TO IRRIGATION INSPECTION.
16. CERTIFICATE OF OCCUPANCY FOR THE LANDSCAPE ARCHITECT SHALL BE SUBMITTED AT THE DISCRETION OF THE LANDSCAPE ARCHITECT. APPROVAL OF AN AGENCIES.
17. DEVELOPMENT PLAN SHALL BE SUBMITTED IN A DELAY OF FINAL APPROVAL AND ISSUANCE OF A CERTIFICATE OF OCCUPANCY.
18. ALL CLEAR SPACE SHALL BE MAINTAINED AROUND THE CIRCUMFERENCE OF THE PLANTS. ALL FIRE HYDRANTS SHALL BE MAINTAINED AROUND THE CIRCUMFERENCE OF THE PLANTS. ALL FIRE HYDRANTS SHALL BE MAINTAINED AROUND THE CIRCUMFERENCE OF THE PLANTS. ALL FIRE HYDRANTS SHALL BE MAINTAINED AROUND THE CIRCUMFERENCE OF THE PLANTS.
19. ALL THE SUB-APPROPRIATE CONNECTIONS (FEC) SHALL NOT BE VISIBLE OR PHYSICALLY OBSTRUCTED BY LANDSCAPING.

**PRELIMINARY LANDSCAPE LEGEND**

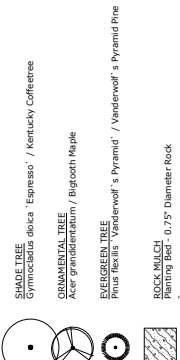

**DECIDUOUS TREE PLANTING DETAIL**



**CONIFEROUS TREE PLANTING DETAIL**

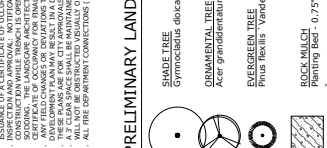

**SHRUB PLANTING DETAIL**



**PERENNIAL / GROUND COVER PLANTING**









N.E.S., Inc.  
619 N. Cascade Avenue, Suite 200  
Colorado Springs, CO 80903  
Tel: 719.471.0073  
Fax: 719.471.0267  
www.nesinc.com

**DOWNTOWN STADIUM**  
FILING NO. 1  
6 CHARRON ST.  
COLORADO SPRINGS,  
CO 80902

ENTITLEMENT

PHOTOMETRIC PLAN  
**10**  
10 OF 10  
CPC CU 10-00102

**New Colorado Springs Stadium - Switchbacks FC USL**  
Colorado Springs, CO

**GRID SUMMARY**

Name:	Property Line
Spacing:	20.0'
Height:	5.0' above grade

**ILLUMINATION SUMMARY**

<b>HORIZONTAL FOOTCANDLES</b>	
Scan Average:	6.2686
Maximum:	24.883
Minimum:	1.296
No. of Points:	92
<b>LUMINAIRE DATA</b>	
Color / CRI:	5700K / 75 CRI
Luminaire Output:	156,100 lumens
No. of Luminaires:	122
Total Load:	170.46 kW

Luminaire Type	160 hrs	170 hrs
TLC-LED-1500	>81,000	>81,000
Reported per TM21-11. See luminaire datasheet for details.		

**Guaranteed Performance:** The ILLUMINATION described above is guaranteed per your Musco Warranty document.

**Field Measurements:** Individual field measurements may vary from computer-calculated predictions and should be taken in accordance with IESNA RP-6-15.

**Electrical System Requirements:** Refer to Ampenage Draw Chart and/or the "Musco Control System Summary" for additional information.  
**Photometric Requirements:** Results assume a 3% installation tolerance at line side of the driver and structures located within 3 feet (1m) of design locations.

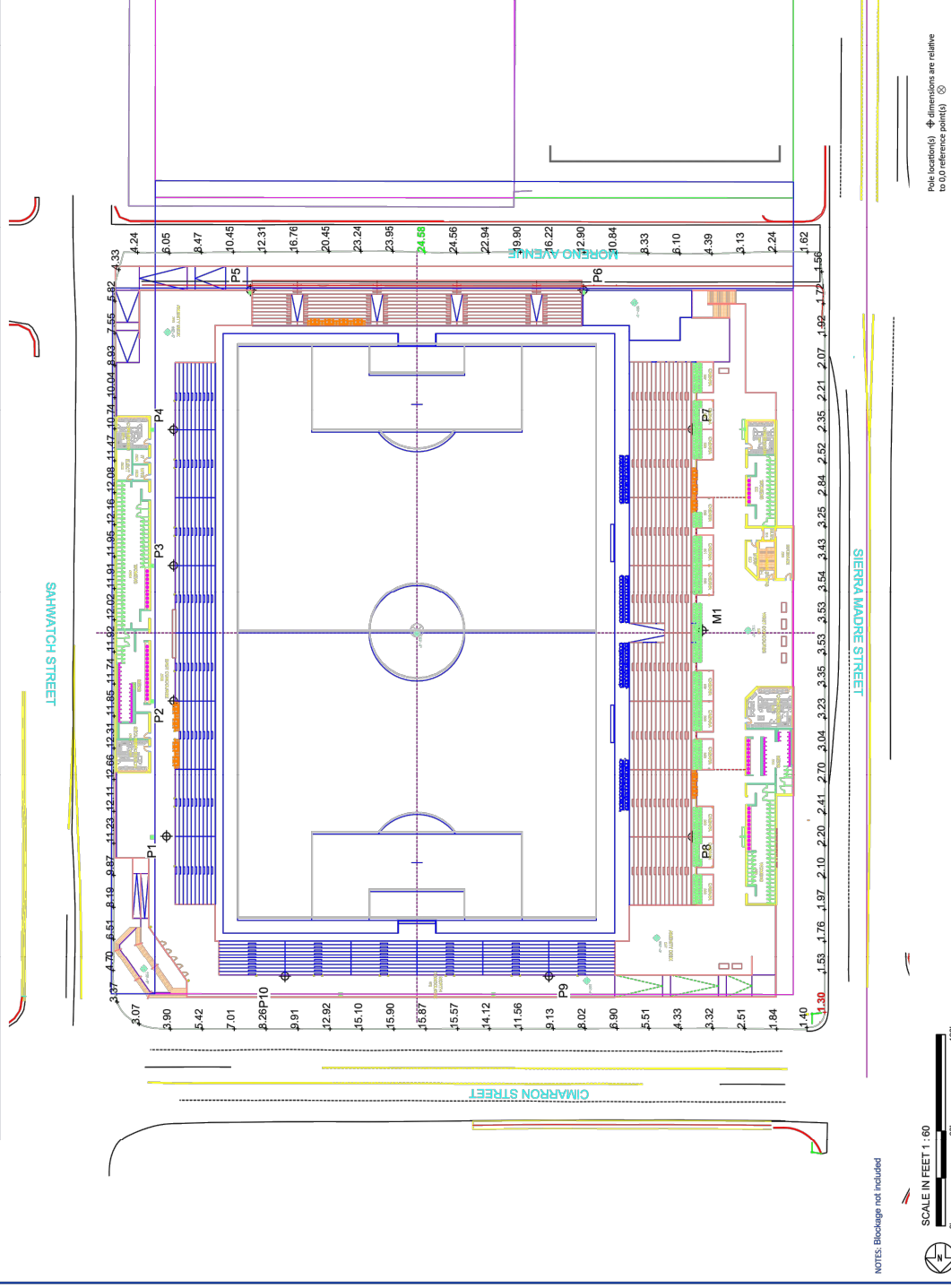

**ILLUMINATION SUMMARY**

Not to be reproduced in whole or part without the written consent of Musco Sports Lighting, LLC. © 2019 Musco Sports Lighting, LLC.



Pole locations (φ) dimensions are relative to 0.0 reference point(s) (0)

SCALE IN FEET 1" = 60'  
0' 60' 120'

ENGINEERED DESIGN By: J. Hermesen • File #190814D spill • 28-Mar-19

FIGURE 1