

Raven's Nest Coffee Shop

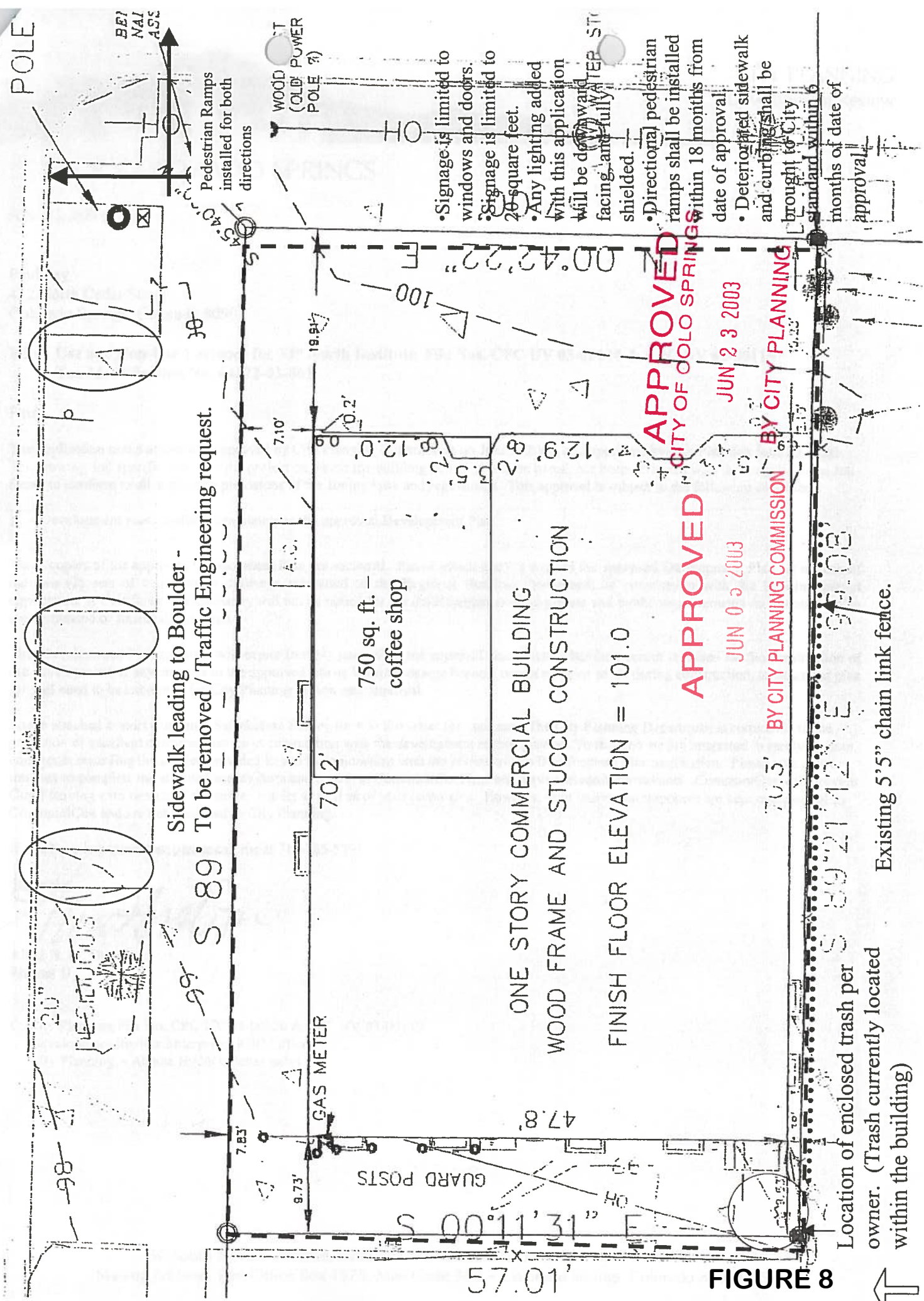

- Signage is limited to windows and doors.
- Signage is limited to 20 square feet.
- Any lighting added with this application will be downward facing and fully shielded.
- Directional pedestrian ramps shall be installed within 18 months from date of approval.
- Deteriorated sidewalk and curbing shall be brought to City standard within 6 months of date of approval.

APPROVED
CITY OF COLO SPRINGS
JUN 23 2003

APPROVED
BY CITY PLANNING COMMISSION
JUN 03 2003

FIGURE 8

