

# Pikes Peak Heights Metropolitan District Service Plan- Update

City Council Hearing  
September 11, 2018

Carl Schueler, Comprehensive Planning Manager  
Representatives of the Petitioner



# Vicinity Map



## PIKES PEAK HEIGHTS VICINITY MAP

NOT TO SCALE

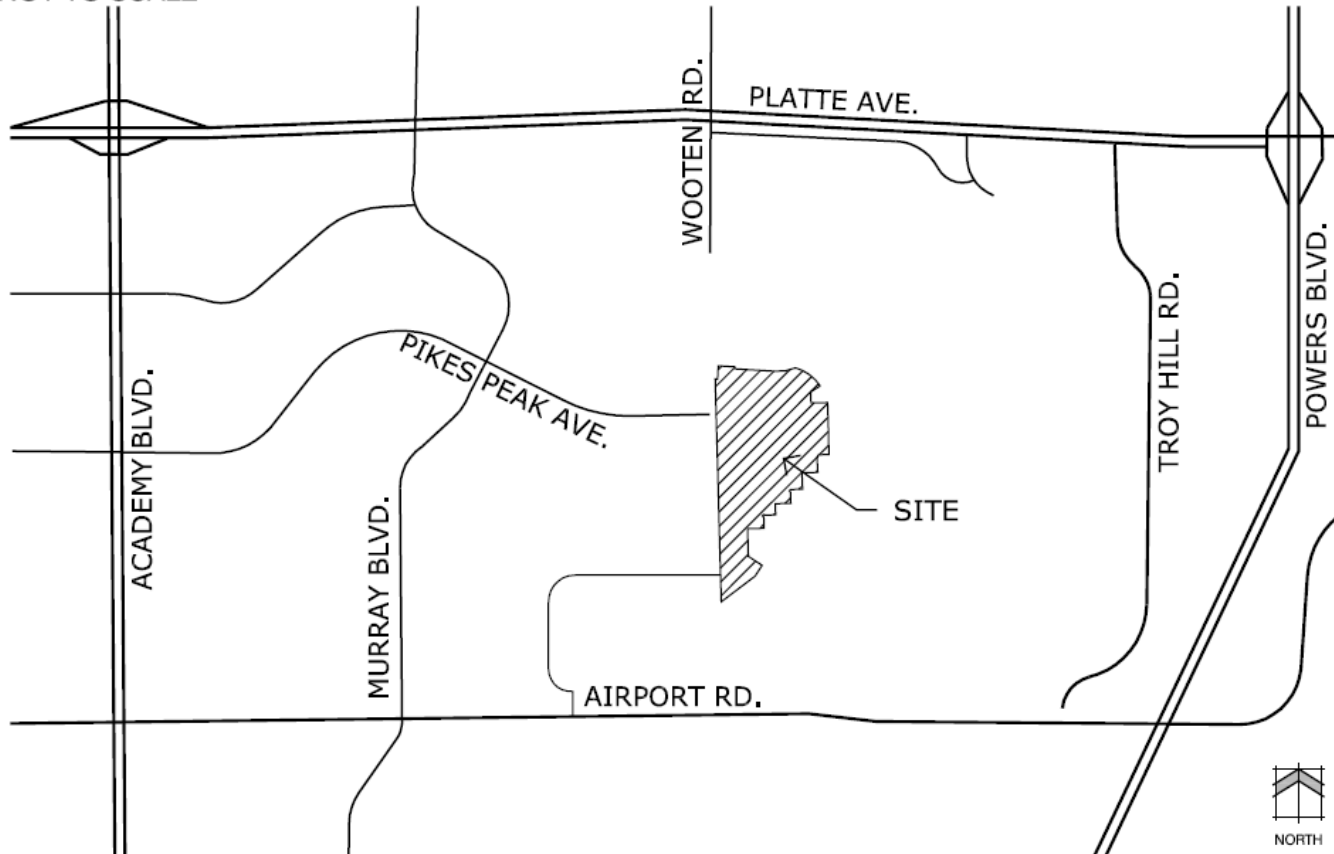

- Maximum Operational Mill Levy Now Reduced to 10.0 Mills (Gallagher Adjusted back to 2006)
  - Had been 15.0 mills
- Resolution paragraph related to retrospective Gallagher Adjustment deleted
- Development status update
  - Section VIII service plan limitations retained
- Still planning on no separate HOA

# Pending Development Plan



PIKES PEAK AVE. AT SAND CREEK  
SITE DEVELOPMENT LAYOUT GRAPHIC  
06-07-2018



# Questions?

