



COLORADO SPRINGS AIRPORT

**CITY COUNCIL BUDGET
COMMITTEE**



Peak Innovation Park Update

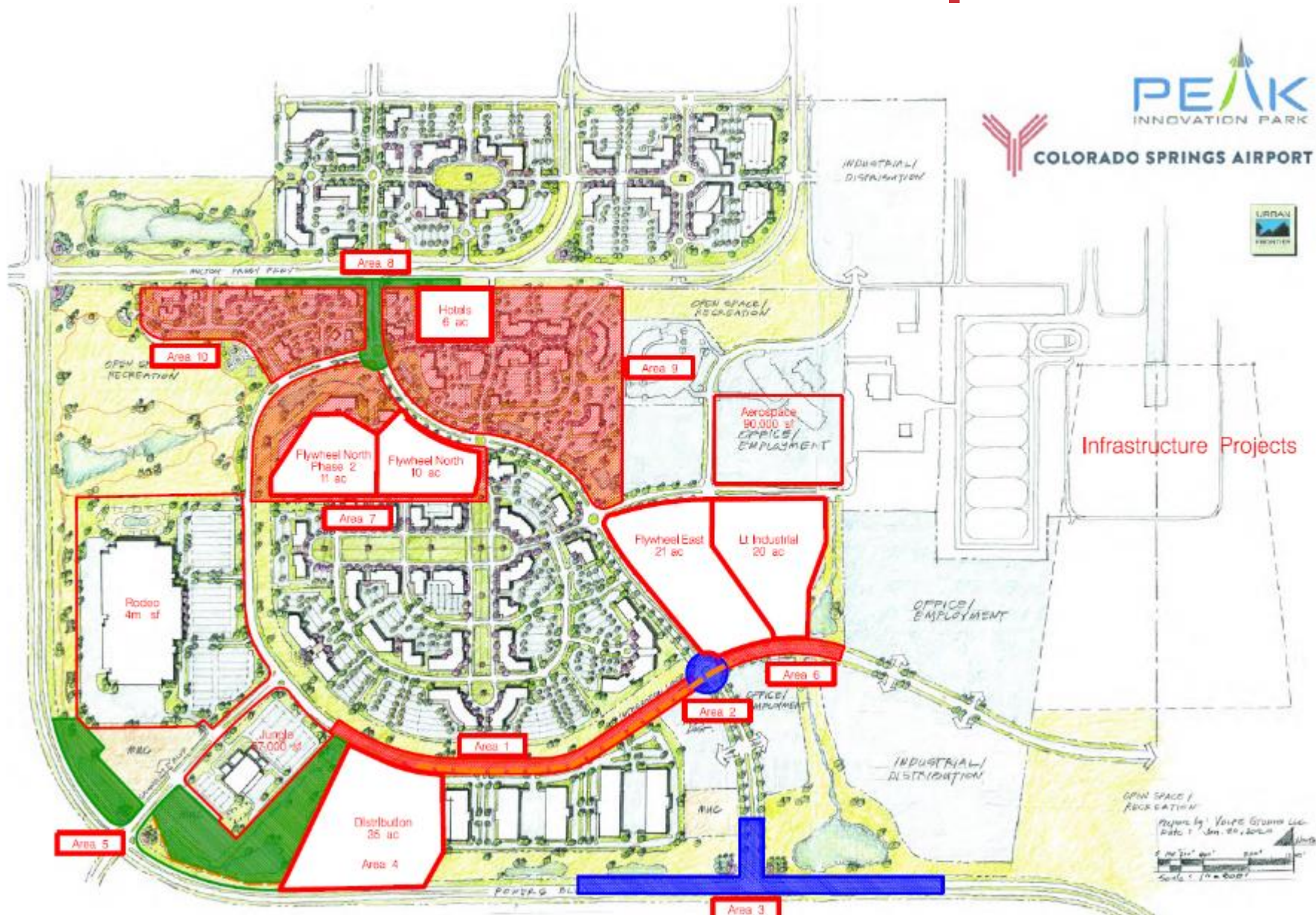

FULFILLMENT CENTER



Amazon Fulfillment Center

- Approximately 3.7M SF building on 70 acres consisting of office, warehouse and distribution

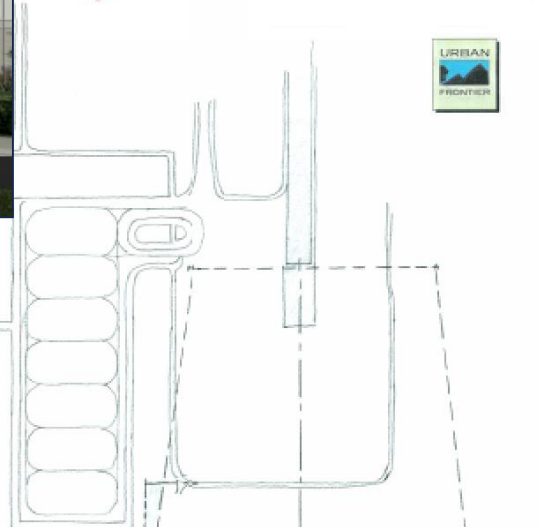

Amazon Last Mile Distribution

- Approximately 68K SF building for office, warehouse and distribution

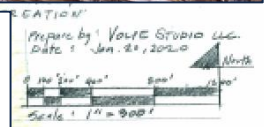

Aerospace Corporation Expansion

- 90,000 SF Office Building

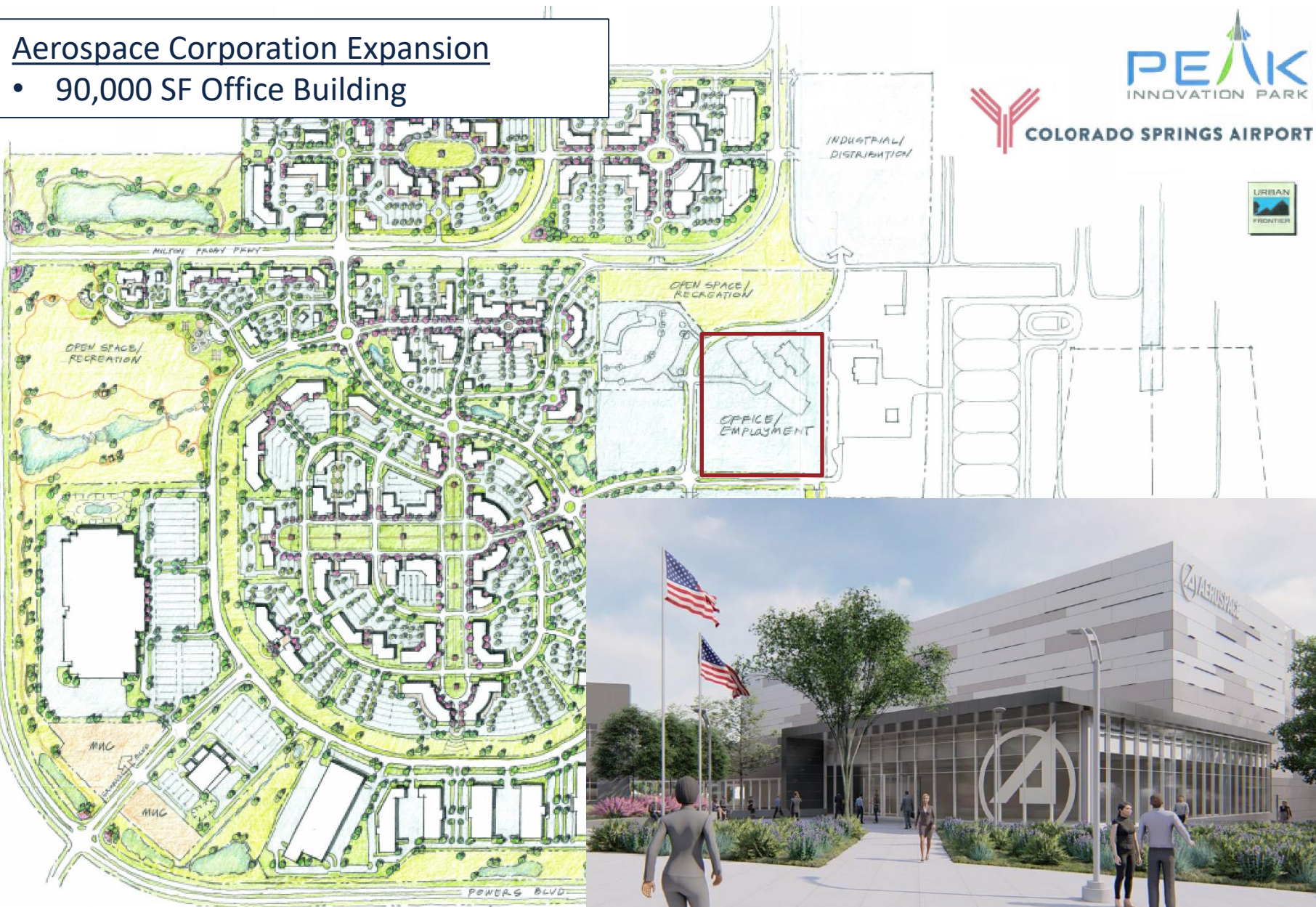

Deicing Ramp

- Airline deicing

USFS Regional Airtanker Base

- 4,706 SF Operations Building
- 4,023 SF Retardant Storage Building
- Mixing Plant -Five 25,000 gallon tanks

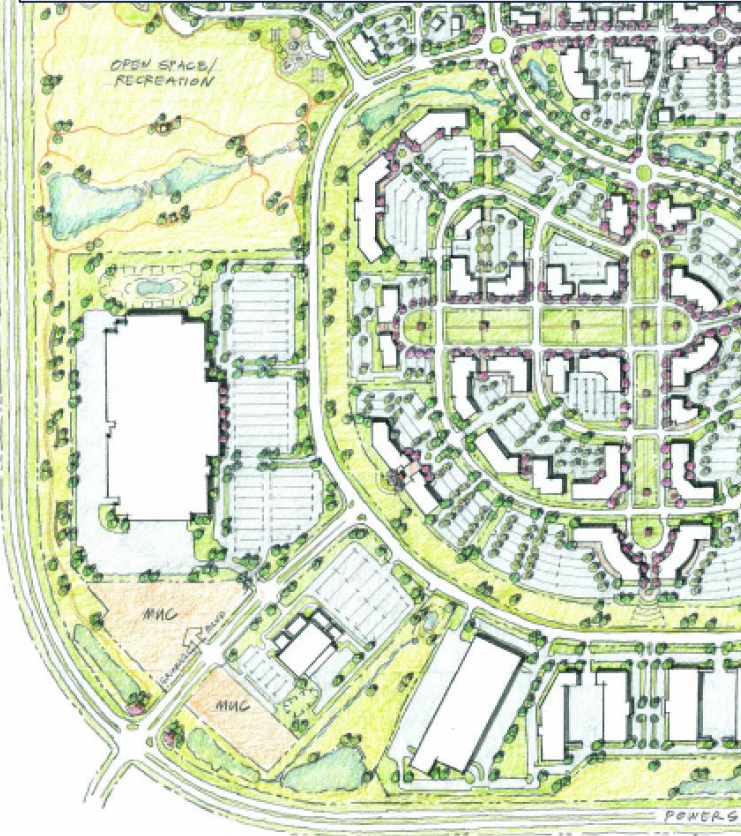
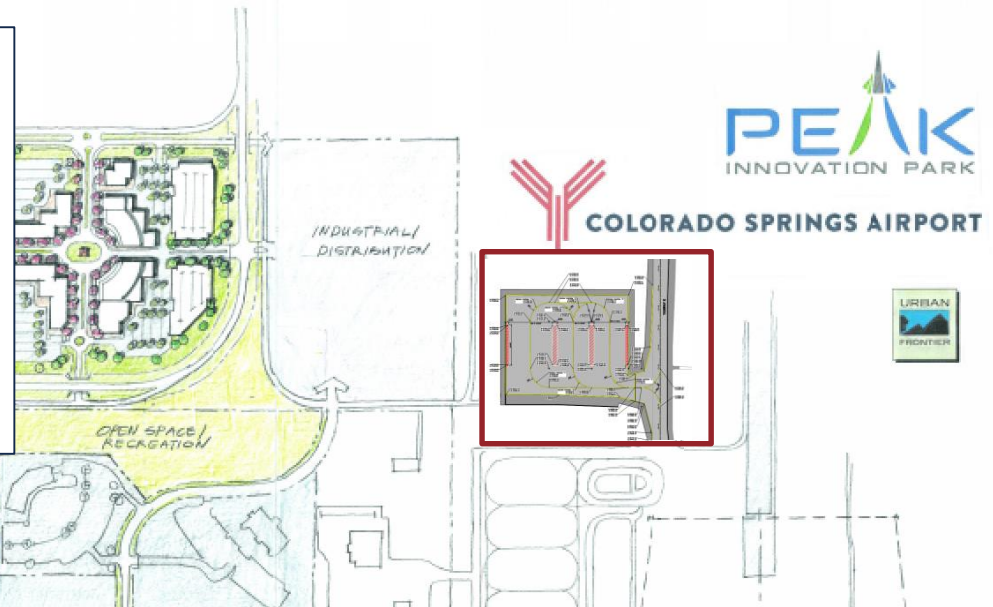

Opportunity Zone

- El Paso County has ranked #8 for the fastest growing opportunity zone and COS plays a large part in that

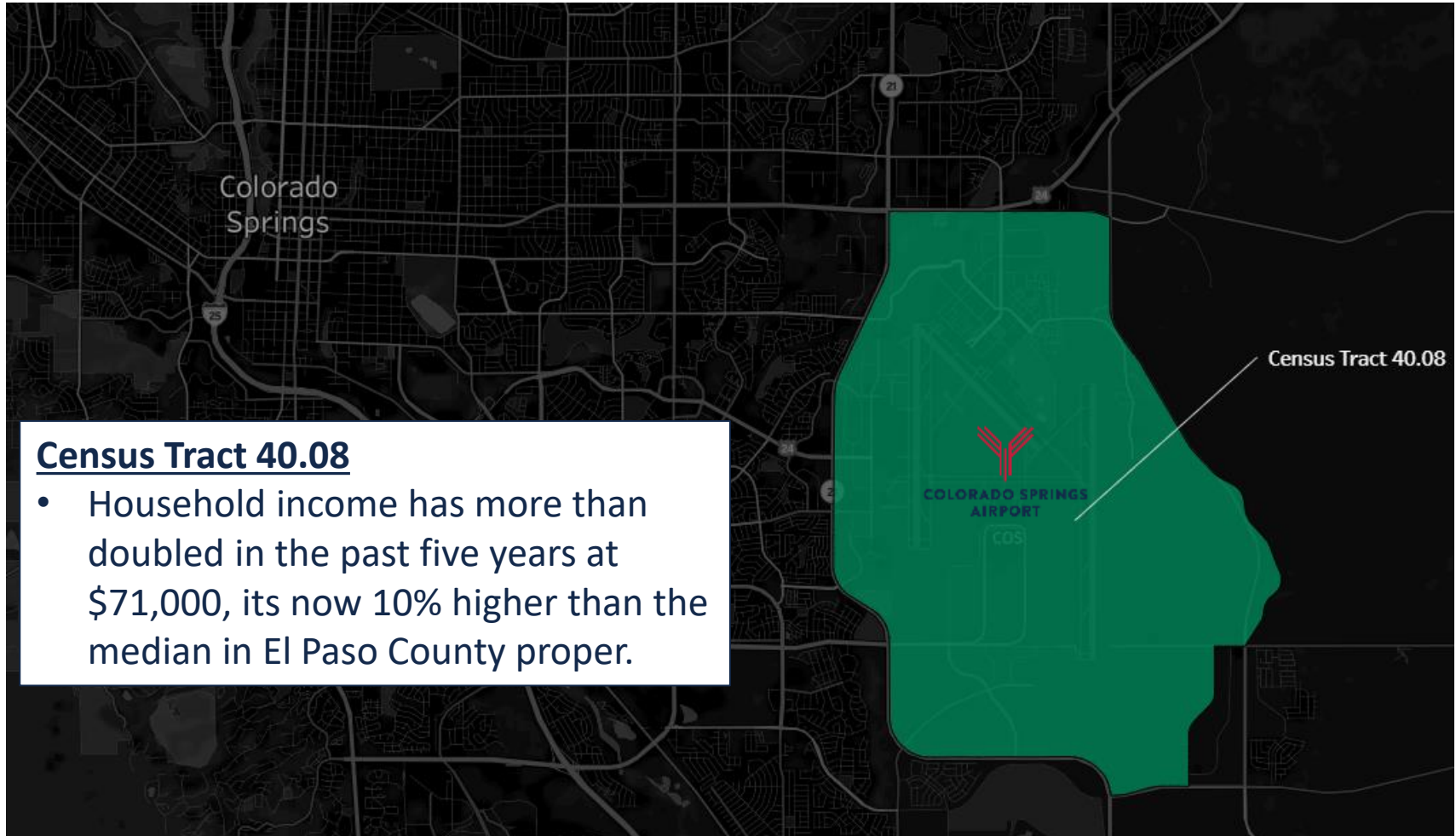

An aerial photograph showing the construction site of Peak Innovation Park. The site is a large, green, undeveloped area with several large, rectangular buildings under construction. The buildings have white roofs and are surrounded by dirt roads and parking lots. The site is bordered by a residential area on the left and a large, white, rectangular building on the right. The text "The 900 acre Peak Innovation Park is just getting started..." is overlaid on the image in a bold, blue, sans-serif font.

**The 900 acre Peak Innovation Park
is just getting started...**