



AUCKLAND ENVIRONMENTAL CONSULTING
 Wetlands • Wildlife • Vegetation

252 Heavy Stone View, Creekside at Rockrimmon
 Colorado Springs, Colorado

Figure 3. Impacts to Wetlands and Open Waters

Legend

- Site Boundary
- Open Water*
- Wetland*
- Sampling Point (SP)
- Culvert and Flow Direction
- ⋯ Upland Break
- WUS Permanent Impact
- Non-WUS Permanent Impact

*Delineated May 21, 2021

Aerial Photo: October 6, 2019
 Figure Revision: June 18, 2021

PREPARED BY:

DREXEL BARRELL & CO.
 Engineers/Architects
 COLORADO SPRINGS, COLORADO 80909
 CONTACT: TERRY MCGONIGLE, P.E.
 BRUNER-COLORADO SPRINGS OFFICE

CLIENT:

PREMIER
 LAND & SURVEYING
 220 N. 17th St., Suite 200
 Pueblo, CO 81001
 (719) 564-2800
 CONTACT: PAUL M. BRUNSSARD

EXHIBIT
**CREEKSIDE AT ROCKRIMMON
 SINGLE-FAMILY FILING NO. 1**
 COLORADO SPRINGS, COLORADO

ISSUE	DATE
INITIAL ISSUE	6/7/21
LATEST ISSUE	6/7/21

DESIGNED BY: SBN
 DRAWN BY: SBN
 CHECKED BY: TM
 FILE NUMBER: 45-COM-ELANDS-24P
 PREPARED UNDER A DIRECT
 CONTRACT WITH THE CITY OF
 COLORADO SPRINGS, COLORADO
 BY DREXEL BARRELL & CO.

DRAWING SCALE:
 HORIZONTAL: 1"=50'
 VERTICAL: 1"=5'

**WETLAND
 PLAN & PROFILE
 EXHIBIT**

PROJECT NO. 2024-06552
 DRAWING NO. **WL1**

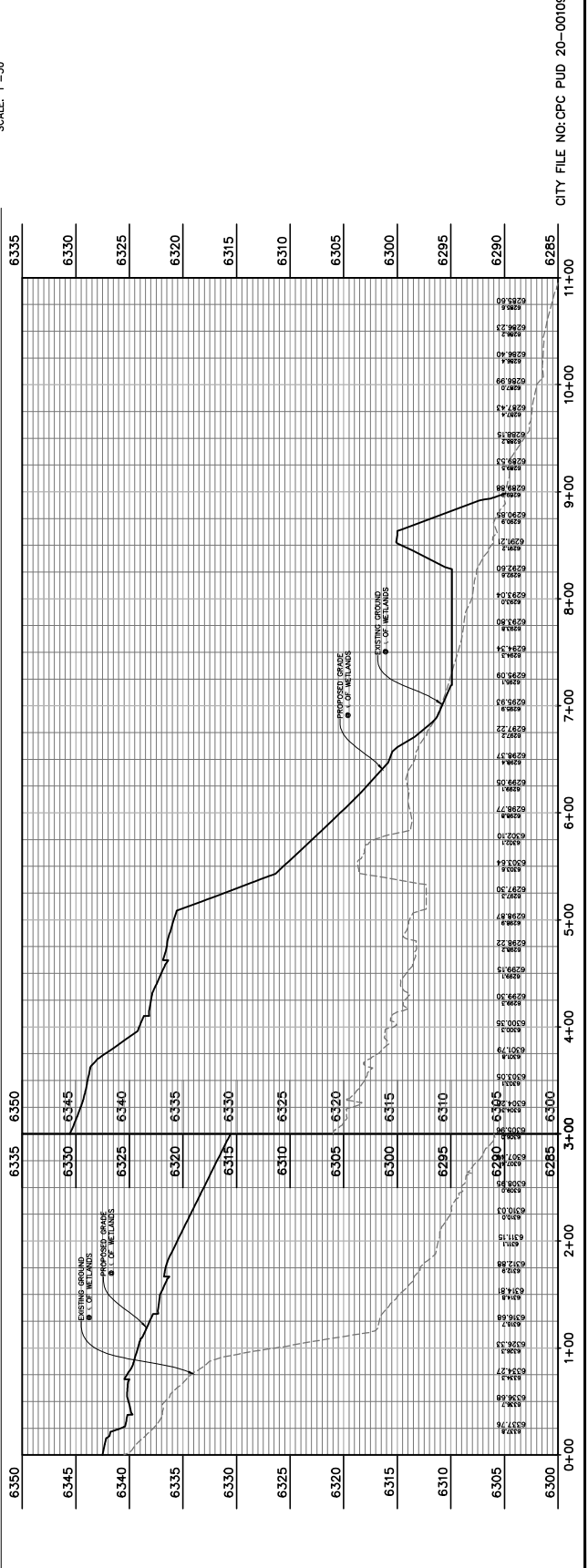
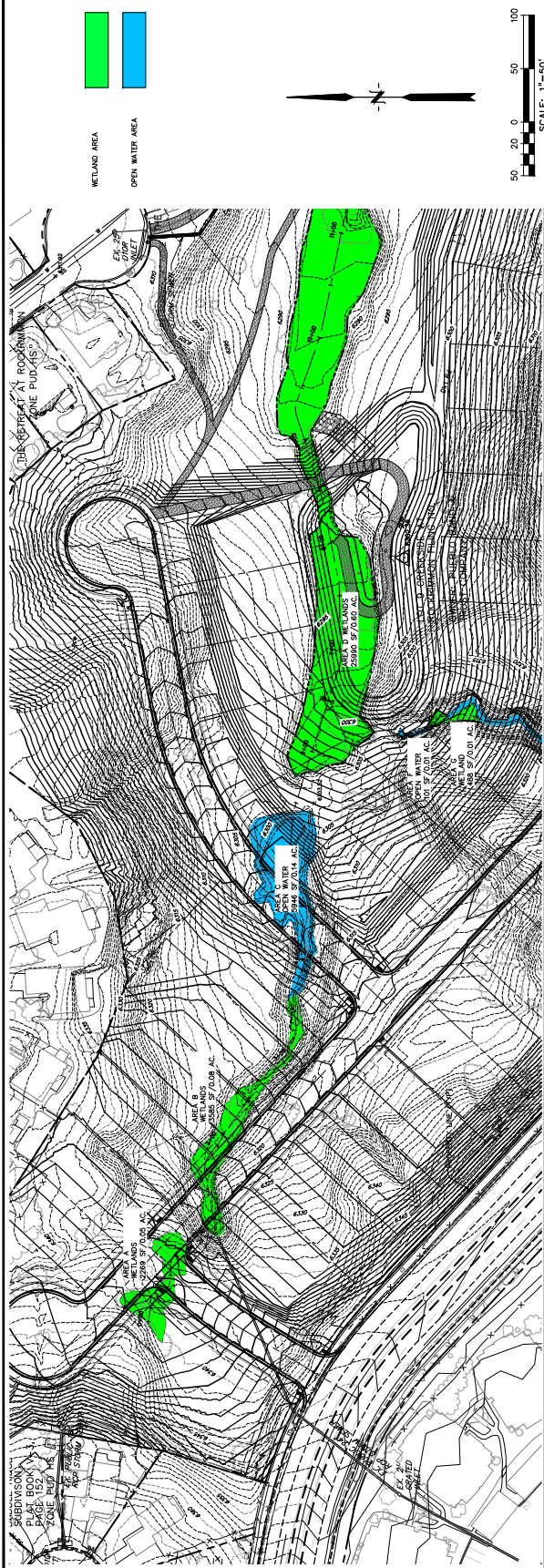

SUBMISSION:
 PLAN BOOK
 PAGE 152
 ZONE 2024-06552