

ORDINANCE NO. 25 - 37

AN ORDINANCE AMENDING THE ZONING MAP OF THE CITY OF COLORADO SPRINGS RELATING TO 3,107.11 ACRES LOCATED SOUTH AND WEST OF THE HIGHWAY 25 AND SOUTH SANTA FE INTERSECTION, ADJACENT TO FORT CARSON ESTABLISHING THE PDZ (PLANNED DEVELOPMENT ZONE; NON-RESIDENTIAL; MAXIMUM SQUARE FOOTAGE OF 7,000,000 SQUARE FEET; MAXIMUM BUILDING HEIGHT OF 120 FEET) DISTRICT

NOW, THEREFORE, BE IT ORDAINED BY THE CITY COUNCIL OF THE CITY OF COLORADO SPRINGS:

Section 1. The zoning map of the City of Colorado Springs is hereby amended by rezoning 3,107.11 acres located south and west of the Highway 25 and South Santa Fe intersection, adjacent to Fort Carson, as described in Exhibit A and depicted in Exhibit B, both of which are attached hereto and made a part hereof, establishing the PDZ (Planned Development Zone; non-Residential; maximum square footage of 7,000,000 square feet; maximum building height of 120 feet) District, pursuant to the Zoning Ordinance of the City of Colorado Springs.

Section 2. This ordinance shall be in full force and effect from and after its passage and publication as provided by Charter.

Section 3. Council deems it appropriate that this ordinance be published by title and summary prepared by the City Clerk and that this ordinance shall be available for inspection and acquisition in the Office of the City Clerk.

Introduced, read, passed on first reading and ordered published this 11th day of March 2025.

Finally passed: March 25, 2025

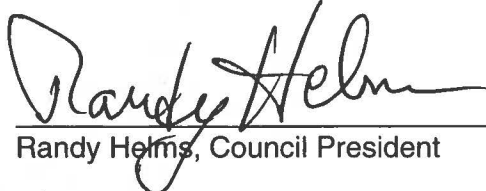
Randy Helms, Council President

ATTEST:

Sarah B. Johnson, City Clerk





212 N Wahsatch Ave, Ste 305
 Colorado Springs, CO 80903
 Mail to: PO Box 1360
 Colorado Springs, CO 80901
 719.955.5485

LEGAL DESCRIPTION
SOUTHERN COLORADO RAIL PARK ADDITION NO. 1
REVISED JANUARY 27, 2025
3,107.113 ACRES

A PARCEL OF LAND BEING THE WEST HALF OF THE SOUTHWEST QUARTER (W1/2 OF SW 1/4) SECTION 19, THE NORTHWEST QUARTER OF THE NORTHWEST QUARTER (NW 1/4 OF NW 1/4) SECTION 30, T16S, R65W, OF THE SIXTH P.M. AND THE SOUTH HALF OF THE SOUTH HALF (S1/2 OF S1/2) SECTION 12, SECTION 13, THE EAST HALF (E 1/2) SECTION 14, THE EAST HALF (E 1/2) SECTION 23, SECTION 24, SECTION 25 AND THE EAST HALF (E 1/2) OF SECTION 26, ALL IN T16S, R66W, OF THE SIXTH P.M., EL PASO COUNTY, COLORADO, EXCEPT THOSE PARTS CONVEYED TO EL PASO COUNTY BY SPECIAL WARRANTY DEEDS RECORDED UNDER RECEPTION NOS. 219042943 AND 219042944, MORE PARTICULARLY DESCRIBED AS FOLLOWS:

BEGINNING AT THE QUARTER CORNER COMMON TO SECTION 14 AND SECTION 23, T16S, R66W, SAID POINT BEING A FOUND STONE, FROM WHICH THE QUARTER CORNER COMMON TO SECTIONS 11 AND SECTION 14, T16S, R66W SAID POINT BEING A FOUND 3.25" ALUMINUM CAP STAMPED "R G OBERING, T16S R66W, S11, 1/4 COR, S14, 1999, PE & PLS 13226" ON A NO. 6 REBAR BEARS N01°30'28"W A DISTANCE OF 5,285.06 FEET, BEING THE BASIS OF ALL BEARINGS IN THIS LEGAL DESCRIPTION. (SAID LINE BEING THE NORTH-SOUTH CENTERLINE OF SAID SECTION 14.)

THE FOLLOWING FOUR (4) COURSES ARE ALONG THE EASTERLY LINES OF THE FORT CARSON MILITARY RESERVATION:

- 1) THENCE N01°30'28"W ALONG THE AFORESAID NORTH-SOUTH CENTERLINE OF SECTION 14, 5,285.06 FEET TO THE QUARTER CORNER COMMON TO SECTIONS 11 AND SECTION 14, T16S, R66W;
- 2) THENCE N88°40'09"E ALONG THE SOUTH LINE OF SAID SECTION 11 A DISTANCE OF 2,788.00 FEET TO THE SECTION CORNER COMMON TO SECTIONS 11, 12, 13, AND 14, T16S, R66W, SAID POINT BEING THE END OF PROJECT, "BOUNDARY RETRACEMENT SURVEY - FORT CARSON, EL PASO COUNTY, COLORADO" RECORDED UNDER RECEPTION NO. 212900048 OF THE RECORDS OF EL PASO COUNTY, COLORADO;
- 3) THENCE N00°39'18"W ALONG THE EAST LINE OF AFORESAID SECTION 11 A DISTANCE OF 1,312.70 FEET;
- 4) THENCE N89°11'58"E A DISTANCE OF 1,197.78 FEET TO THE WESTERLY RIGHT-OF-WAY OF CHARTER OAK RANCH ROAD AS SHOWN ON AFORESAID "BOUNDARY RETRACEMENT SURVEY";

THENCE ALONG THE WESTERLY LINES THEREOF THE FOLLOWING THREE (3) COURSES:

- 1) THENCE 38.00 FEET ALONG THE ARC OF A NON-TANGENT CURVE TO THE LEFT, SAID CURVE HAVING A RADIUS OF 160.00 FEET, A CENTRAL ANGLE OF 13°36'22", THE CHORD OF 37.91 FEET WHICH BEARS S28°08'29"W TO A POINT OF TANGENT;
- 2) THENCE S21°20'19"W A DISTANCE OF 355.09 FEET;

ANEX-24-0013

- 3) THENCE S68°39'41"E A DISTANCE OF 70.00 FEET TO THE SOUTHERLY LINE OF THAT PARCEL DESCRIBED BY SPECIAL WARRANTY DEED UNDER RECEPTION NO. 219042943 OF THE RECORDS OF EL PASO COUNTY, COLORADO;

THENCE ALONG THE SOUTHERLY LINES THEREOF THE FOLLOWING THREE (3) COURSES:

- 1) THENCE 646.18 FEET ALONG THE ARC OF A NON-TANGENT CURVE TO THE RIGHT, SAID CURVE HAVING A RADIUS OF 540.00 FEET, A CENTRAL ANGLE OF 68°33'42", THE CHORD OF 608.31 FEET WHICH BEARS N55°37'10"E TO A POINT OF TANGENT;
- 2) THENCE N89°54'02"E A DISTANCE OF 356.58 FEET;
- 3) THENCE N88°26'46"E A DISTANCE OF 623.16 FEET TO THE SOUTHWEST CORNER OF THAT PARCEL DESCRIBED BY SPECIAL WARRANTY DEED UNDER RECEPTION NO. 219042944 OF THE RECORDS OF EL PASO COUNTY, COLORADO;

THENCE ALONG THE SOUTHERLY LINES THEREOF THE FOLLOWING SIX (6) COURSES:

- 1) THENCE CONTINUING N88°26'46"E A DISTANCE OF 224.24 FEET;
- 2) THENCE N89°38'21"E A DISTANCE OF 293.10 FEET;
- 3) THENCE N89°04'51"E A DISTANCE OF 753.88 FEET;
- 4) THENCE N86°07'34"E A DISTANCE OF 381.70 FEET;
- 5) THENCE N86°06'37"E A DISTANCE OF 476.16 FEET;
- 6) THENCE N86°06'40"E A DISTANCE OF 471.02 FEET TO THE WESTERLY LINE OF LOT 1 BLOCK 1 "VALLEY VIEW SUBDIVISION" AS RECORDED IN PLAT BOOK O-3 AT PAGE 57 IN THE RECORDS OF EL PASO COUNTY, COLORADO;

THENCE ALONG SAID WESTERLY LINE THE FOLLOWING FIVE (5) COURSES:

- 1) THENCE S00°57'56"E A DISTANCE OF 25.58 FEET TO THE SOUTH SIXTEENTH CORNER COMMON TO SECTION 7 T16S, R65W AND SECTION 12, T16S, R66W;
- 2) THENCE CONTINUING S00°57'56"E A DISTANCE OF 1,329.72 FEET TO THE SECTION CORNER COMMON TO SECTIONS 7 AND 18, T16S, R65W AND SECTIONS 12 AND 13, T16S, R66W;
- 3) THENCE S00°59'15"E A DISTANCE OF 2,639.23 FEET TO THE QUARTER CORNER (1/4 COR) COMMON TO SECTION 18, T16S, R65W AND SECTION 13, T16S, R66W;
- 4) THENCE S00°59'25"E A DISTANCE OF 2,639.15 FEET TO THE SECTION CORNER COMMON TO SECTIONS 18 AND 19, T16S, R65W AND SECTIONS 13 AND 24, T16S, R66W;
- 5) THENCE S00°46'56"E A DISTANCE OF 2,617.07 FEET TO THE QUARTER CORNER (1/4 COR) COMMON TO SECTION 24, T16S, R66W AND SECTION 19, T16S, R65W AND THE SOUTHWEST CORNER OF SAID LOT 1 BLOCK 1 "VALLEY VIEW SUBDIVISION";

THENCE N89°21'33"E ALONG THE SOUTH LINE THEREOF, SAID LINE BEING A PORTION OF EAST-WEST CENTERLINE OF SAID SECTION 19, T16S, R65W 1,171.75 FEET TO THE WEST SIXTEENTH CORNER OF SAID SECTION 19;

THENCE S00°51'32"E A DISTANCE OF 2,637.30 FEET TO THE WEST SIXTEENTH CORNER COMMON TO SAID SECTION 19 AND SECTION 30, T16S, R65W;

THENCE S00°20'16"E A DISTANCE OF 1,320.03 FEET TO THE NORTHWEST SIXTEENTH CORNER OF SAID SECTION 30;

THENCE S89°13'59"W A DISTANCE OF 1,155.32 FEET TO THE NORTH SIXTEENTH CORNER OF THE SECTION LINE COMMON TO SECTION 30, T16S, R65W AND SECTION 25, T16S, R66W;

THENCE S01°04'10"E ALONG SAID SECTION LINE 1,326.55 FEET TO THE QUARTER CORNER COMMON TO SAID SECTIONS;

THENCE S00°39'21"E ALONG SAID SECTION LINE 2,640.17 FEET TO THE SECTION CORNER COMMON TO SECTIONS 30 AND 31, T16S, R65W AND SECTIONS 25 AND 36, T16S, R66W, SAID POINT LYING ON THE AFORESAID EASTERLY LINES OF THE FORT CARSON MILITARY RESERVATION;

ANEX-24-0013

THENCE ALONG SAID EASTERLY LINES THE FOLLOWING FOUR (4) COURSES:

- 1) THENCE S89°36'51"W ALONG THE SECTION LINE BETWEEN SAID SECTIONS 25 AND 36 A DISTANCE OF 5,275.28 FEET TO THE SECTION CORNER COMMON TO SECTIONS 25, 26, 35 AND 36, T16S, R66W;
- 2) THENCE S89°07'11"W ALONG THE SECTION LINE COMMON TO SECTIONS 26 AND 35, A DISTANCE OF 2,637.64 FEET TO THE QUARTER CORNER COMMON TO SAID SECTIONS 26 AND 35;
- 3) THENCE N01°34'52"W ALONG THE NORTH SOUTH CENTERLINE OF SAID SECTION 26, 5,263.81 FEET TO THE QUARTER CORNER COMMON TO SECTIONS 23 AND 26, T16S, R66W;
- 4) THENCE N00°25'00"W ALONG THE NORTH SOUTH CENTERLINE OF SAID SECTION 23, 5,230.86 FEET TO THE POINT OF BEGINNING.

SAID PARCEL CONTAINS A GROSS AREA OF 137,084,509 SQUARE FEET (3,147.027 ACRES, MORE OR LESS).

EXCEPTING THEREFROM THE FOLLOWING TWO (2) EXCEPTIONS:

EXCEPTION 'A':

THE SOUTHWEST QUARTER OF THE SOUTHWEST QUARTER OF THE SOUTHWEST QUARTER (SW 1/4 SW 1/4 SW 1/4) AND THE SOUTHEAST QUARTER OF THE SOUTHWEST QUARTER OF THE SOUTHWEST QUARTER (SE 1/4 SW 1/4 SW 1/4) OF SECTION 13 AS DESCRIBED IN QUITCLAIM DEED RECORDED UNDER RECEPTION NO. 209137369;

AND

THE SOUTH HALF OF THE NORTHEAST QUARTER OF THE SOUTHWEST QUARTER OF THE SOUTHWEST QUARTER (S 1/2 NE 1/4 SW 1/4 SW 1/4) OF SAID SECTION 13 AS DESCRIBED IN WARRANTY DEED RECORDED IN BOOK 5826 AT PAGE 208, EXCEPTING THEREFROM THE EASTERLY 30 FEET OF THAT 60 FEET WIDE INGESS/EGRESS EASEMENT DESCRIBED IN DESIGNATION OF RIGHTS OF WAY RECORDED IN BOOK 2395 AT PAGE 377;

AND

THE NORTH HALF OF THE NORTHEAST QUARTER OF THE SOUTHWEST QUARTER OF THE SOUTHWEST QUARTER (N 1/2 NE 1/4 SW 1/4 SW 1/4) OF SAID SECTION 13 DESCRIBED AS "PARCEL B" IN WARRANTY DEED UNDER RECORDED RECEPTION NO. 210059631, EXCEPTING THEREFROM THE EASTERLY 30 FEET OF THAT 60 FEET WIDE INGESS/EGRESS EASEMENT DESCRIBED IN DESIGNATION OF RIGHTS OF WAY RECORDED IN BOOK 2395 AT PAGE 377;

ALL DOCUMENTS FOUND IN THE RECORDS OF EL PASO COUNTY, COLORADO, AND MORE PARTICULARLY DESCRIBED AS FOLLOWS:

BEGINNING AT THE SECTION CORNER COMMON TO SECTIONS 13, 14, 23, AND 24, SAID CORNER BEING MONUMENTED WITH A 3.25" ALUMINUM CAP WITHOUT STAMPS;

THENCE N00°30'22"W ALONG THE SECTION LINE COMMON TO SAID SECTIONS 13 AND 14, 659.62 FEET TO A BENT NO. 5 REBAR WITHOUT CAP;

THENCE N88°38'46"E A DISTANCE OF 658.63 FEET TO THE SOUTHWEST CORNER OF SAID NORTHEAST QUARTER OF THE SOUTHWEST QUARTER OF THE SOUTHWEST QUARTER OF SECTION 13;

THENCE N00°30'34"W ALONG THE WEST LINE THEREOF, 659.83 FEET TO THE NORTHWEST CORNER OF SAID NORTHEAST QUARTER OF THE SOUTHWEST QUARTER OF THE SOUTHWEST QUARTER OF SECTION 13;

THENCE N88°33'19"E ALONG THE NORTH LINE THEREOF, 658.50 FEET TO A NO. 3 REBAR WITH RED PLASTIC CAP STAMPED "LS 1593";

THENCE S00°31'35"E A DISTANCE OF 1,320.88 FEET TO A NO. 3 REBAR WITH RED PLASTIC CAP STAMPED "LS 1593";

THENCE S88°39'48"W A DISTANCE OF 1,317.54 FEET TO THE POINT OF BEGINNING.

SAID PARCELS CONTAINING A COMBINED AREA OF 1,304,015 SQUARE FEET (29.936 ACRES, MORE OR LESS).

ANEX-24-0013

EXCEPTION 'B':

A PORTION OF THE NORTHEAST QUARTER OF THE NORTHWEST QUARTER OF THE SOUTHWEST QUARTER OF SECTION 13, T16S, R66W AS DESCRIBED IN WARRANTY DEED RECORDED UNDER RECEPTION NO. 219082791, EXCEPTING THEREFROM THE EASTERLY 30 FEET OF THAT 60 FEET WIDE INGESS/EGRESS EASEMENT DESCRIBED IN DESIGNATION OF RIGHTS OF WAY RECORDED IN BOOK 2395 AT PAGE 377;

AND

A PORTION OF THE NORTHEAST QUARTER OF THE NORTHWEST QUARTER OF THE SOUTHWEST QUARTER OF SECTION 13, T16S, R66W AS DESCRIBED AS "PARCEL A" IN WARRANTY DEED RECORDED UNDER RECEPTION NO. 210059631, EXCEPTING THEREFROM THE EASTERLY 30 FEET OF THAT 60 FEET WIDE INGESS/EGRESS EASEMENT DESCRIBED IN DESIGNATION OF RIGHTS OF WAY RECORDED IN BOOK 2395 AT PAGE 377;
ALL DOCUMENTS FOUND IN THE RECORDS OF EL PASO COUNTY, COLORADO, AND MORE PARTICULARLY DESCRIBED AS FOLLOWS:

COMMENCING AT THE QUARTER CORNER COMMON TO SECTIONS 13 AND 14, SAID QUARTER CORNER BEING MONUMENTED BY A BENT NO. 5 REBAR WITHOUT CAP;
THENCE N88°39'52"E A DISTANCE OF 658.34 FEET TO THE NORTHWEST CORNER OF THE NORTHEAST QUARTER OF THE NORTHWEST QUARTER OF THE SOUTHWEST QUARTER OF SECTION 13, AND THE POINT OF BEGINNING;

THENCE N88°40'01"E ALONG THE NORTH LINE THEREOF, 661.09 FEET TO THE NORTHEAST CORNER OF AFORESAID NORTHEAST QUARTER OF THE NORTHWEST QUARTER OF THE SOUTHWEST QUARTER OF SECTION 13;
THENCE S00°05'37"E ALONG THE EAST LINE THEREOF, 328.97 FEET TO A NO. 3 REBAR WITHOUT CAP;
THENCE S00°24'52"E A DISTANCE OF 330.21 FEET TO A NO. 3 REBAR WITHOUT CAP, BEING THE SOUTHEAST CORNER OF AFORESAID NORTHEAST QUARTER OF THE NORTHWEST QUARTER OF THE SOUTHWEST QUARTER OF SECTION 13;
THENCE S88°36'23"W ALONG THE SOUTH LINE THEREOF, 658.17 FEET TO THE SOUTHWEST CORNER OF SAID NORTHEAST QUARTER OF THE NORTHWEST QUARTER OF THE SOUTHWEST QUARTER OF SECTION 13;
THENCE N00°30'34"W ALONG THE WEST LINE THEREOF, 659.83 FEET TO THE POINT OF BEGINNING.

SAID PROPERTIES COMBINED CONTAINING AN AREA OF 434,661 SQUARE FEET (9.978 ACRES, MORE OR LESS).

GROSS AREA 137,084,509 SQUARE FEET (3,147.027 ACRES, MORE OR LESS),
LESS EXCEPTION 'A' AREA OF 1,304,015 SQUARE FEET (29.936 ACRES, MORE OR LESS)
LESS EXCEPTION 'B' AREA OF 434,661 SQUARE FEET (9.978 ACRES, MORE OR LESS)
NET AREA 135,345,833 SQUARE FEET (3,107.113 ACRES MORE OR LESS).

PREPARED BY:

VERNON P. TAYLOR, COLORADO P.L.S. NO. 25966
FOR AND ON BEHALF OF M&S CIVIL CONSULTANTS, INC

DATE

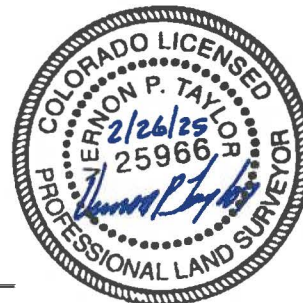

N.E.S. Inc.
619 N. Cascade Avenue, Suite 200
Colorado Springs, CO 80903
Tel. 719.471.0073
Fax 719.471.0267
www.nescolorado.com
© 2003 All Rights Reserved.

ZONE MAP AMENDMENT

EAST OF FORT CARSON, WEST OF I-25,
SOUTH OF CHARTER OAK RANCH ROAD

DATE:	11/18/2024
PROJECT NO.:	A. 6806/DW
PREPARED BY:	J. SMITH

15 JULY 2004

DATE	DESCRIPTION	AMOUNT	BALANCE
1/1/01	OPENING BALANCE		100.00
1/15/01	DEPOSIT	50.00	150.00
2/1/01	WITHDRAWAL	25.00	125.00
2/15/01	DEPOSIT	75.00	200.00
3/1/01	WITHDRAWAL	100.00	100.00
3/15/01	DEPOSIT	50.00	150.00
4/1/01	WITHDRAWAL	75.00	75.00
4/15/01	DEPOSIT	25.00	100.00
5/1/01	WITHDRAWAL	50.00	50.00
5/15/01	DEPOSIT	25.00	75.00
6/1/01	WITHDRAWAL	25.00	50.00
6/15/01	DEPOSIT	25.00	75.00
7/1/01	WITHDRAWAL	25.00	50.00
7/15/01	DEPOSIT	25.00	75.00
8/1/01	WITHDRAWAL	25.00	50.00
8/15/01	DEPOSIT	25.00	75.00
9/1/01	WITHDRAWAL	25.00	50.00
9/15/01	DEPOSIT	25.00	75.00
10/1/01	WITHDRAWAL	25.00	50.00
10/15/01	DEPOSIT	25.00	75.00
11/1/01	WITHDRAWAL	25.00	50.00
11/15/01	DEPOSIT	25.00	75.00
12/1/01	WITHDRAWAL	25.00	50.00
12/15/01	DEPOSIT	25.00	75.00
1/1/02	WITHDRAWAL	25.00	50.00
1/15/02	DEPOSIT	25.00	75.00
2/1/02	WITHDRAWAL	25.00	50.00
2/15/02	DEPOSIT	25.00	75.00
3/1/02	WITHDRAWAL	25.00	50.00
3/15/02	DEPOSIT	25.00	75.00
4/1/02	WITHDRAWAL	25.00	50.00
4/15/02	DEPOSIT	25.00	75.00
5/1/02	WITHDRAWAL	25.00	50.00
5/15/02	DEPOSIT	25.00	75.00
6/1/02	WITHDRAWAL	25.00	50.00
6/15/02	DEPOSIT	25.00	75.00
7/1/02	WITHDRAWAL	25.00	50.00
7/15/02	DEPOSIT	25.00	75.00
8/1/02	WITHDRAWAL	25.00	50.00
8/15/02	DEPOSIT	25.00	75.00
9/1/02	WITHDRAWAL	25.00	50.00
9/15/02	DEPOSIT	25.00	75.00
10/1/02	WITHDRAWAL	25.00	50.00
10/15/02	DEPOSIT	25.00	75.00
11/1/02	WITHDRAWAL	25.00	50.00
11/15/02	DEPOSIT	25.00	75.00
12/1/02	WITHDRAWAL	25.00	50.00
12/15/02	DEPOSIT	25.00	75.00
1/1/03	WITHDRAWAL	25.00	50.00
1/15/03	DEPOSIT	25.00	75.00
2/1/03	WITHDRAWAL	25.00	50.00
2/15/03	DEPOSIT	25.00	75.00
3/1/03	WITHDRAWAL	25.00	50.00
3/15/03	DEPOSIT	25.00	75.00
4/1/03	WITHDRAWAL	25.00	50.00
4/15/03	DEPOSIT	25.00	75.00
5/1/03	WITHDRAWAL	25.00	50.00
5/15/03	DEPOSIT	25.00	75.00
6/1/03	WITHDRAWAL	25.00	50.00
6/15/03	DEPOSIT	25.00	75.00
7/1/03	WITHDRAWAL	25.00	50.00
7/15/03	DEPOSIT	25.00	75.00
8/1/03	WITHDRAWAL	25.00	50.00
8/15/03	DEPOSIT	25.00	75.00
9/1/03	WITHDRAWAL	25.00	50.00
9/15/03	DEPOSIT	25.00	75.00
10/1/03	WITHDRAWAL	25.00	50.00
10/15/03	DEPOSIT	25.00	75.00
11/1/03	WITHDRAWAL	25.00	50.00
11/15/03	DEPOSIT	25.00	75.00
12/1/03	WITHDRAWAL	25.00	50.00
12/15/03	DEPOSIT	25.00	75.00
1/1/04	WITHDRAWAL	25.00	50.00
1/15/04	DEPOSIT	25.00	75.00
2/1/04	WITHDRAWAL	25.00	50.00
2/15/04	DEPOSIT	25.00	75.00
3/1/04	WITHDRAWAL	25.00	50.00
3/15/04	DEPOSIT	25.00	75.00
4/1/04	WITHDRAWAL	25.00	50.00
4/15/04	DEPOSIT	25.00	75.00
5/1/04	WITHDRAWAL		

Component	1994-1995	1996-1997
Component	1994-1995	1996-1997

EXHIBIT B

100



h

	1	2	3	4	5	6	7	8	9	10	11	12	13	14	15	16	17	18	19	20	21	22	23	24	25	26	27	28	29	30	31	32	33	34	35	36	37	38	39	40	41	42	43	44	45	46	47	48	49	50	51	52	53	54	55	56	57	58	59	60	61	62	63	64	65	66	67	68	69	70	71	72	73	74	75	76	77	78	79	80	81	82	83	84	85	86	87	88	89	90	91	92	93	94	95	96	97	98	99	100	101	102	103	104	105	106	107	108	109	110	111	112	113	114	115	116	117	118	119	120	121	122	123	124	125	126	127	128	129	130	131	132	133	134	135	136	137	138	139	140	141	142	143	144	145	146	147	148	149	150	151	152	153	154	155	156	157	158	159	160	161	162	163	164	165	166	167	168	169	170	171	172	173	174	175	176	177	178	179	180	181	182	183	184	185	186	187	188	189	190	191	192	193	194	195	196	197	198	199	200	201	202	203	204	205	206	207	208	209	210	211	212	213	214	215	216	217	218	219	220	221	222	223	224	225	226	227	228	229	230	231	232	233	234	235	236	237	238	239	240	241	242	243	244	245	246	247	248	249	250	251	252	253	254	255	256	257	258	259	260	261	262	263	264	265	266	267	268	269	270	271	272	273	274	275	276	277	278	279	280	281	282	283	284	285	286	287	288	289	290	291	292	293	294	295	296	297	298	299	300	301	302	303	304	305	306	307	308	309	310	311	312	313	314	315	316	317	318	319	320	321	322	323	324	325	326	327	328	329	330	331	332	333	334	335	336	337	338	339	340	341	342	343	344	345	346	347	348	349	350	351	352	353	354	355	356	357	358	359	360	361	362	363	364	365	366	367	368	369	370	371	372	373	374	375	376	377	378	379	380	381	382	383	384	385	386	387	388	389	390	391	392	393	394	395	396	397	398	399	400	401	402	403	404	405	406	407	408	409	410	411	412	413	414	415	416	417	418	419	420	421	422	423	424	425	426	427	428	429	430	431	432	433	434	435	436	437	438	439	440	441	442	443	444	445	446	447	448	449	450	451	452	453	454	455	456	457	458	459	460	461	462	463	464	465	466	467	468	469	470	471	472	473	474	475	476	477	478	479	480	481	482	483	484	485	486	487	488	489	490	491	492	493	494	495	496	497	498	499	500	501	502	503	504	505	506	507	508	509	510	511	512	513	514	515	516	517	518	519	520	521	522	523	524
--	---	---	---	---	---	---	---	---	---	----	----	----	----	----	----	----	----	----	----	----	----	----	----	----	----	----	----	----	----	----	----	----	----	----	----	----	----	----	----	----	----	----	----	----	----	----	----	----	----	----	----	----	----	----	----	----	----	----	----	----	----	----	----	----	----	----	----	----	----	----	----	----	----	----	----	----	----	----	----	----	----	----	----	----	----	----	----	----	----	----	----	----	----	----	----	----	----	----	----	-----	-----	-----	-----	-----	-----	-----	-----	-----	-----	-----	-----	-----	-----	-----	-----	-----	-----	-----	-----	-----	-----	-----	-----	-----	-----	-----	-----	-----	-----	-----	-----	-----	-----	-----	-----	-----	-----	-----	-----	-----	-----	-----	-----	-----	-----	-----	-----	-----	-----	-----	-----	-----	-----	-----	-----	-----	-----	-----	-----	-----	-----	-----	-----	-----	-----	-----	-----	-----	-----	-----	-----	-----	-----	-----	-----	-----	-----	-----	-----	-----	-----	-----	-----	-----	-----	-----	-----	-----	-----	-----	-----	-----	-----	-----	-----	-----	-----	-----	-----	-----	-----	-----	-----	-----	-----	-----	-----	-----	-----	-----	-----	-----	-----	-----	-----	-----	-----	-----	-----	-----	-----	-----	-----	-----	-----	-----	-----	-----	-----	-----	-----	-----	-----	-----	-----	-----	-----	-----	-----	-----	-----	-----	-----	-----	-----	-----	-----	-----	-----	-----	-----	-----	-----	-----	-----	-----	-----	-----	-----	-----	-----	-----	-----	-----	-----	-----	-----	-----	-----	-----	-----	-----	-----	-----	-----	-----	-----	-----	-----	-----	-----	-----	-----	-----	-----	-----	-----	-----	-----	-----	-----	-----	-----	-----	-----	-----	-----	-----	-----	-----	-----	-----	-----	-----	-----	-----	-----	-----	-----	-----	-----	-----	-----	-----	-----	-----	-----	-----	-----	-----	-----	-----	-----	-----	-----	-----	-----	-----	-----	-----	-----	-----	-----	-----	-----	-----	-----	-----	-----	-----	-----	-----	-----	-----	-----	-----	-----	-----	-----	-----	-----	-----	-----	-----	-----	-----	-----	-----	-----	-----	-----	-----	-----	-----	-----	-----	-----	-----	-----	-----	-----	-----	-----	-----	-----	-----	-----	-----	-----	-----	-----	-----	-----	-----	-----	-----	-----	-----	-----	-----	-----	-----	-----	-----	-----	-----	-----	-----	-----	-----	-----	-----	-----	-----	-----	-----	-----	-----	-----	-----	-----	-----	-----	-----	-----	-----	-----	-----	-----	-----	-----	-----	-----	-----	-----	-----	-----	-----	-----	-----	-----	-----	-----	-----	-----	-----	-----	-----	-----	-----	-----	-----	-----	-----	-----	-----	-----	-----	-----	-----	-----	-----	-----	-----	-----	-----	-----	-----	-----	-----	-----	-----	-----	-----	-----	-----	-----	-----	-----	-----	-----	-----	-----	-----	-----	-----	-----	-----	-----	-----	-----	-----	-----	-----	-----	-----	-----	-----	-----	-----	-----	-----	-----	-----	-----	-----	-----	-----	-----	-----	-----	-----	-----	-----	-----	-----	-----	-----	-----	-----	-----	-----	-----	-----	-----	-----	-----	-----	-----	-----	-----	-----	-----	-----

6000-43-7704

EXHIBIT B

I HEREBY CERTIFY that the foregoing ordinance entitled **“AN ORDINANCE AMENDING THE ZONING MAP OF THE CITY OF COLORADO SPRINGS RELATING TO 3,107.11 ACRES LOCATED SOUTH AND WEST OF THE HIGH-WAY 25 AND SOUTH SANTA FE INTERSECTION, AD-JACENT TO FORT CARSON ESTABLISHING THE PDZ (PLANNED DEVELOPMENT ZONE; NON-RESIDENTIAL; MAXIMUM SQUARE FOOTAGE OF 7,000,000 SQUARE FEET; MAXIMUM BUILDING HEIGHT OF 120 FEET) DISTRICT.”** was introduced and read at a regular meeting of the City Council of the City of Colorado Springs, held on **March 11, 2025**; that said ordinance was finally passed at a regular meeting of the City Council of said City, held on the **25th day of March 2025**, and that the same was published by title and in summary or in full, in accordance with Section 3-80 of Article III of the Charter, a newspaper published and in general circulation in the Gazette, at least ten days before its passage.

IN WITNESS WHEREOF, I have hereunto set my hand and affixed the seal of the City, **25th day of March 2025**.

Sarah B. Johnson, City Clerk

1st Publication Date: **March 14, 2025**

2nd Publication Date: **March 28, 2025**

Effective Date: **April 2, 2025**

Initial: 
City Clerk

