

# BROOKSIDE GARDENS

619-623 W. BROOKSIDE ST.



0

End of parking lot, Southside of complex  
Entry to utility easement



Note:  
Houses  
& backyards  
behind.

Southside utility easement, runs east/west. Southside Bldg. 619 on left, utility pole center



Southside utility easement, runs east/west. South side Bldg. 623 on right. Left fence is backyard of home. NO TRESPASSING!

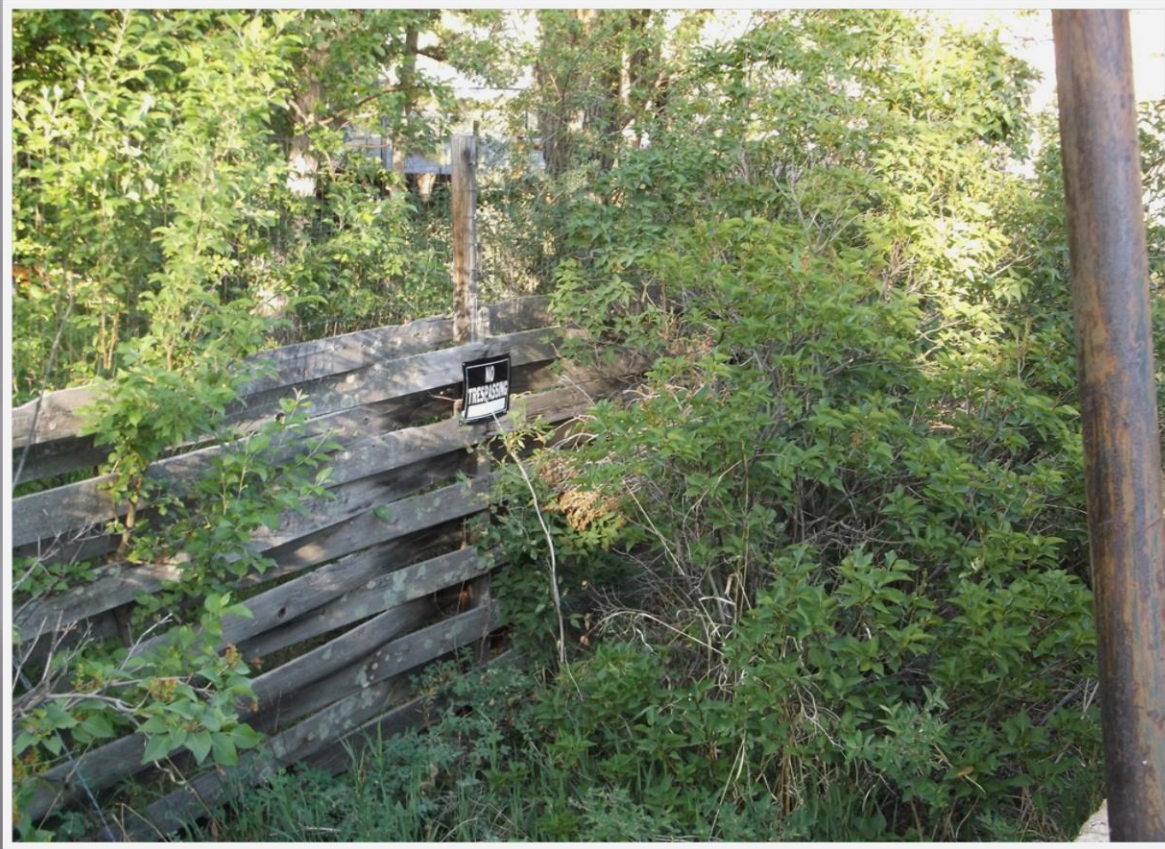

2/29/2022

West side Bldg. 623. Fence on property line approximately 5 feet away. (Before fence was removed.)



N/W corner behind Bldg. 623, proposed lot on right.  
Rt. 16 Bus stop on left, @ W. Brookside



6/15/22

View from Apt D Bedroom window facing west.



Note:  
Consignment  
Store Bldg.  
center &  
Previous  
Chiropractic  
Office & Apts.  
across  
Brookside  
Street. Back  
right CCL  
property  
across 8<sup>th</sup> St..  
Background  
mountain  
view.