



JOB NO. 2081.25-01R2
OCTOBER 1, 2019
REVISED NOVEMBER 4, 2019
REVISED MARCH 23, 2020
PAGE 1 OF 2

619 N. Cascade Avenue, Suite 200 (719) 785-0790
Colorado Springs, Colorado 80903 (719) 785-0799 (Fax)

EXHIBIT A

LEGAL DESCRIPTION: JOVENCHI-I ADDITION NO. 1

A PORTION OF SECTION 21, TOWNSHIP 12 SOUTH, RANGE 66 WEST OF THE SIXTH PRINCIPAL MERIDIAN, EL PASO COUNTY, COLORADO, BEING MORE PARTICULARLY DESCRIBED AS FOLLOWS:

BASIS OF BEARINGS: THE SOUTHERLY BOUNDARY OF DEER CREEK AT NORTHGATE FILING NO. 1, RECORDED UNDER RECEPTION NO. 201078881, RECORDS OF EL PASO COUNTY, COLORADO, BEING MONUMENTED AT THE WESTERLY END BY A 1-1/2 INCH ALUMINUM SURVEYORS CAP STAMPED "JR ENG LTD RLS 32820" FLUSH WITH GROUND AND AT THE EASTERLY END BY A ONE INCH RED PLASTIC CAP "LS 1593" FLUSH WITH GROUND IS ASSUMED TO BEAR S88°58'48"W, A DISTANCE OF 1806.87 FEET.

COMMENCING AT THE SOUTHWESTERLY CORNER OF DEER CREEK AT NORTHGATE FILING NO. 1, RECORDED UNDER RECEPTION NO. 201078881, RECORDS OF EL PASO COUNTY, COLORADO;

THENCE S44°57'12"E, A DISTANCE OF 3455.01 FEET TO A POINT ON CURVE SAID POINT BEING ON THE SOUTHERLY LINE FLYING HORSE RANCH ADDITION RECORDED UNDER RECEPTION NO. 204011499 AND THE NORTHERLY BOUNDARY OF PARCEL 1REXV-E AS DESCRIBED IN A DOCUMENT RECORDED UNDER RECEPTION NO. 205019873 SAID POINT BEING THE POINT OF BEGINNING;

THENCE ON THE ARC OF CURVE TO THE LEFT ON SAID SOUTHERLY LINE OF FLYING HORSE RANCH ADDITION AND SAID NORTHERLY BOUNDARY OF PARCEL 1REXV-E, WHOSE CENTER BEARS N19°52'01"W, HAVING A DELTA OF 44°22'31", A RADIUS OF 1372.50 FEET AND A DISTANCE OF 1062.99 FEET TO A POINT ON CURVE;

THENCE S20°15'38"W, ON THE EASTERLY BOUNDARY OF SAID PARCEL 1REXV-E A DISTANCE OF 235.05 FEET TO A POINT ON THE NORTHERLY BOUNDARY OF PARCEL ONE AS DESCRIBED IN A DOCUMENT RECORDED UNDER RECEPTION NO. 205019873;

THENCE S20°14'46"W, ON THE EASTERLY BOUNDARY OF SAID PARCEL ONE A DISTANCE OF 234.33 FEET TO A POINT ON CURVE SAID POINT BEING THE SOUTHERLY BOUNDARY OF SAID PARCEL ONE AND THE NORTHERLY LINE OF BRIARGATE ADDITION NO. 5, AS DESCRIBED IN A DOCUMENT RECORDED IN PLAT BOOK S-3 AT PAGE 10;

FILE NO. CPC ZC 20-00034

EXHIBIT A

THENCE ON THE ARC OF A CURVE TO THE RIGHT ON SAID SOUTHERLY BOUNDARY OF PARCEL ONE AND THE NORTHERLY LINE OF BRIARGATE ADDITION NO. 5, WHOSE CENTER BEARS N46°00'53"W, HAVING A DELTA OF 17°31'07", A RADIUS OF 1492.50 FEET AND A DISTANCE OF 456.34 FEET TO A POINT ON CURVE SAID POINT BEING THE NORTHWESTERLY CORNER OF SAID BRIARGATE ADDITION NO. 5 AND THE NORTHEASTERLY CORNER OF PARCEL NO. 1REVX-EA AS DESCRIBED IN A DOCUMENT RECORDED UNDER RECEPTION NO. 205019873;
THENCE S00°15'05"W, ON THE WESTERLY LINE OF SAID BRIARGATE ADDITION NO. 5 AND THE EASTERLY BOUNDARY OF SAID PARCEL NO. 1REVX-EA A DISTANCE OF 32.94 FEET TO THE SOUTHEASTERLY CORNER OF SAID PARCEL NO. 1REVX-EA SAID POINT BEING THE NORTHEASTERLY CORNER OF THE RESERVE AT NORTH CREEK ANNEXATION PLAT AS RECORDED UNDER RECEPTION NO. 217713917;
THENCE N76°16'13"W, ON THE SOUTHERLY BOUNDARY OF SAID PARCEL NO. 1REVX-EA AND THE NORTHERLY LINE OF SAID THE RESERVE AT NORTH CREEK ANNEXATION PLAT A DISTANCE OF 43.91 FEET TO THE SOUTHERLY CORNER OF SAID PARCEL 1REVX-E;
THENCE ON THE SOUTHERLY AND WESTERLY BOUNDARY OF SAID PARCEL 1REVX-E BEING ALSO THE NORTHERLY AND EASTERLY LINE OF SAID THE RESERVE AT NORTH CREEK ANNEXATION PLAT THE FOLLOWING (3) THREE COURSES:

1. CONTINUING N76°16'13"W, A DISTANCE OF 10.67 FEET TO A POINT OF CURVE;
2. ON THE ARC OF A CURVE TO THE LEFT, HAVING A DELTA OF 24°15'22", A RADIUS OF 441.27 FEET AND A DISTANCE OF 186.81 FEET TO A POINT ON CURVE;
3. N10°31'34"W, A DISTANCE OF 36.31 FEET TO THE POINT OF BEGINNING.

CONTAINING A CALCULATED AREA OF 2.088 ACRES.

LEGAL DESCRIPTION STATEMENT:

I, DOUGLAS P. REINELT, A LICENSED PROFESSIONAL LAND SURVEYOR IN THE STATE OF COLORADO, DO HEREBY STATE THAT THE ABOVE LEGAL DESCRIPTION WAS PREPARED UNDER MY RESPONSIBLE CHARGE AND ON THE BASIS OF MY KNOWLEDGE, INFORMATION AND BELIEF, IS CORRECT

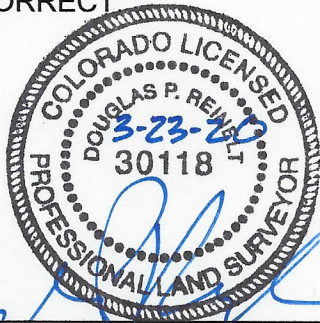

DOUGLAS P. REINELT, PROFESSIONAL LAND SURVEYOR
COLORADO P.L.S. NO. 30118
FOR AND ON BEHALF OF CLASSIC CONSULTING
ENGINEERS AND SURVEYORS

MARCH 23, 2020
DATE

FILE NO. CPC ZC 20-00034

EXHIBIT A