

SPECIAL IMPROVEMENT MAINTENANCE DISTRICTS

November 25, 2014

Kurt Schroeder, Manager, Park Operations and Development
Jon Carlson, SIMD Administrator

OVERVIEW

- There are seven Special Improvement Maintenance Districts (SIMD's) in the City.
- The SIMD's are created by Ordinance and each has a City Council appointed citizen board.

BRIARGATE SIMD

- Created by Ordinance in 1983
- 2014 Revenues: \$854,653
- Assessment: 4.409 mills
- Maintenance responsibilities:
 - Medians, rights of way, open spaces and a park
 - Turf, trees, shrubs, landscape beds and native vegetation
 - Trails, walks, landscape lighting, signage and other amenities
 - 2015 Projects: tree planting, turf conversions

BRIARGATE SIMD

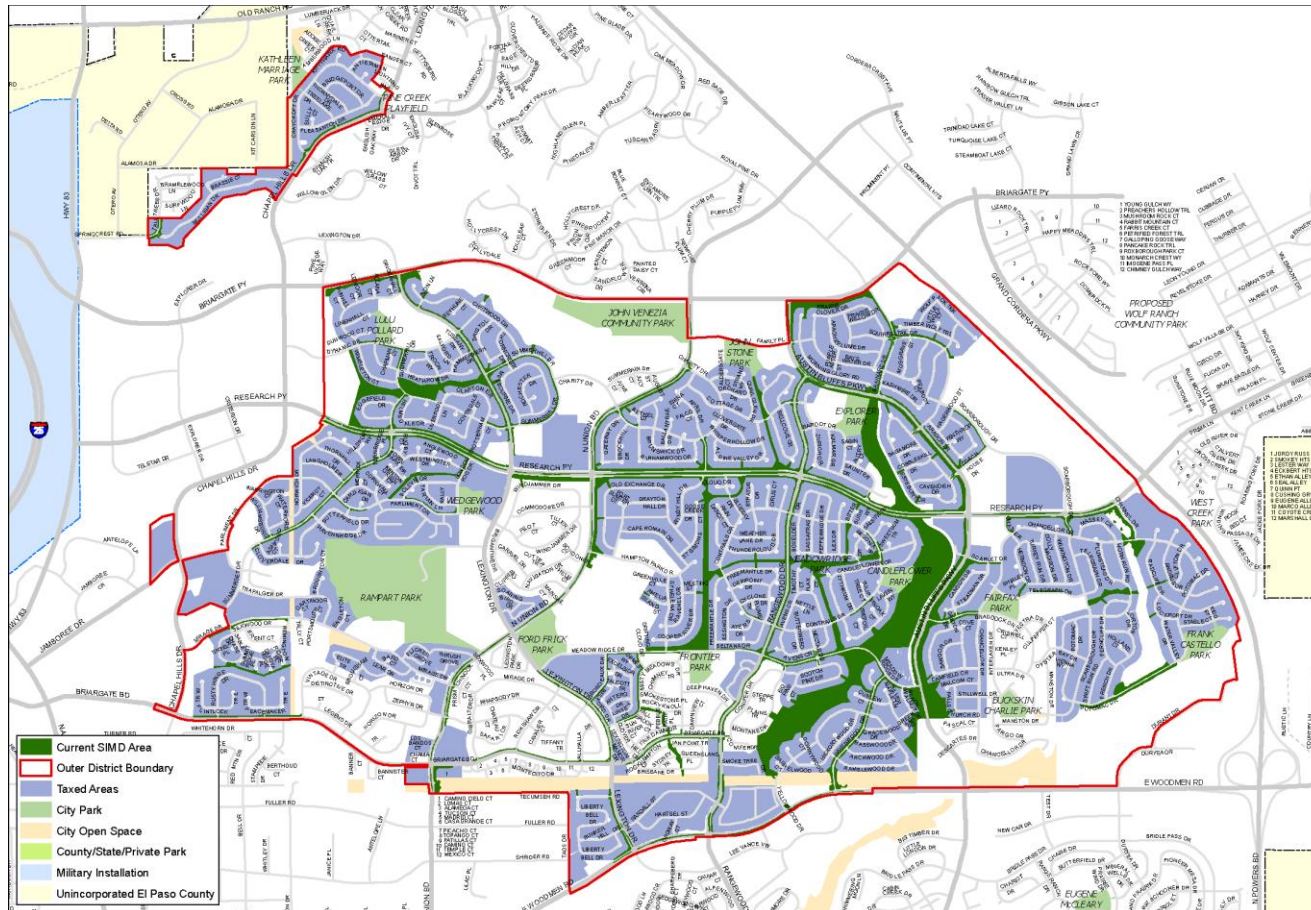

Department of
Information Technology
GIS Services Division

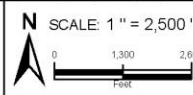

BRIARGATE SPECIAL IMPROVEMENT MAINTENANCE DISTRICT

MAP VERSION: 09-02-2009	State Plane Coordinates Colorado Central Zone	NAD83 - US Survey Feet Vertical Datum - NGVD29
-------------------------	--	---

© 2009 City of Colorado Springs on behalf of the Colorado Springs Utilities. All rights reserved. This work, and/or the data contained herein, may not be reproduced, modified, distributed, republished, used to prepare derivative products, publicly displayed or commercially exploited in any manner without the prior express written consent of the City of Colorado Springs and Colorado Springs Utilities. This work was prepared using the best data available at the time of plot file creation date and is intended for internal use only. Neither the City of Colorado Springs, the Colorado Springs Utilities, nor any of their employees makes any warranty, express or implied, or assumes any legal liability or responsibility for accuracy, completeness, or usefulness of any data contained herein. The City of Colorado Springs, Colorado Springs Utilities and their employees shall not be liable for any errors or omissions in the data contained herein.

NOR'WOOD SIMD

- Created by Ordinance in 1981
- 2014 Revenues: \$679,437
- Assessment: 3.935 mills
- Maintenance responsibilities:
 - Medians, rights of way and open spaces
 - Turf, trees, shrubs, landscape beds and native vegetation
 - Trails, walks, fencing, landscape lighting, signage and other amenities
 - 2015 Projects: turf conversions, fence improvements

NOR'WOOD SIMD

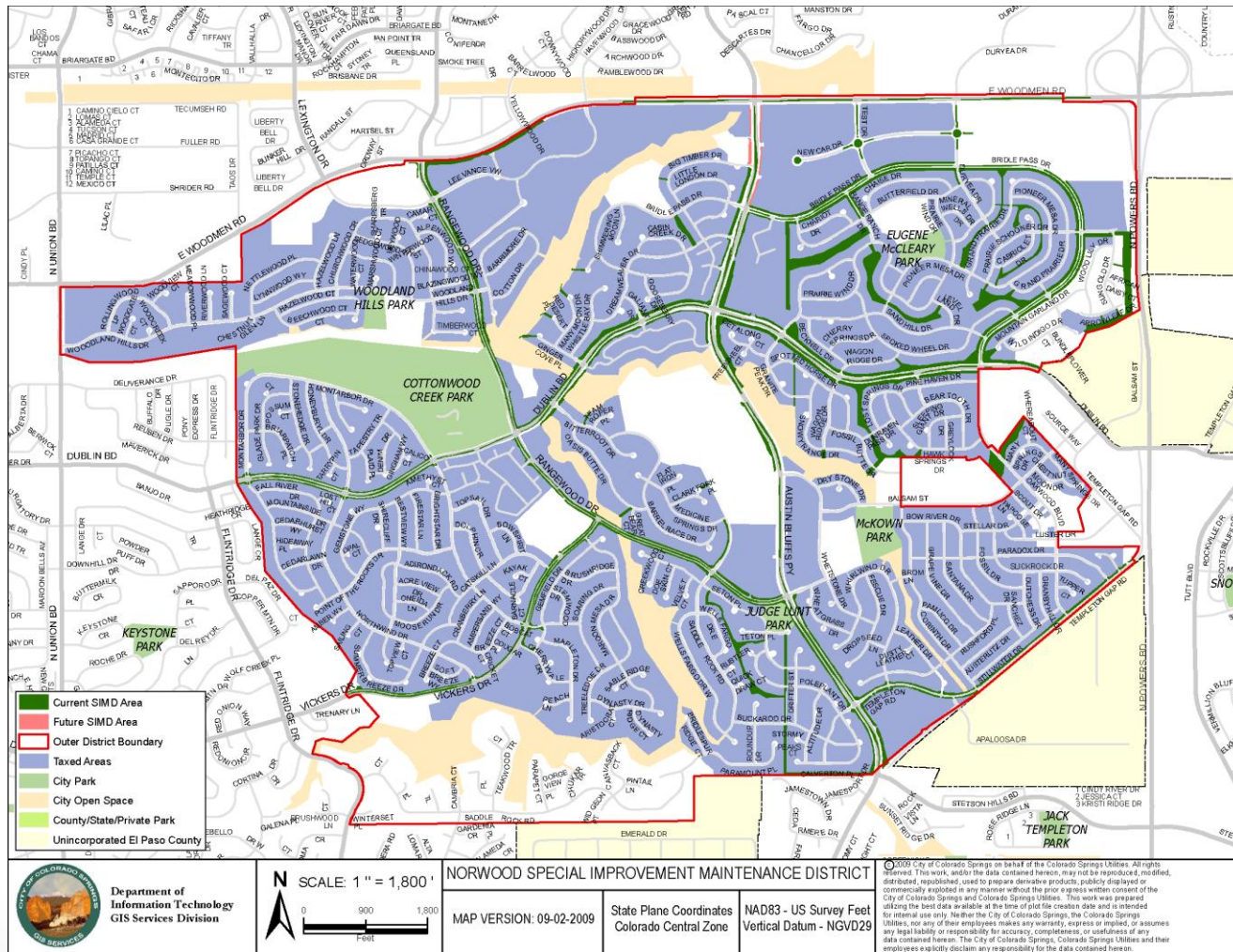

STETSON HILLS SIMD

- Created by Ordinance in 1986
- 2014 Revenues: \$285,849
- Assessment: 3.858 mills
- Maintenance responsibilities:
 - Medians, rights of way and open spaces
 - Turf, trees, shrubs, landscape beds and native vegetation
 - Trails, walks, fencing, landscape lighting and signage
 - 2015 Projects: turf improvements, fence replacements

STETSON HILLS SIMD

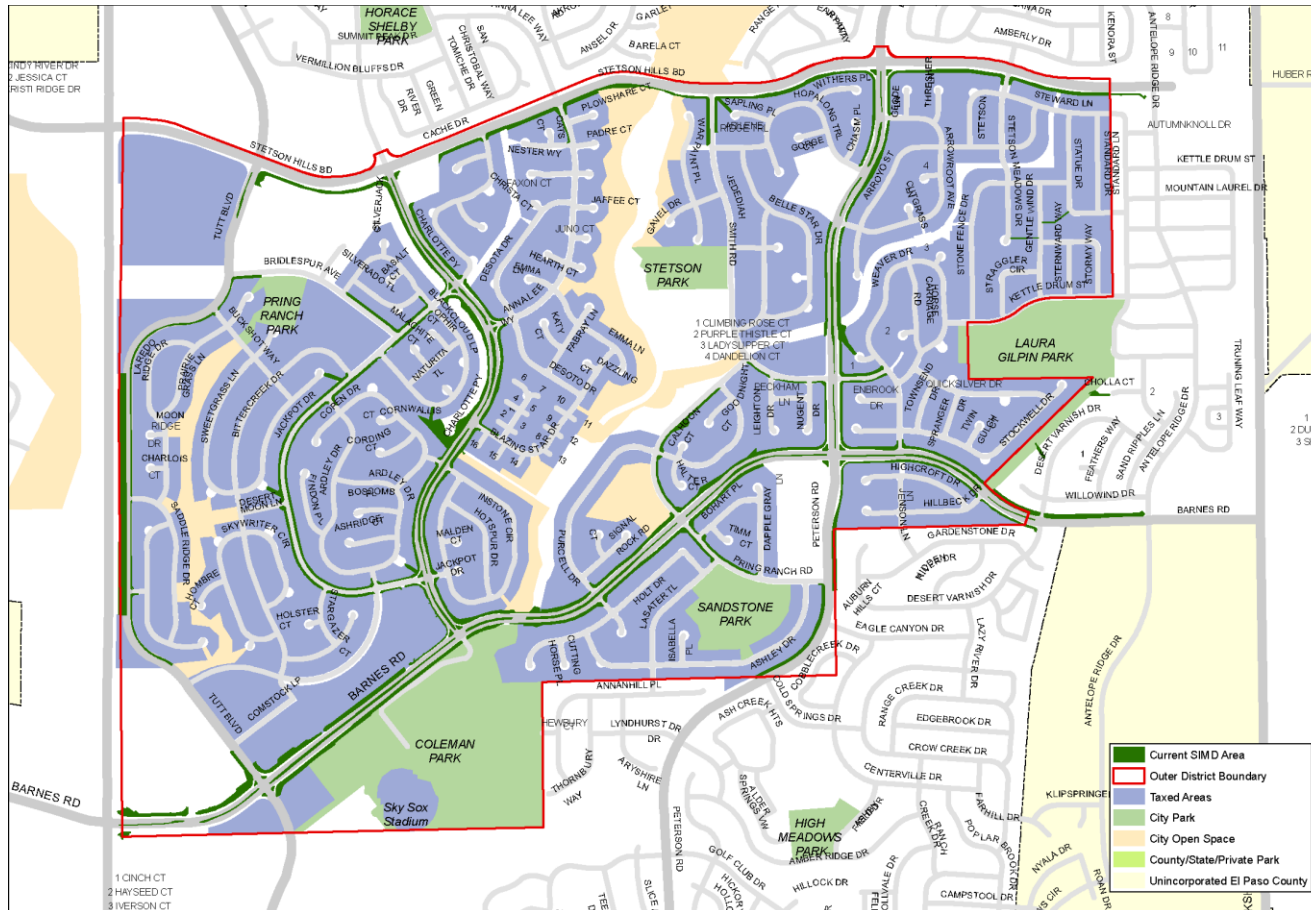

Department of Information Technology
GIS Services Division

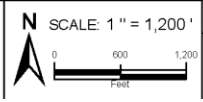

STETSON HILLS SPECIAL IMPROVEMENT MAINT. DISTRICT

MAP VERSION: 09-02-2009
State Plane Coordinates Colorado Central Zone
NAD83 - US Survey Feet
Vertical Datum - NGVD29

© 2009 City of Colorado Springs on behalf of the Colorado Springs Utilities. All rights reserved. This work, and/or the data contained herein, may not be reproduced, modified, distributed, republished, used to prepare derivative products, publicly displayed or commercially exploited in any manner without the prior express written consent of the City of Colorado Springs and Colorado Springs Utilities. This work was prepared utilizing the best data available at the time of plot for the creator's data and is intended for internal use only. Neither the City of Colorado Springs, the Colorado Springs Utilities, nor any of their employees makes any warranty, express or implied, or assumes any legal liability or responsibility for accuracy, completeness, or usefulness of any data contained hereon. The City of Colorado Springs, Colorado Springs Utilities and their employees expressly disclaim any responsibility for the data contained hereon.

OLD COLORADO CITY SECURITY AND MAINTENANCE DISTRICT

- Created by Ordinance in 1979
- 2014 Revenues: \$103,546
- Assessment 13.416: mills
- Maintenance responsibilities:
 - Historic District streetscape and rights of way
 - Turf, trees, shrubs, landscape beds and planters
 - Sidewalks, parking lots, fencing, benches, landscape lighting, signage and other amenities
 - 2015 Projects: parking lot and walkway improvements

OLD COLORADO CITY

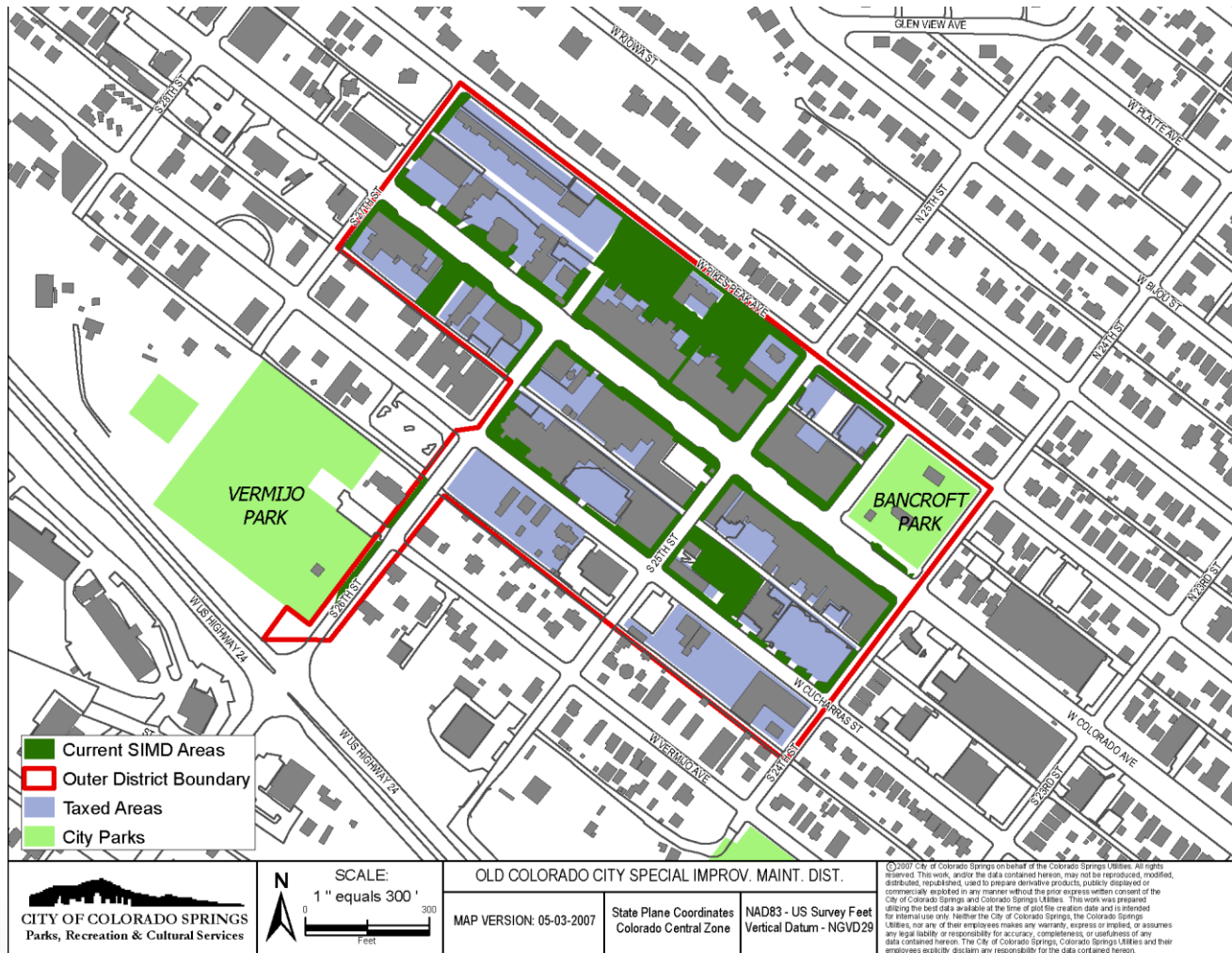

WOODSTONE SIMD

- Created by Ordinance in 1986
- 2014 Revenues: \$18,837
- Assessment: 3.615 mills
- Maintenance responsibilities:
 - Turf, trees, shrubs, and landscape beds
 - Walkway, footbridge, fencing, landscape lighting, and signage
 - 2015 Projects: fence replacements

WOODSTONE SIMD

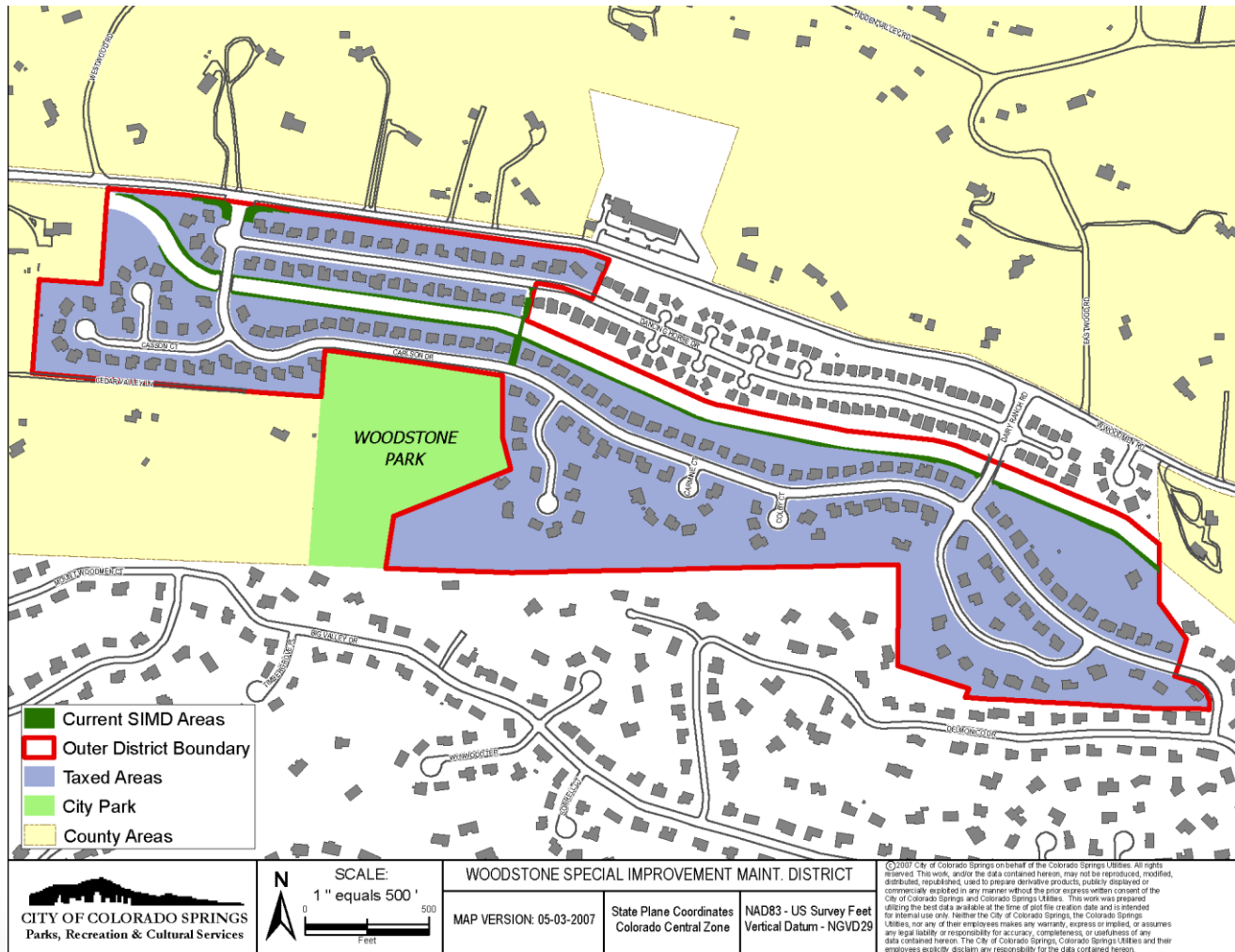

PLATTE AVENUE SIMD

- Created by Ordinance in 1989
- 2014 Revenues: \$9,205
- Assessment: \$1.10 per lineal foot of frontage
- Maintenance responsibilities:
 - Medians and rights of way
 - Street trees and median landscape
 - Sidewalks and decorative walls
 - 2015 Projects: Median landscape renovations, sidewalk repairs

PLATTE AVE SIMD

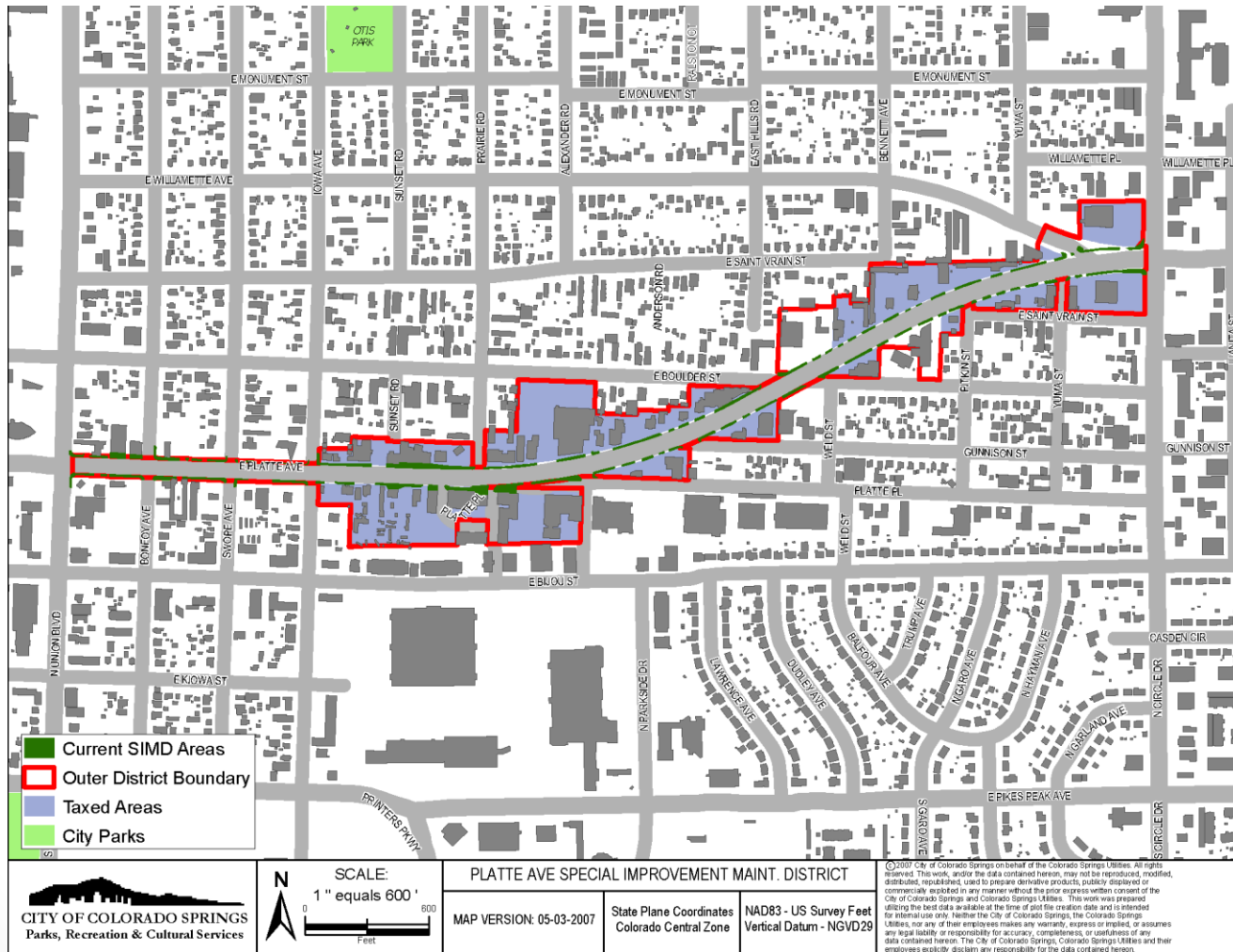

COLORADO AVENUE GATEWAY SIMD

- Created by Ordinance in 1988
- 2014 Revenues: \$3,011
- Assessment: 1.009 mills
- Maintenance responsibilities:
 - Streetscape trees, shrubs and landscape beds
 - Sidewalks and decorative lighting
 - 2015 Projects: walkway lighting upgrades

COLORADO AVE GATEWAY SIMD

