

ZONE CHANGE MAP – EXHIBIT B
LOT 2, BLOCK 1, THE HOMESTEAD SUBDIVISION FILING NO. 10
LOT 1, COLORADO COUNTRY FILING NO. 12
LOCATED IN THE NORTHEAST QUARTER OF SECTION 25,
TOWNSHIP 13 SOUTH, RANGE 66 WEST OF THE SIXTH PRINCIPAL MERIDIAN,
CITY OF COLORADO SPRINGS, COUNTY OF EL PASO, STATE OF COLORADO

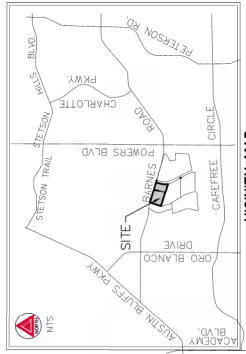

- CONDITIONS OF RECORD**
1. ALL PERMITTED USES WITHIN THE PBC DISTRICT SHALL BE PERMITTED.
 2. ALL PERMITTED USES WITHIN THE PBC DISTRICT SHALL REMAIN CONDITIONAL.
 3. ALL USES THAT ARE PROHIBITED WITHIN THE PBC DISTRICT SHALL REMAIN PROHIBITED.
- PBC (PLANNED BUSINESS CENTER) ZONE DISTRICT IS DEFINED AS: A ZONE DISTRICT THAT ACCOMMODATES COMMERCIAL LAND USES AND PRESERVES THE CHARACTER OF AN AREA FOR A RANGE OF RETAIL SALES AND SERVICE ESTABLISHMENTS.

PARKING SPACES: FILING A
 REC. NO. 03/08/07

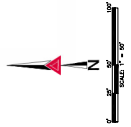

ZONE CHANGE MAP
NE 1/4 SEC. 25, T13S, R66W, 6TH P.M.
COLORADO SPRINGS, COLORADO
 PREPARED FOR
REDLAND
 1800 W CANAL COURT, LITTLETON, CO 80120

DATE: 05/25/07
 SHEET: 1 OF 1
 COUNTY: EL PASO
 CITY FILE NUMBER: 05C-20-20-00116

2020-07-08
 DATE
 11:58
 TIME

DATE	BY	APP/REV

AZTEC CONSULTANTS, INC.
 300 East Mineral Ave., Suite 1
 Littleton, Colorado 80122
 Phone: (303) 713-8988
 Fax: (303) 713-8987
 www.aztecconsultants.com