

**SURVEYOR AFFIDAVIT**  
BLACK CANYON QUARRY ADDITION NO. 1 ANNEXATION

STATE OF COLORADO     )  
  ) ss.  
COUNTY OF EL PASO     )

Robert L. Meadows Jr., the affiant, first being duly sworn, deposes and says as follows:

1. He is a registered professional land surveyor in the State of Colorado, Registration No. PLS 34977
2. He is employed by Matrix Design Group in Colorado Springs, Colorado.
3. The annexation plat of Black Canyon Quarry Addition No. 1 was prepared under his supervision.
4. He has examined this annexation plat and the legal description therein.
5. The legal description set forth on the plat accurately describes the property that is subject to annexation to the City of Colorado Springs.
6. The annexation plat accurately sets forth the boundary of the property that is subject to annexation to the City of Colorado Springs.
7. As shown on the plat, at least one-sixth (1/6th) of the boundary of the property to be annexed is contiguous with the boundary of the city limits of the City of Colorado Springs.
8. In establishing the boundaries of the area proposed to be annexed, if a portion of a platted street or alley is annexed, the entire width of said street or alley is included within the area proposed to be annexed.

FURTHER AFFIANT SAYETH NOT.

  
\_\_\_\_\_  
Robert L. Meadows Jr., PLS 34977  
Director of Surveying Services  
Matrix Design Group  
2435 Research Parkway, Suite 300  
Colorado Springs, Colorado 80920

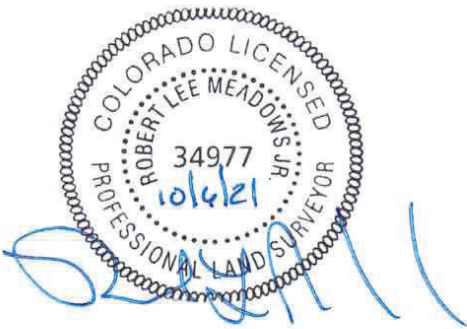

SUBSCRIBED AND SWORN TO before me this 6th day of October 2021  
Witness my hand and official seal.

  
\_\_\_\_\_  
NOTARY PUBLIC

My Commission expires: 9.8.2024

