

NORTHGATE Master Plan

LEGEND

Land Use	Proposed Acres
O/I	355
CC	46
NC	13
SFDL	308
SFD	284
SFA	0
MF	107
OS/NP	79
ES	10
RC	192

R.O.W. Major Roads
 POWERS BLVD.
 Water Tank

Total Acreage
 1508

- MULTI-USE TRAIL
- BIKE PATH
- FIRE STATION (General Vicinity)
- WASTEWATER PUMP STATION
- ELECTRIC SUBSTATION
- MINOR ARTERIAL
- MAJOR ARTERIAL
- EXPRESSWAY
- INTERSTATE

PROPERTY OWNED BY OTHERS

VEHICULAR ACCESS
 (Access to be shown on the site plan. No existing easements.)

CPC MPA 05-00278-A4MN17

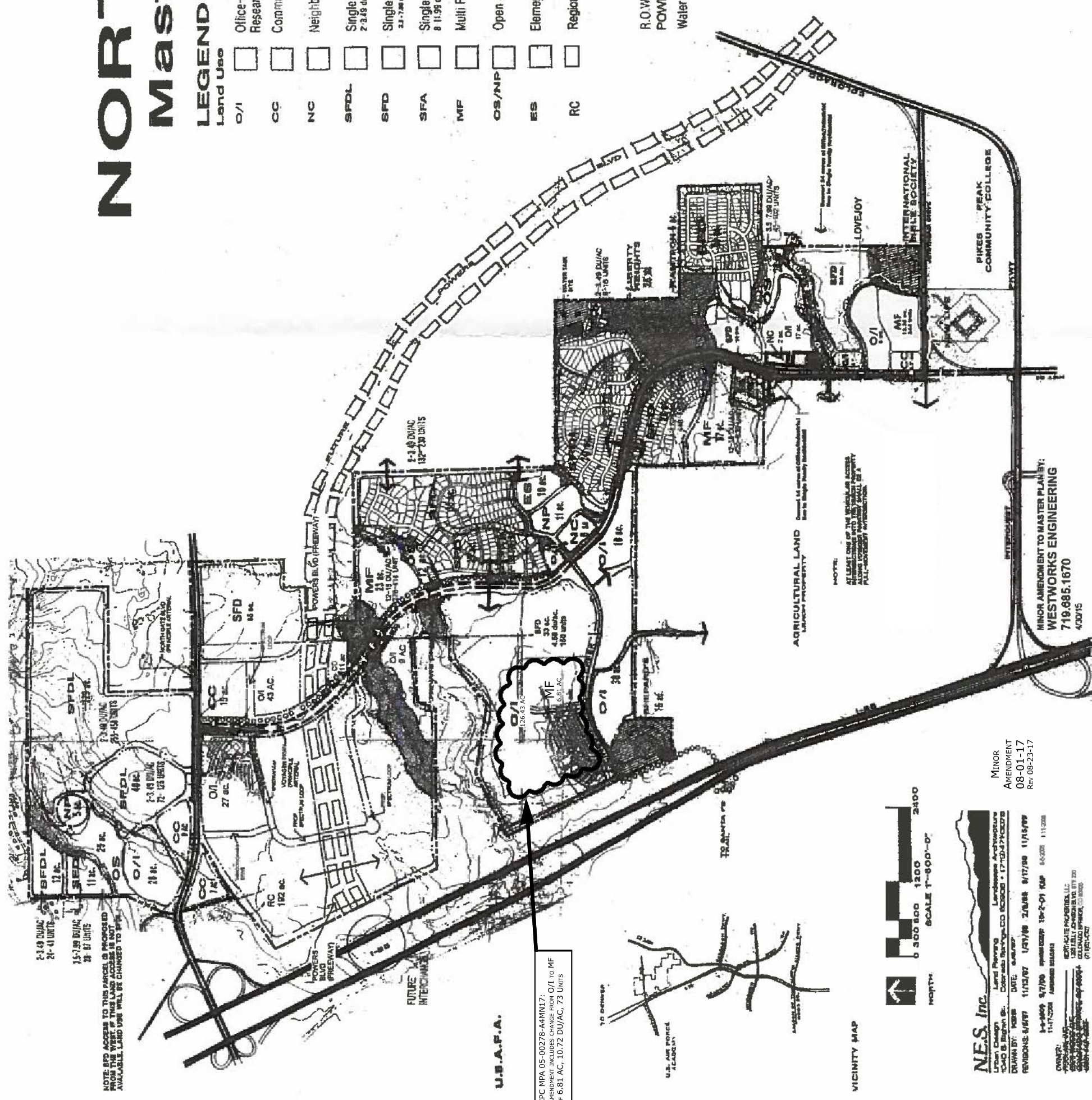

NOTE: R.O.W. ACCESS TO THIS PARCEL IS PROVIDED FROM THE WEST. IF THIS LAND ACCESS IS NOT AVAILABLE, LAND USE WILL BE CHANGED TO SFDL.

CPC MPA 05-00278-A4MN17:
 AMENDMENT INCLUDES CHANGE FROM O/I TO MF
 OF 6.81 AC, 10.72 DU/AC, 73 UNITS

U.S.A.F.A.

VICINITY MAP



MINOR
 AMENDMENT
 08-01-17
 REV 08-23-17

N.E.S. Inc.
 Land Planning
 Landmarks Architecture
 1040 S. High St. Colorado Springs, CO 80905 • (719) 441-7000
 DRAWN BY: KSB DATE: 8/17/09
 REVISIONS: 8/17/09 11/12/07 1/21/08 2/20/08 8/17/09 11/15/09
 1-800-909-5700
 11-17-2008
 1501 S. W. 10th St. Suite 200
 Fort Lauderdale, FL 33304
 (954) 441-1222

MINOR AMENDMENT TO MASTER PLAN BY:
 WESTWORKS ENGINEERING
 719.885.1670
 4/20/15

FIGURE 4