



Date	Description	Initials
7/13	Change in ownership parcel TE200	JFL
6/14	Change in ownership parcel RW202	JFL
6/14	Revisions on parcels: PE205, TE205, TE210, PE212, TE212	JFL
6/14	Address: BE510	JFL
6/14	Change in ownership parcel TE191	JFL

Date	Description	Initials
9-8-2014	8.01-8.03	
9-8-2014	8.01-8.03	
9-8-2014	8.01-8.03	

Right of Way Plans
 OWNERSHIP MAP
 Project Number: STU M240-046 UNIT II
 Project Number: STU M240-148
 Project Location: WOODMEN ROAD, STINSON TO POWERS
 Project Code: East Med. Dens. Subst. Streets Sheet No. Total No. of Sheets
 2717 & 19450 9-8-2014 8.01-8.03 8.01 56

MATTHEW A. ANNA L.
 7043 GAIL PL.
 COLORADO SPRINGS CO 80920
 CRW202

HERBERT FEBERLING
 7044 GAIL PL.
 COLORADO SPRINGS CO 80920
 CW202 (E235-REVD)

Flagship
 Land Surveying
 91 E. 2417th Ave. #1078 206
 COLORADO SPRINGS, CO 80903
 PLS. 719.208.4917

WILLIAM A. HADL
 7043 GAIL PL.
 COLORADO SPRINGS CO 80920
 CRW202 (E235-REVD)

HERBERT FEBERLING
 7044 GAIL PL.
 COLORADO SPRINGS CO 80920
 CW202 (E235-REVD)

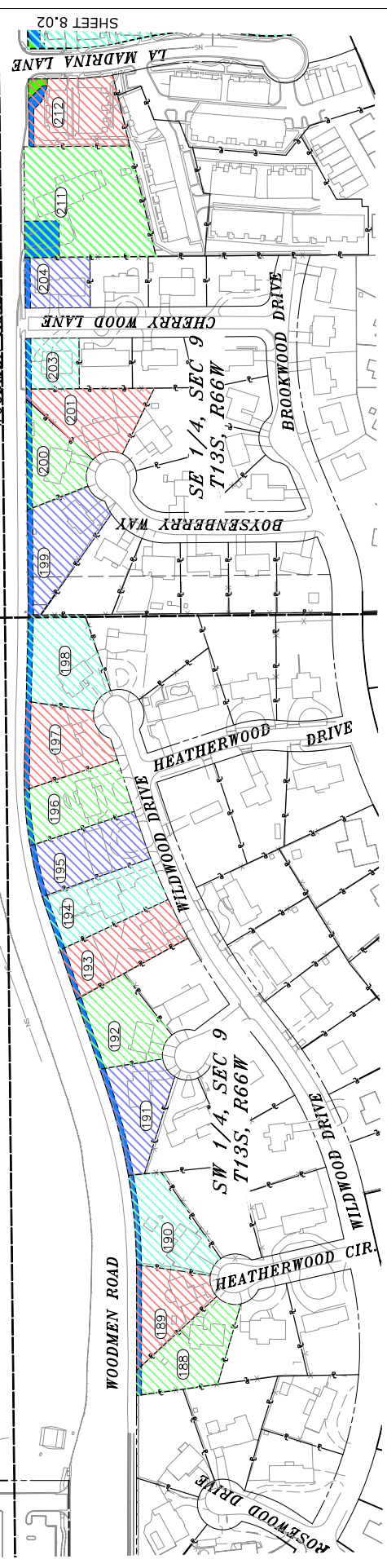
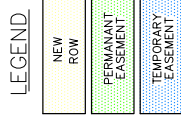
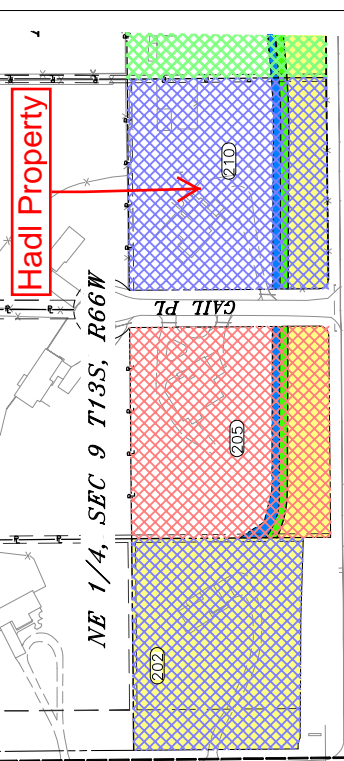
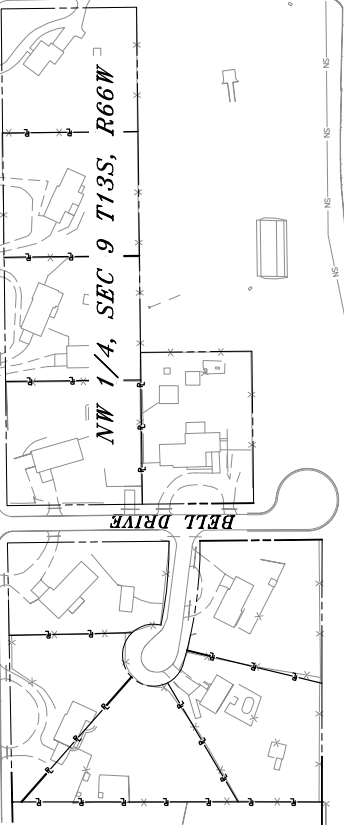

DAVID W. & BITA A. HORNE
 6920 HEATHERWOOD CIR
 COLORADO SPRINGS CO 80918
 CE138

HANSEN FAMILY 2011 REVOC TRUST
 6925 HEATHERWOOD CIR
 COLORADO SPRINGS CO 80918
 CE138

GLENN R. & MARTHA R. EASTRIDGE
 6921 HEATHERWOOD CIR
 COLORADO SPRINGS CO 80918
 CE130D

SECRETARY OF HOUSING AND
 DEVELOPMENT
 5533 WHISKEY RIVER DR
 COLORADO SPRINGS CO 80923
 CE133D

MANUEL C. & DEBRA J. GONZALES
 6933 CEDARWOOD CIR
 COLORADO SPRINGS CO 80918
 CE132

WILLIAM T. & DONNA S. ANGELOS
 2090 WILDWOOD DR
 COLORADO SPRINGS CO 80918-1155
 CE139D

BETTY J. SCHULTZ
 2102 WILDWOOD DR
 COLORADO SPRINGS CO 80918
 CE134

GENEVIEVE E. SPARKS
 2118 WILDWOOD DR
 COLORADO SPRINGS CO 80918
 CE135

MARK E. & THERESA A. MOSS
 2134 WILDWOOD DR
 COLORADO SPRINGS CO 80918
 CE136

MICHAEL ONEILL
 2156 WILDWOOD DR
 COLORADO SPRINGS CO 80918
 CE137

GREGORY J. & DEBRA S. FARKAS
 2168 WILDWOOD DR
 COLORADO SPRINGS CO 80918
 CE138

GEORGE T. & ANN V. DEVERE
 6924 BOYSENBERRY WAY
 COLORADO SPRINGS CO 80918
 CE139

CHARLES DAVID HINKLE & KENNYE L. HINKLE
 6928 BOYSENBERRY WAY
 COLORADO SPRINGS CO 80918
 CE200

KRISTEN DICKINSON
 6927 BOYSENBERRY WAY
 COLORADO SPRINGS CO 80918
 CE201

MANUEL M. HERNANDEZ
 11475 HUNGATE RD
 COLORADO SPRINGS CO 80908
 CE202D

HELP FUND
 PO BOX 26175
 COLORADO SPRINGS CO 80936
 CE203

TOM JR & SYLVIA M. PINELLO
 2367 E WOODMEN RD
 COLORADO SPRINGS CO 80920
 CE211

COTTONWOOD CREEK TOWNHOUSE ASSOC
 2618 HATCH CIR
 COLORADO SPRINGS CO 80918
 CE212-REVD (E212-REVD)

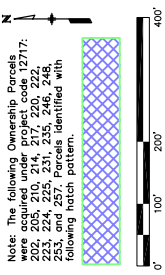

Note: The following Ownership Parcels were acquired under project code 12717: 202, 204, 205, 206, 207, 208, 209, 210, 211, 212, 213, 214, 215, 216, 217, 218, 219, 220, 221, 222, 223, 224, 225, and 227. Parcels identified with following hatch pattern.

SHEET 8.02